

# DRESS BARN PLAZA

132 FEDERAL ROAD | DANBURY, CT 06811

AVAILABLE 8,000 SF

ANCHORED BY



## PROPERTY INFORMATION

- GLA 11,670 sf
- Close proximity to I-84
- Across the street from Stew Leonard's & Walgreens
- Traffic light entrance
- Co-tenants - Starbucks
- Divisible Space

## SPACE DETAILS

Available 8,000sf

## AREA DEMOGRAPHICS

2019 DEMOGRAPHICS	3 MILE	5 MILE	7 MILE
POPULATION	50,941	118,965	153,504
MEDIAN HH INC	\$85,056	\$87,078	\$92,707
AVERAGE HH INC	\$100,366	\$105,592	\$114,612



**CHARTER**  
REALTY & DEVELOPMENT

[www.chartweb.com](http://www.chartweb.com)



FOR MORE INFORMATION CONTACT:

DAN ZELSON | 203.227.2922 | [dan@chartweb.com](mailto:dan@chartweb.com)

# DRESS BARN PLAZA

132 FEDERAL ROAD | DANBURY, CT 06811

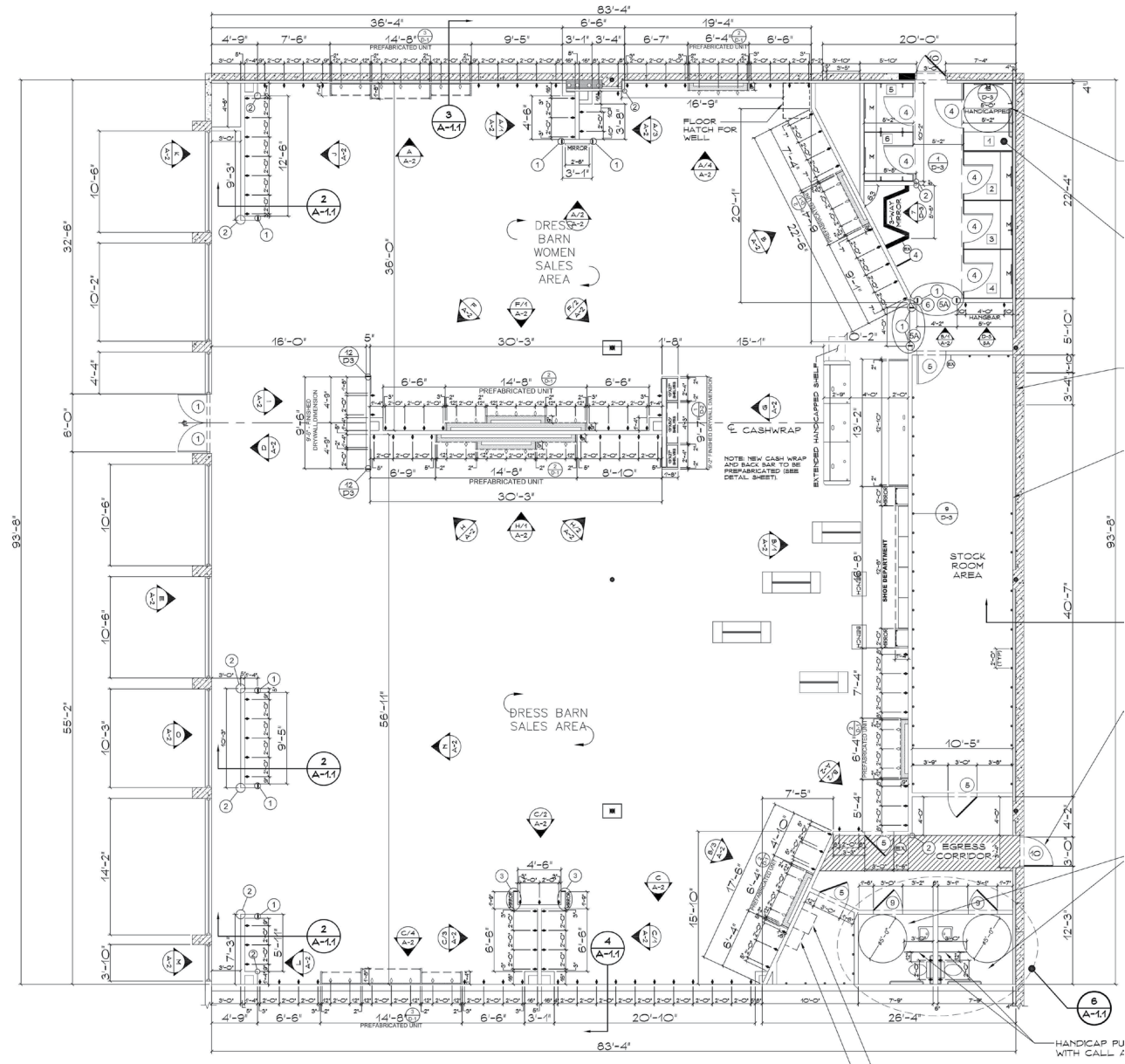



# DRESS BARN PLAZA

132 FEDERAL ROAD | DANBURY, CT 06811

## TENANTS / AVAILABILITY

#	TENANT	Sq. Ft.
01	Available	8,000
02	Starbucks	1,720
03	Mobile Rescue of Danbury	1,939

GLA 11,670sf

- Available
- Lease Out
- Occupied





# DRESS BARN PLAZA

132 FEDERAL ROAD | DANBURY, CT 06811

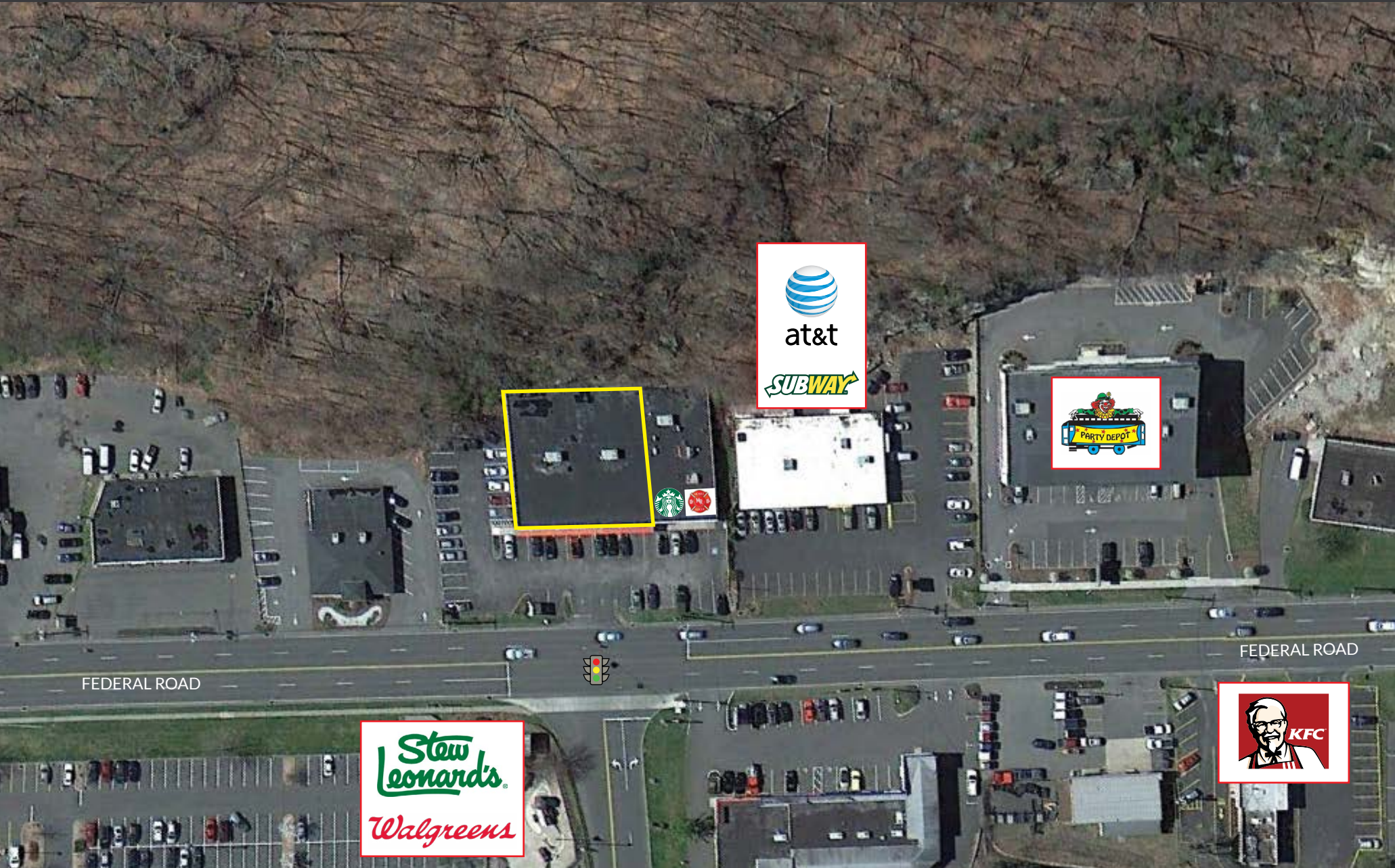



# DRESS BARN PLAZA

132 FEDERAL ROAD | DANBURY, CT 06811

