

LAND FOR SALE OR LEASE AT NORTHEAST CORNER OF SR-23 & ORANGE ROAD

3 Parcels Available (+/- 1.502 acres, +/-3.72 acres and +/- 11.80 acres)

Orange Point Park | US-23 and Orange Point Drive | Columbus, Ohio



PROPERTY HIGHLIGHTS

Two parcels (+/- 1.502 acres and +/- 3.72 acres) available north of Orangepoint Drive;

One parcel (+/- 11.8 acres) available south of Orangepoint Drive

Signalized full movement access directly onto US-23

Significant frontage on US-23

Situated in close proximity to Walmart, Kohl's, Meijer, Kroger Marketplace, Home Depot, Menards and the new Nationwide Children's/OhioHealth, Ohio State and Mount Carmel regional medical campuses

Located in high-growth, high income area

Average Daily Traffic Counts:
 US-23- 40,626 Orange Road - 9,950
 SR-750/Polaris Parkway - 31,990

DEMOGRAPHICS

5-MILE
RADIUS

POPULATION (Estimated)	122,154
POPULATION (5 years)	132,771
HOUSEHOLDS	45,524
AVG. HOUSEHOLD INCOME	\$136,553
HOUSEHOLDS EARNING MORE THAN \$75K	67.2%
MEDIAN AGE	37
DAYTIME POPULATION	90,572
BUSINESSES	5,326
EXPENDITURE - RETAIL (Total)	\$1.89 B
Per Household per Month	\$3,461

OrangePointPark-land



Inspired ideas.
Integrated real estate solutions.

250 Civic Center Drive, Suite 500
 Columbus, OH 43215 | www.castoinfo.com

FOR MORE INFORMATION

Kelly Casto
 614.744.3286 PHONE
 614.744.3646 FAX
KCasto@castoinfo.com

LAND FOR SALE OR LEASE AT NORTHEAST CORNER OF SR-23 & ORANGE ROAD

3 Parcels Available (+/- 1.502 acres, +/-3.72 acres and +/- 11.80 acres)

Orange Point Park | US-23 and Orangepoint Drive | Columbus, Ohio

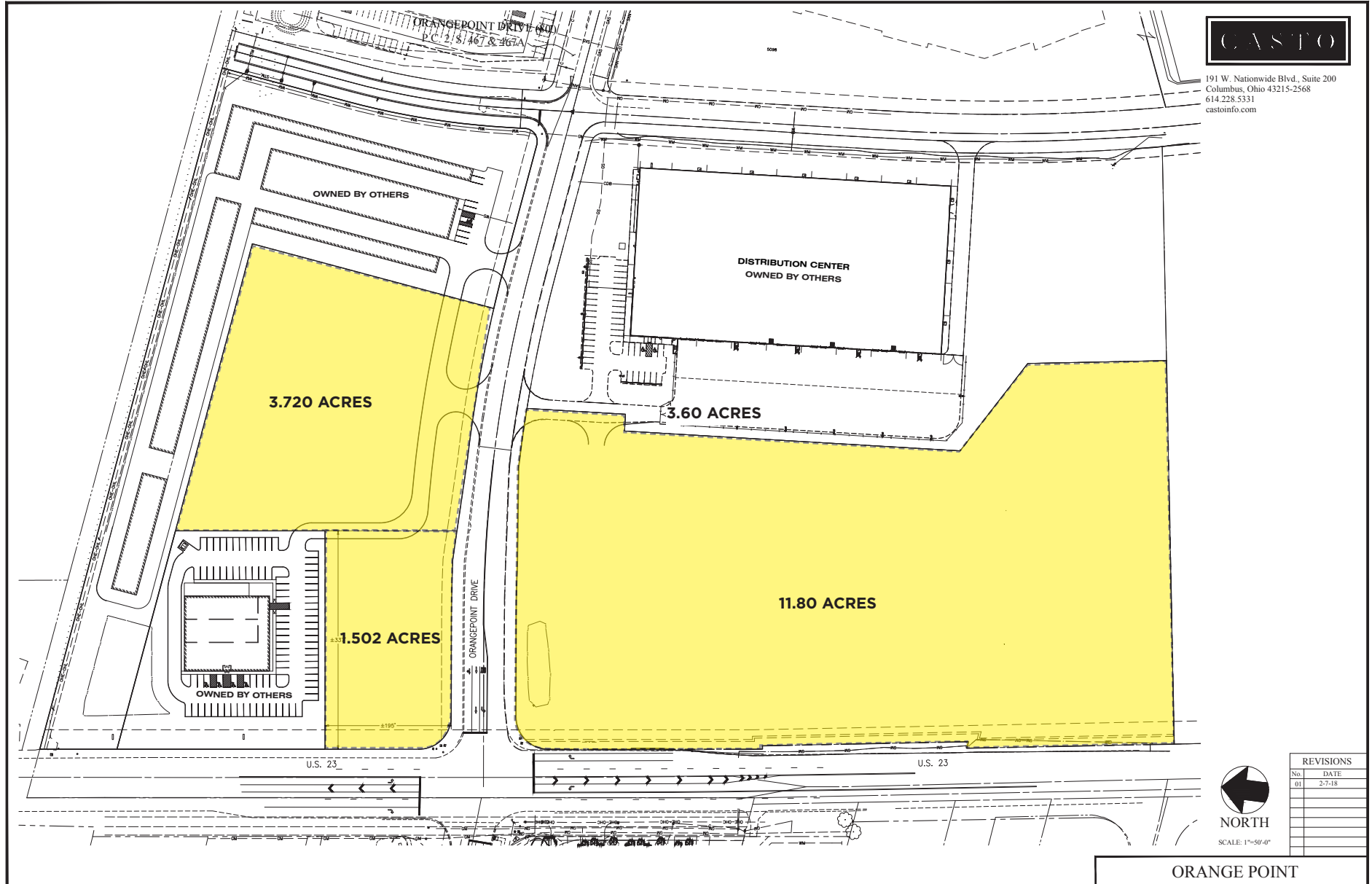

191 W. Nationwide Blvd., Suite 200
Columbus, Ohio 43215-2568
614.228.5331
castoinfo.com



250 Civic Center Drive, Suite 500 | Columbus, Ohio 43215 | www.castoinfo.com

LAND FOR SALE OR LEASE AT NORTHEAST CORNER OF SR-23 & ORANGE ROAD

3 Parcels Available (+/- 1.502 acres, +/- 3.72 acres and +/- 11.80 acres)

Orange Point Park | US-23 and Orangepoint Drive | Columbus, Ohio



copp-aerial-1



250 Civic Center Drive, Suite 500 | Columbus, Ohio 43215 | www.castoinfo.com