

The Lipstick Building
is getting a makeover

3,000-14,000 RSF High-End Executive Pre-Builts



- New Lobby With Coffee Bar
- New Elevator Cabs and Mechanical Systems
- New Town Hall Conference Space
- New Fitness Studio & Bike Room
- New Bathrooms & Common Corridors



TOWER FLOOR 13,884 RSF Pre-Built

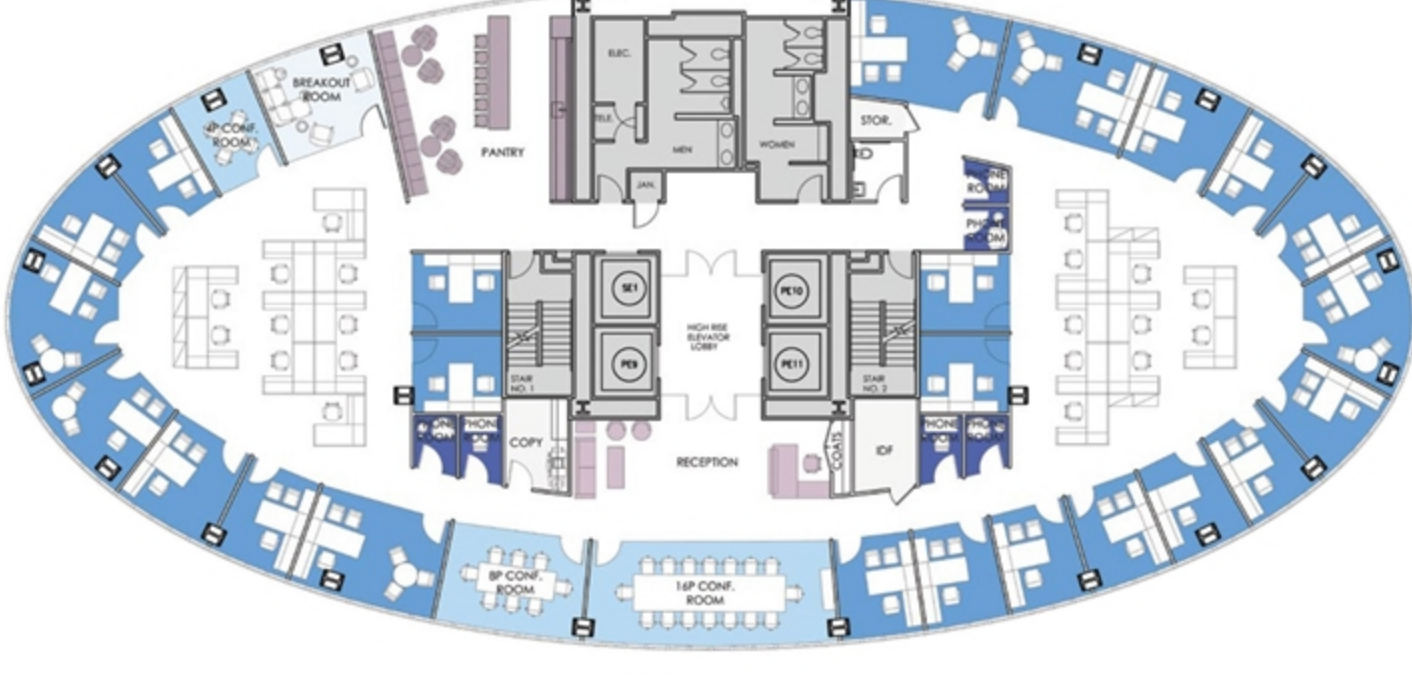

[CLICK FOR FLOOR PLANS, PHOTOS, & MORE DETAILS](#)

NEW TOWN HALL CONFERENCE CENTER & FITNESS AMENITIES



[CLICK FOR ALL AMENITIES](#)

SL Green is taking extra precautions to provide healthy environments, ensuring maximum safety, cleanliness and wellness programs for all tenants.

[CLICK HERE FOR MORE INFORMATION](#)

NEWMARK

Brian Waterman, Executive Vice Chairman & Principal
t 212-372-2299
brian.waterman@nrmk.com

Scott Klau, Vice Chairman
t 212-372-2244
scott.klau@nrmk.com

Erik Harris, Executive Managing Director
t 212-372-2105
erik.harris@nrmk.com

Zachary Weil, Managing Director
t 646-441-3744
zachary.weil@nrmk.com

Cole Gendels, Associate
t 212-850-5443
cole.gendels@nrmk.com

SL GREEN REALTY CORP. SLG LISTED NYSE

Larry Swiger, Senior Vice President
t 212-216-1628
larry.swiger@slgreen.com

Jeremy Bier, Vice President
t 212-216-1722
jeremy.bier@slgreen.com

Jackie Hagopian, Associate
t 212-356-4106
jackie.hagopian@slgreen.com

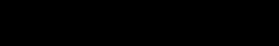

[DOWNLOAD PDF](#)

125 Park Avenue, New York, NY 10017 t 212-372-2000

The information contained herein has been obtained from sources deemed reliable but has not been verified and no guarantee, warranty or representation, either express or implied, is made with respect to such information. Terms of sale or lease and availability are subject to change or withdrawal without notice.

©2022 Newmark. All Rights Reserved.