



1524 Sumner Building

1524 45th Street E
Sumner, Washington 98390

Property Highlights

- 5,430 SF (908 SF office)
- 906 SF of mezzanine storage
- Potential to combine with adjacent space for a total of 14,563 SF (6,190 SF office)
- 2 dock high doors & 1 oversized grade level door
- 24' clear height
- Great access to SR 167
- Available February 1, 2021
- Call for rates

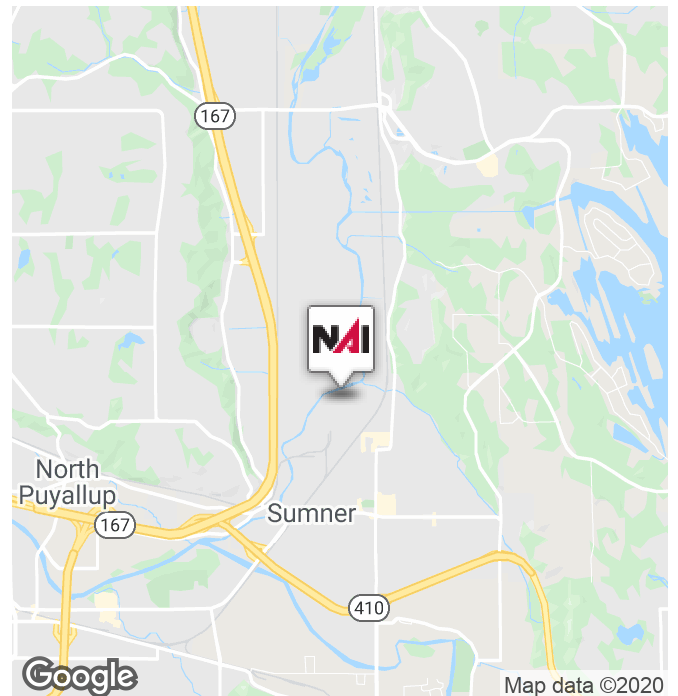

Connor Powell

Associate Vice President | 425.586.5642
cpowell@nai-psp.com

Jeff Forsberg, CCIM

Principal | 425.586.5610
jforsberg@nai-psp.com





FOR LEASE



WAREHOUSE



5,430 SF

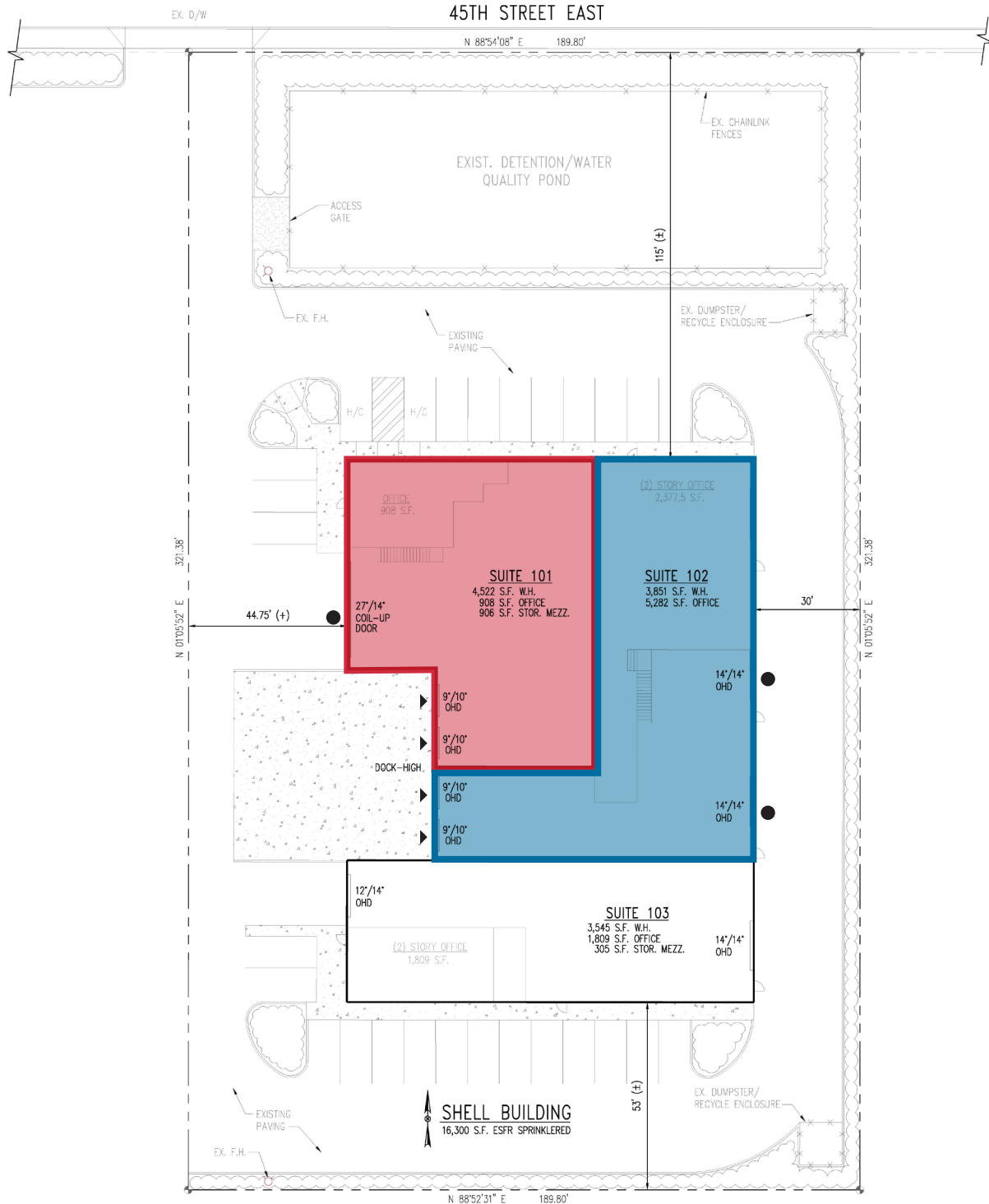

- Available
- Potential Expansion Area
- Grade Level Door
- ▲ Dock High Door

Connor Powell
 Associate Vice President | 425.586.5642
 cpowell@nai-psp.com

Jeff Forsberg, CCIM
 Principal | 425.586.5610
 jforsberg@nai-psp.com

