



SOUTHINGTON CENTER | 235 QUEEN ST.



DEMOGRAPHICS

POPULATION

3 miles: 38,236
5 miles: 105,863
10 miles: 178,242

HOUSEHOLDS

3 miles: 15,968
5 miles: 44,044
10 miles: 73,511

AVG. HOUSEHOLD \$

3 mile: \$108,515
5 miles: \$99,220
10 miles: \$86,175

AVAILABLE 2,335 SF

A high-performing Walmart anchors Southington Center, a retail hub that features a fully signalized entrance on Queen Street (SR 10), a frequently travelled location at the region's main retail corridor.

AREA RETAILERS: Sally Beauty, GameStop, Tap Out Fitness and Santander Bank. Additional tenant categories include wine & spirits, nails, lighting and casual dining.

16,900± ADT

A TRUE EXCLUSIVE... CALL FOR THE DETAILS!

AGENTS:

Adam Zeiberg

203.856.7153 | az@truecre.com

Richard Schneider

203.762.6173 | rs@truecre.com



This information provided in this marketing package has been obtained from sources believed reliable, but has not been verified for accuracy or completeness. You should conduct a careful, independent investigation of the property and verify all information. Any reliance on this information is solely at your own risk.

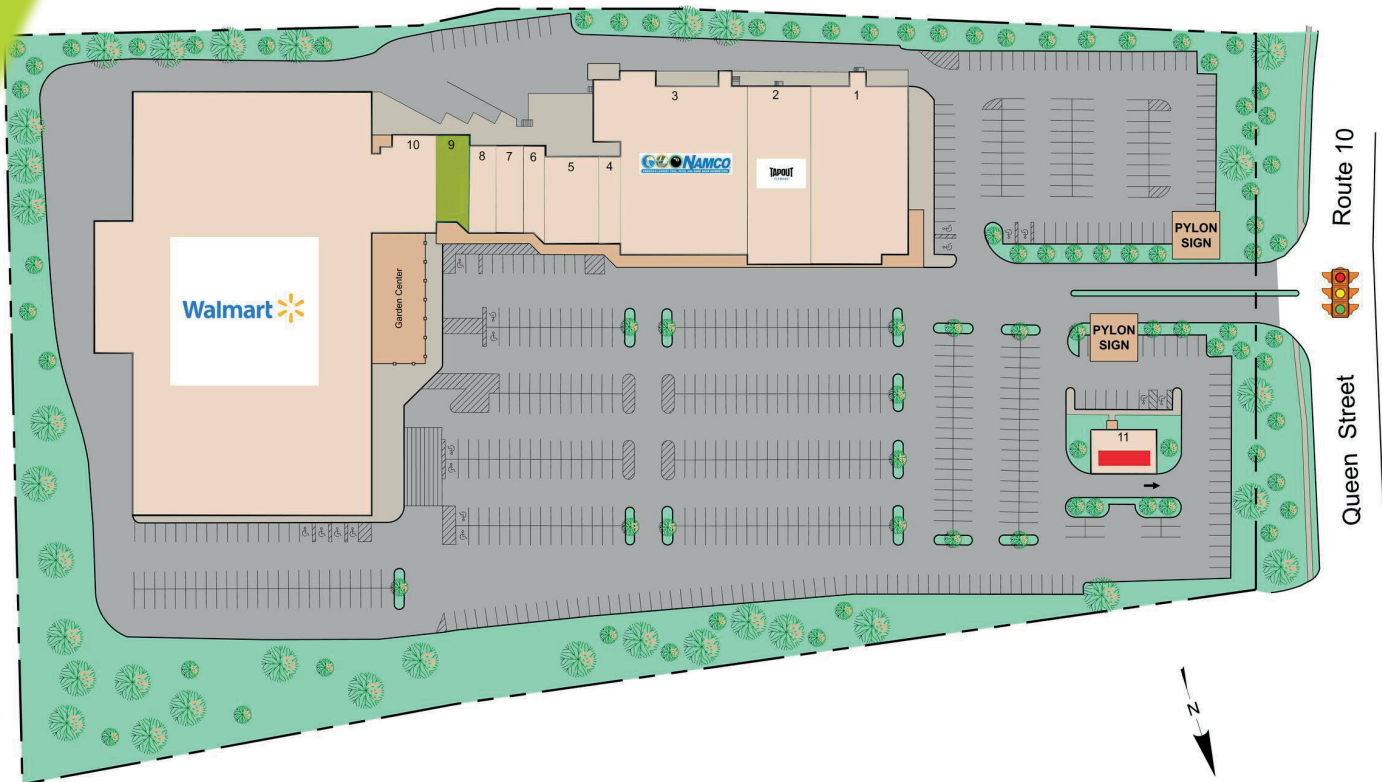

1	Southington Wine & Spirit	14,612 SF
2	Tapout Fitness	10,000 SF
3	NAMCO	20,000 SF
4	Great Clips	1,134 SF
5	Noble Japanese Steakhouse	3,975 SF
6	Sally Beauty Supply	1,637 SF
7	GameStop	1,967 SF
8	Star Nails	2,000 SF
9	Available	2,335 SF
10	Walmart	95,482 SF
11	Santander Bank	2,700 SF



SOUTHINGTON CENTER | 235 QUEEN ST. | AERIAL

QUINNIPIAC RIVER



SOUTHINGTON CENTER



SOUTHINGTON HIGH SCHOOL

