

PLATINUM CENTRE

FORMER FIREPLACES UNLIMITED SPACE

Prime Louise Avenue Retail EndCap!



6801 South Louise Avenue
Sioux Falls, SD 57108



size

2,010 square feet
(north endcap)



price

\$15.00 per foot (NNN)
NNN (est.) = \$5.25



neighbors

Avera Health, Kosama,
Edward Jones, First Class
Dental, Wolfie's Liquor, Dirty
Dog Spa, Holiday Gas Stop,
Security National Bank



t.i.a.

Negotiable.
Contact Broker.



location

Fantastic retail location
on South Louise
Avenue, the #1 retail
corridor in South
Dakota! Site is just
south of Interstate 229



traffic

25,200 cars per day

Information deemed reliable but not guaranteed.



Lake Lorraine | 2571 Westlake Drive #100
Sioux Falls, South Dakota 57106
VBCLink.com | 605.361.8211



605.376.0127
Ryan.Tysdal@VBCLink.com

QDOBA

verizonwireless

57th Street

NOODLES & COMPANY

GET TACO GO JOHN'S

McDonald's

Vern Eide
MOTORCARS
HONDA

Hilton Garden Inn

INTERSTATE
229

TRAIL RIDGE
SENIOR LIVING COMMUNITY

Avera

HOMewood SUITES
BY HILTON

WELLS FARGO

BILLION
AUTOMOTIVE FAMILY

Avera
Behavioral Health

Holiday Inn Express

B&G MILKYWAY

69th Street

kw
KELLERWILLIAMS

Lewis

SUPERSTAR
WASHO

Culver's

Holiday

South Louise Avenue

Avera



BALLERAENA
Dance Studio

HARRISBURG EXPLORER ELEMENTARY

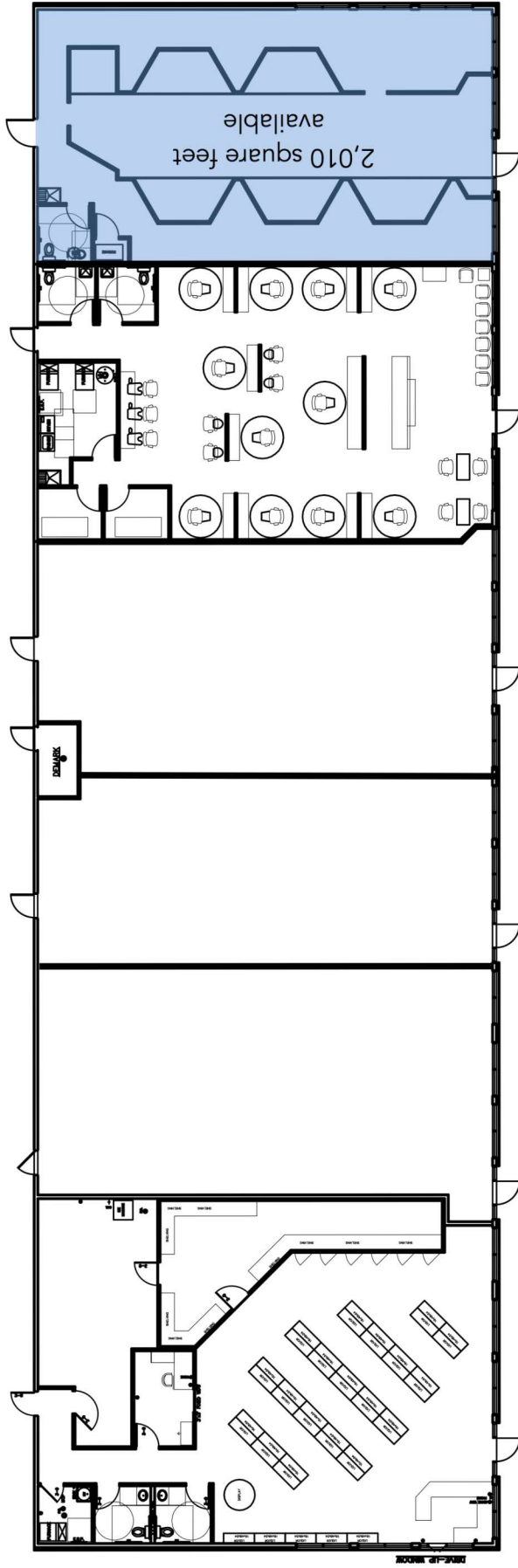

WOLFIE'S
2,707 S.F. RENTABLE
44'-9" x 59'-0"

1800 SQFT AVAILABLE

DIVINE NAILS

DIRTY DOG SPA

HAIR SALON
2,157 S.F. RENTABLE
35'-6" x 59'-0"

AVAILABLE
2,010 S.F. RENTABLE
32'-9" x 59'-0"

PLATINUM CENTRE

- Excellent retail endcap opportunity on Louise Avenue
- 2,010 square feet available for lease
- Building is zoned 'C2-Commercial' which allows for a variety of retail and professional users.
- Shared parking amongst all Platinum Centre buildings.



