

133 NORFOLK STREET

BETWEEN STANTON AND RIVINGTON STREETS



GROUND FLOOR:

APPROXIMATELY 2,200 SF

LOWER LEVEL:

APPROXIMATELY 2,200 SF

FRONTAGE:

APPROXIMATELY 25 FEET

POSSESSION:

NOVEMBER 2017

ASKING RENT:

UPON REQUEST

COMMENTS:

- Fantastic Lower East Side restaurant opportunity — existing vent in place
- HVAC currently existing on the ground floor and lower level
- One block from Essex Crossing, an unprecedented development comprised of 1.9 million square feet of residential, commercial, and community space
- Surrounded by notable destinations such as The Soho House, Essex Market, Katz's Deli, The Hotel on Rivington, The Ludlow Hotel, Russ and Daughters, Schillers, Clinton Street Bakery and Sixty Hotel

EXCLUSIVE AGENT: **ROSS L. KAPLAN** 212.850.5418 RKAPLAN@NGKF.COM

DEREK KOELSCH 212.372.0740 DEREK.KOELSCH@NGKF.COM

**Newmark Grubb
Knight Frank**
Retail

www.ngkf.com/retail



The information contained herein has been obtained from sources deemed reliable but has not been verified and no guarantee, warranty or representation, either express or implied, is made with respect to such information. Terms of sale or lease and availability are subject to change or withdrawal without notice.

133 NORFOLK STREET

BETWEEN STANTON AND RIVINGTON STREETS

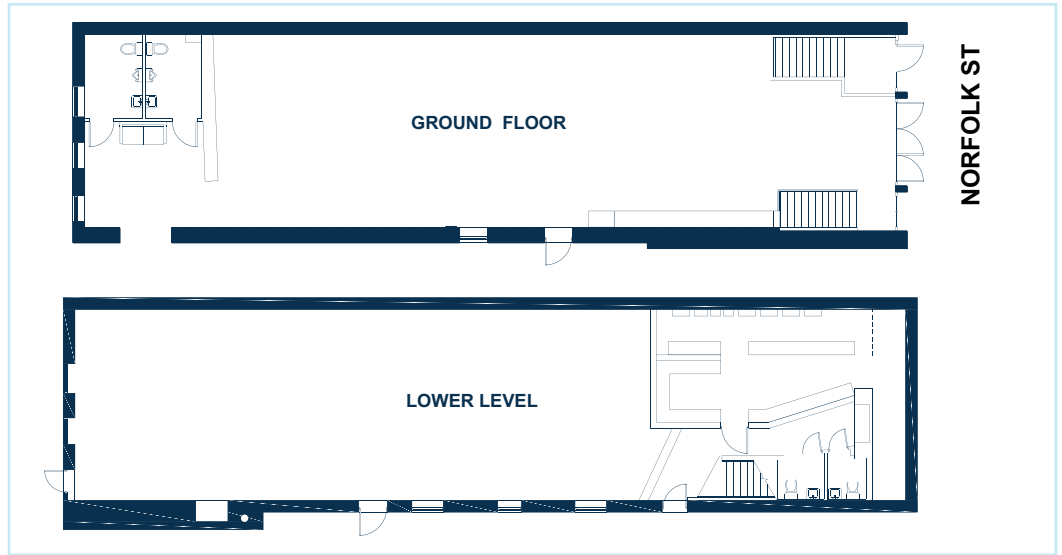

KEY

- DINING
- HOTELS
- RETAIL



EXCLUSIVE AGENT: **ROSS L. KAPLAN** 212.850.5418 RKAPLAN@NGKF.COM

DEREK KOELSCH 212.372.0740 DEREK.KOELSCH@NGKF.COM

**Newmark Grubb
Knight Frank**
Retail

www.ngkf.com/retail

