



# FOR SALE

**AVISON  
YOUNG**



**611 Lockhaven Drive**  
Houston, TX 77073

## PROPERTY DETAILS

Size:	25,074 SF / ±12,500 SF office
Year Built:	1983
Acreage:	2.46
Ceiling Height:	20'
Loading:	Two (2) dock-high doors Two (2) semi dock-high doors One (1) ramp WITH 12'X14 door
Sales Price:	Contact Broker

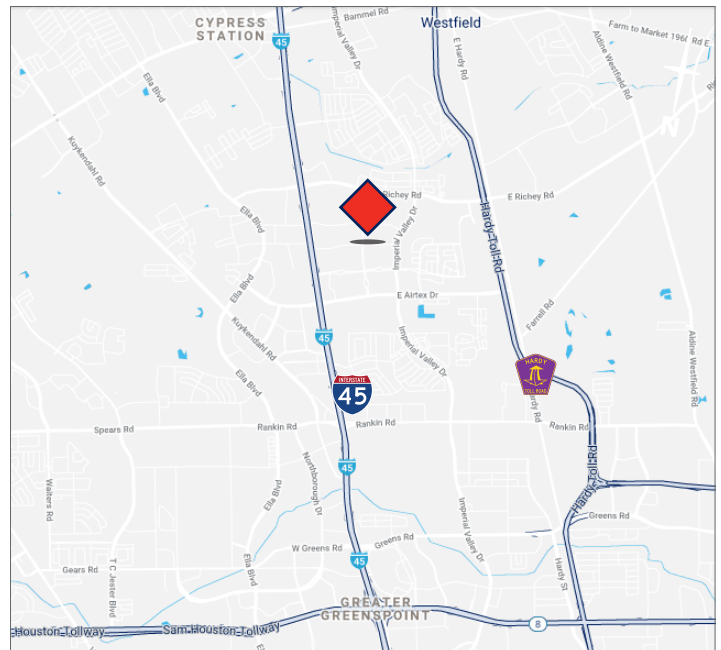

## PROPERTY HIGHLIGHTS

- > 100% climate controlled
- > One (1) 5-ton bridge crane (16' hook height)
- > Warehouse 20 FT clear height totals ±19,000 SF (requires office demolition — see page 3)
- > 3/4 acre of fenced and concrete stabilized storage yard
- > Easy access to major thoroughfares ( I-45, Hardy Toll Road, and Beltway 8)
- > Located in rapidly appreciating North Houston area
- > Two (2) semi dock-high doors

### **Drew Coupe, CCIM**

Vice President  
713.993.7832  
drew.coupe@avisonyoung.com



# 611 Lockhaven Drive

Houston, TX 77073

**AVISON  
YOUNG**

## FLOORPLAN

**25,074 SF**

Total

**12,574 SF**

Warehouse

**12,500 SF**

Office





# 611 Lockhaven Drive

Houston, TX 77073

**AVISON  
YOUNG**

**ALTERNATE  
FLOORPLAN**  
(Demolition required)

**25,074 SF**

Total

**±19,000 SF**

Warehouse

**±6,000 SF**

Office

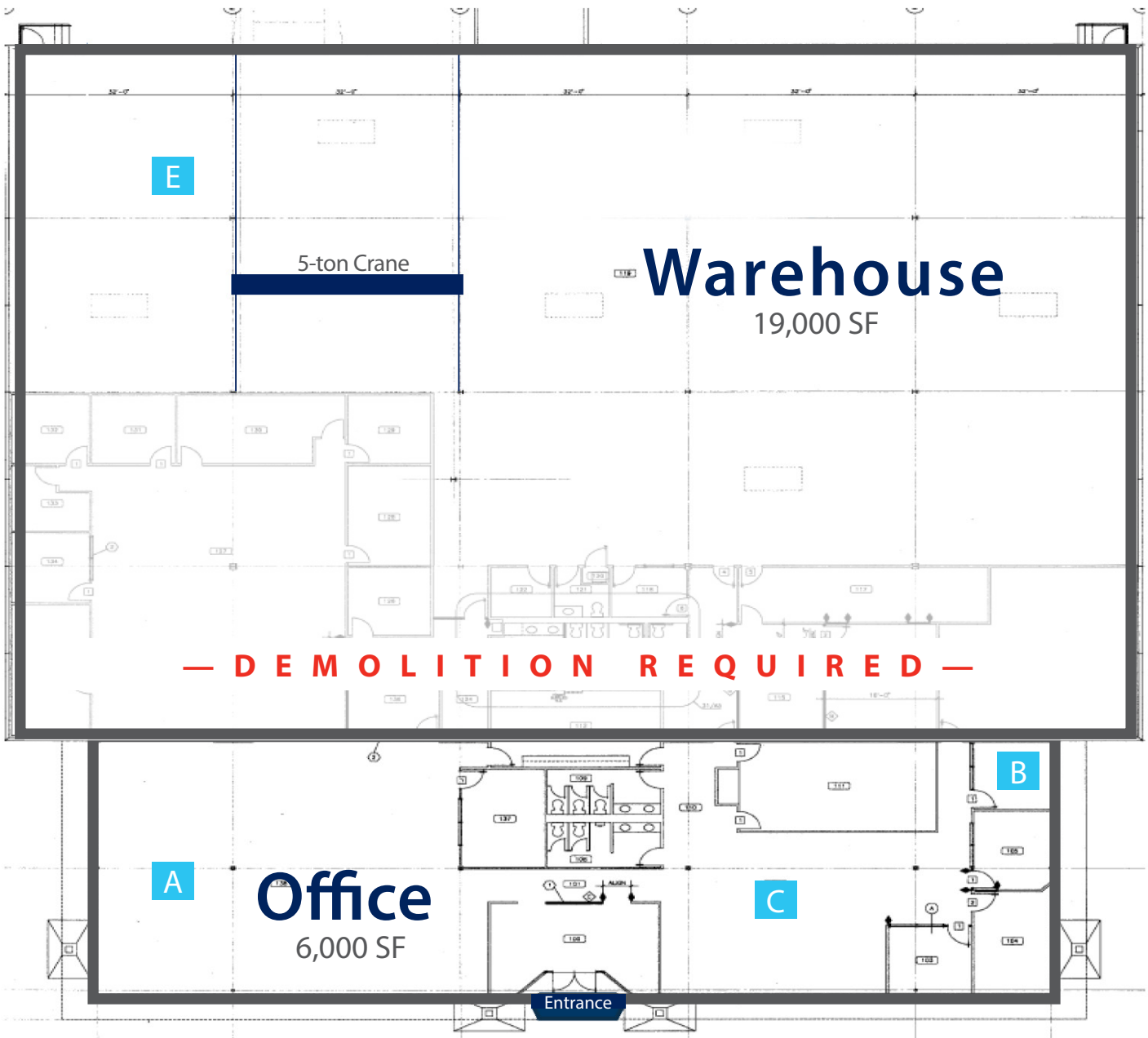



## INTERIOR PHOTOS

### & Floorplan Legend

- A** Showroom
- B** Small Office
- C** Open Workspace
- D** Interior Storage
- E** Warehouse

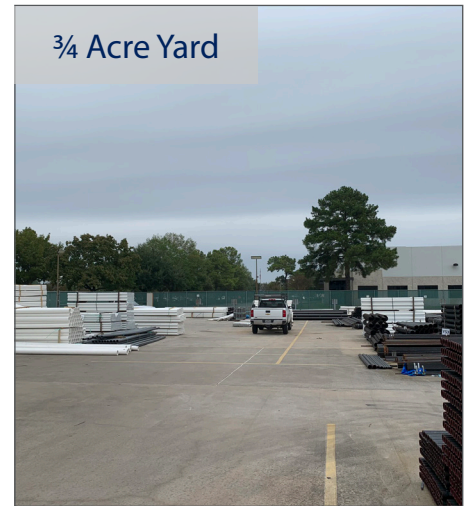
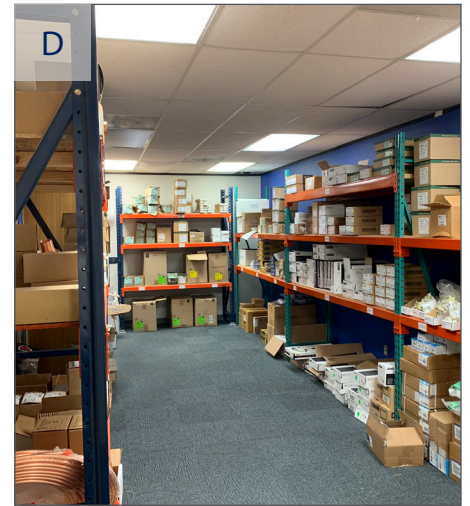



# 611 Lockhaven Drive

Houston, TX 77073

AVISON  
YOUNG

## PROPERTY OVERVIEW



FOR MORE INFORMATION CONTACT:

**Drew Coupe, CCIM**

Vice President

713.993.7832

[drew.coupe@avisonyoung.com](mailto:drew.coupe@avisonyoung.com)

This information contained herein was obtained from sources believed to be reliable; however, Avison Young makes no guarantees, warranties or representations as to the completeness or accuracy thereof. The presentation of this property is submitted subject to errors, omissions, change of price or conditions, and is subject to prior sale, lease or withdrawal without notice.