

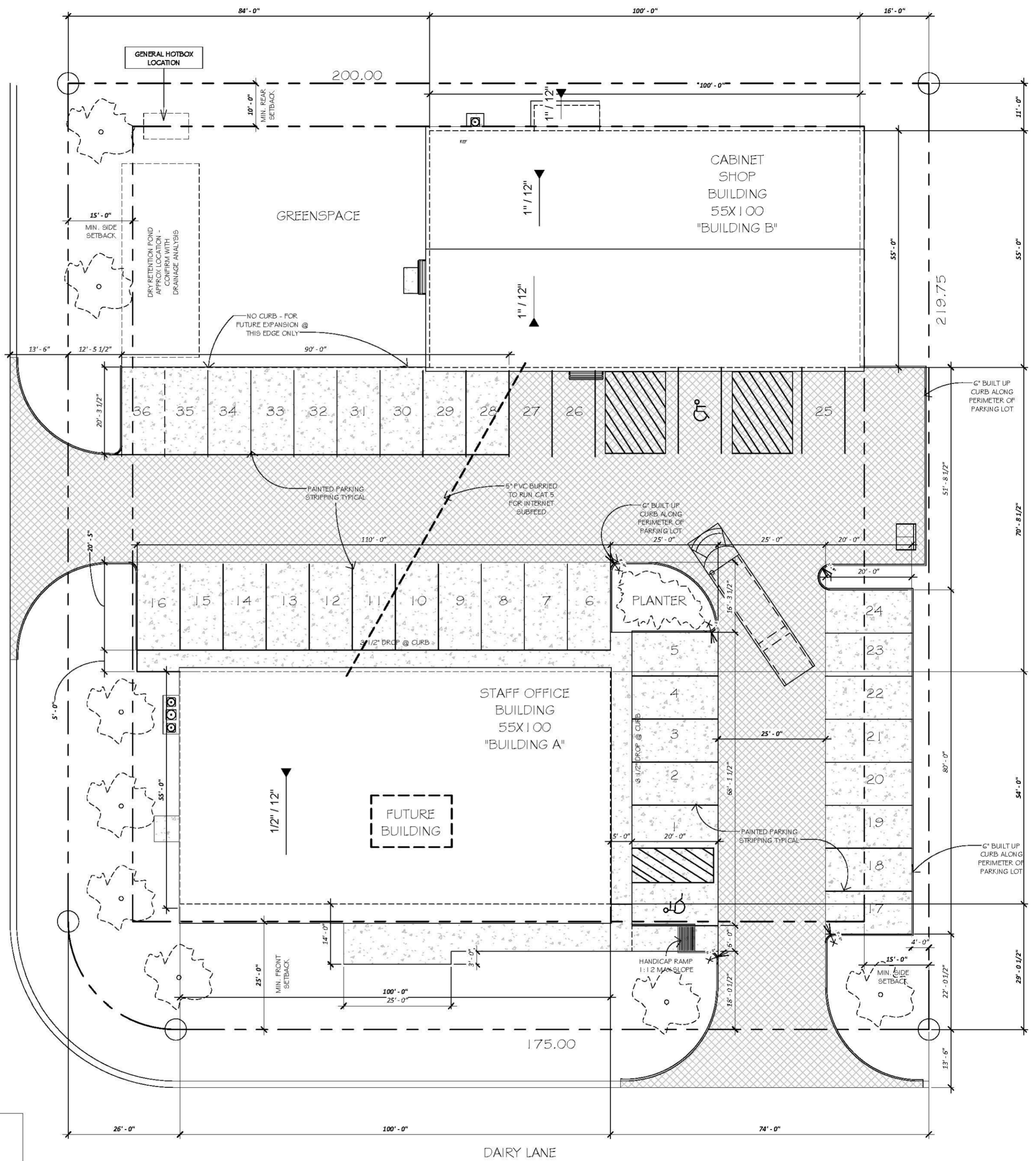

CONFIRM SEWER & ELECTRICAL LOCATIONS

PARKING SHALL COMPLY WITH TABLE 208.2 OF THE ADA GUIDELINES
 36 SPOTS + 2 HANDICAP WITH AISLES



 10920 SQ. FT. OF 6" CONCRETE PARKING

 8773 SQ. FT. OF 4" CONCRETE PARKING & SIDEWALK

SITE PLAN

SCALE: 0' 20'

