

# Bay Vista Tower

2821 2nd Avenue ♦ Seattle, WA 98121



## RETAIL FOR LEASE

Join Seattle's most densely populated and walkable neighborhood — Belltown— boasting a vibrant mix of much-loved neighborhood restaurants, a well-known artist and artisan community, easily-accessible daily needs and services, and walkability to some of the City's top attractions, including the Olympic Sculpture Park, Seattle Center and the world class entertainment and sports arena, Climate Pledge.



Tiffini Connell | Avery Connell | Kara Farley  
(206) 283-5212

[www.wccommercialrealty.com](http://www.wccommercialrealty.com)

**WCCR**  
West Coast Commercial Realty



# Bay Vista Tower

2821 2nd Avenue ♦ Seattle, WA 98121

## THE OPPORTUNITY:



Prime retail space is available NOW on the ground floor of Bay Vista Tower, a 24-story well-established and well-known condominium project with 77 residential condominiums coupled with a mix of retail and office on the highly-visible corner of 2nd Avenue and Broad Street. Tap into a young and dynamic residential population, as well as tourists, visitors and area business owners and employees.

Call today for more information!



**WCCR**  
West Coast Commercial Realty





# Bay Vista Tower

2821 2nd Avenue ♦ Seattle, WA 98121

## DEMOGRAPHICS

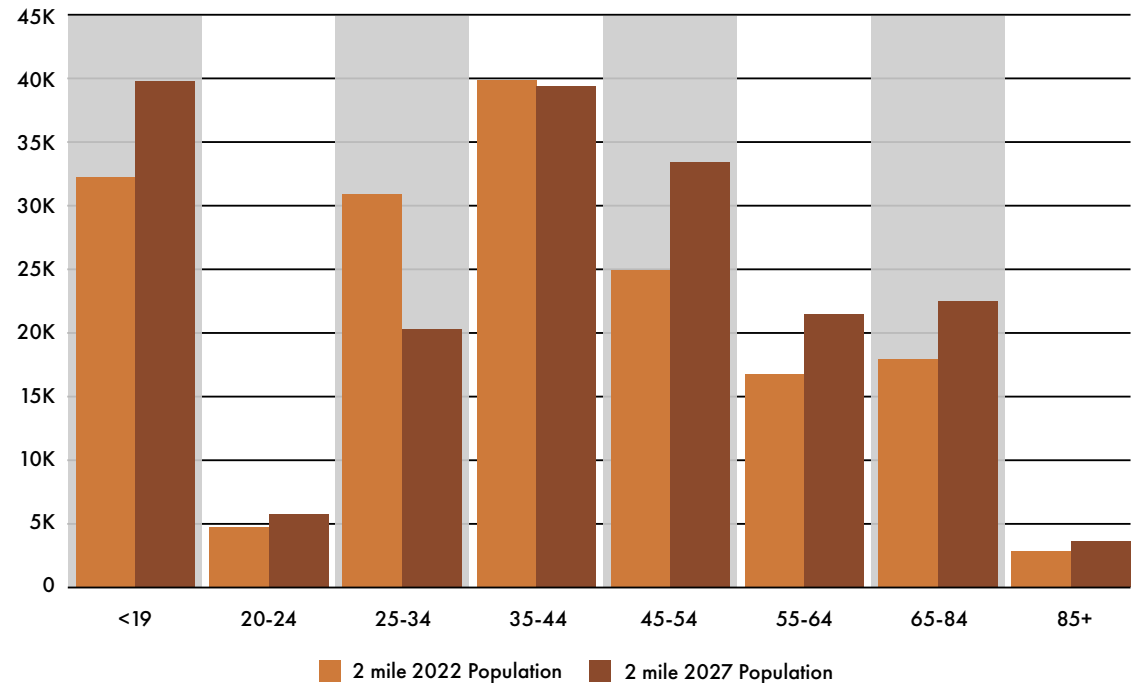

**TOTAL  
POPULATION**



**TOTAL  
EMPLOYEES**



**AVERAGE  
HOUSEHOLD  
INCOME**

1-Mile: 68,853

3-Mile: 271,978

5-Mile: 518,178

1-Mile: 68,653

3-Mile: 271,748

5-Mile: 517,061

1-Mile: \$121,656

3-Mile: \$121,108

5-Mile: \$125,764

Tiffini Connell | Avery Connell | Kara Farley

(206) 283-5212

[www.wccommercialrealty.com](http://www.wccommercialrealty.com)



DISCLAIMER: The above information has been secured from sources believed to be reliable, however, no representations are made to its accuracy. Prospective tenants or buyers should consult their professional advisors and conduct their own independent investigation. Site plan and configuration are subject to change. Properties are subject to change in price and/or availability without notice. West Coast Commercial Realty, LLC

**WCCR**

West Coast Commercial Realty



# Bay Vista Tower

2821 2nd Avenue ♦ Seattle, WA 98121



Tiffini Connell | Avery Connell | Kara Farley

(206) 283-5212

[www.wccommercialrealty.com](http://www.wccommercialrealty.com)



DISCLAIMER: The above information has been secured from sources believed to be reliable, however, no representations are made to its accuracy. Prospective tenants or buyers should consult their professional advisors and conduct their own independent investigation. Site plan and configuration are subject to change. Properties are subject to change in price and/or availability without notice. West Coast Commercial Realty, LLC

## WCCR

West Coast Commercial Realty



# Bay Vista Tower

2821 2nd Avenue ♦ Seattle, WA 98121

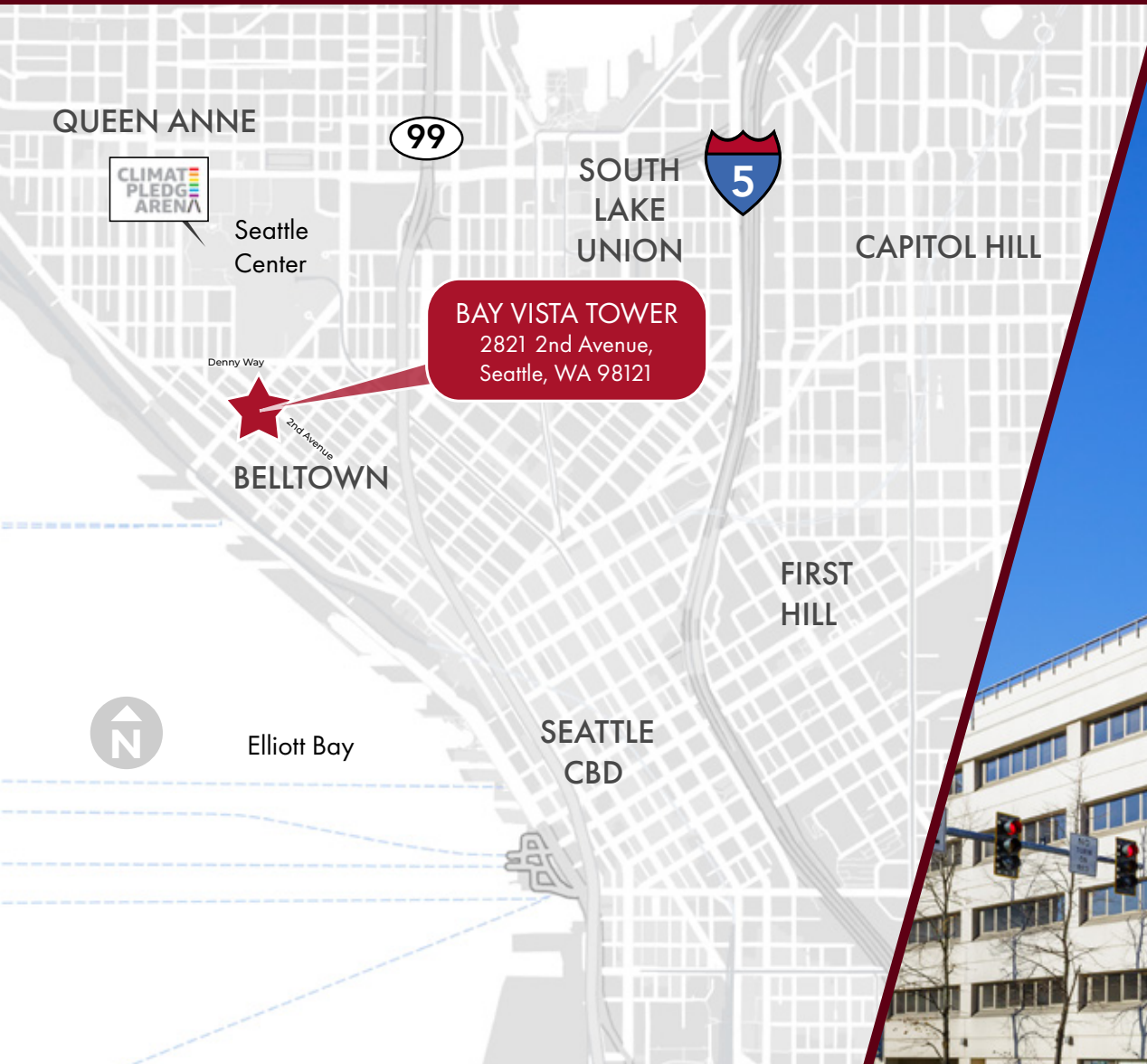

## TRAFFIC COUNTS

@ Denny Way: 34,100 + vehicles per day

# Bay Vista Tower

2821 2nd Avenue ♦ Seattle, WA 98121

## FLOOR PLAN

RETAIL FOR LEASE

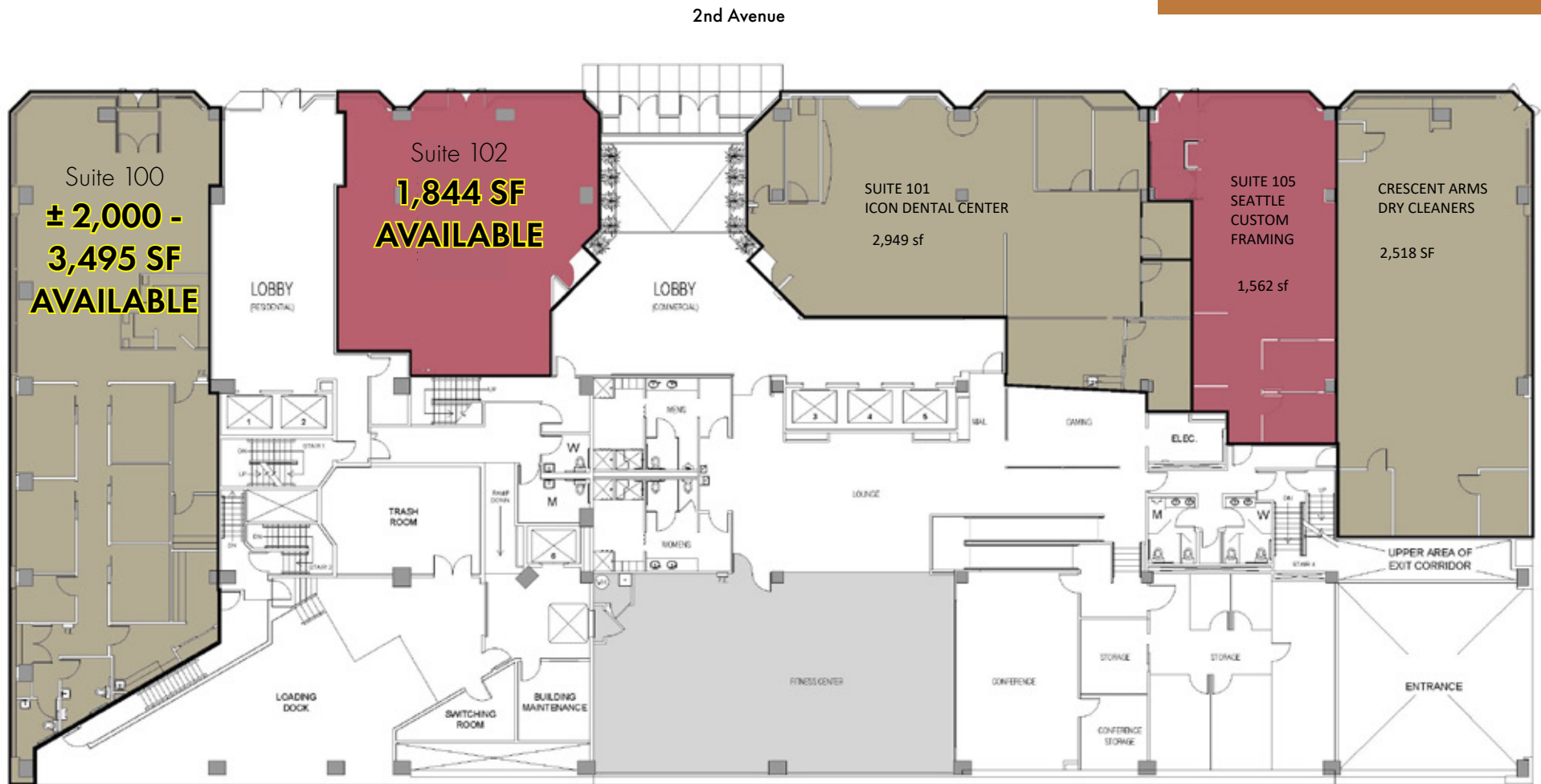

Tiffini Connell | Avery Connell | Kara Farley

(206) 283-5212

[www.wccommercialrealty.com](http://www.wccommercialrealty.com)



DISCLAIMER: The above information has been secured from sources believed to be reliable, however, no representations are made to its accuracy. Prospective tenants or buyers should consult their professional advisors and conduct their own independent investigation. Site plan and configuration are subject to change. Properties are subject to change in price and/or availability without notice. West Coast Commercial Realty, LLC

WCCR

West Coast Commercial Realty