



**CUSHMAN &  
WAKEFIELD**  
Commerce

FOR LEASE

**3855 South 500 West Units I & J**  
South Salt Lake City, UT 84115

UNIT I & J



**Lease Rate: \$5,768 per month, NNN**

### Property Highlights

- Total size: 8,300 SF
- Office: 5,702 SF
- Warehouse: 2,598 SF
- (2) 10' x 10' ground level overhead doors
- 3 phase power
- Very clean office finish
- 3 restrooms with showers
- HVAC throughout
- Great location with frontage to 500 W

#### Bob Mills

Executive Director  
+1 801 303 5551  
bmills@comre.com



170 South Main Street, Suite 1600  
Salt Lake City, UT 84101  
Main +1 801 322 2000  
Fax +1 801 322 2040  
**comre.com**

*Independently Owned and Operated / A Member of the Cushman & Wakefield Alliance*

Cushman & Wakefield Copyright 2017. No warranty or representation, express or implied, is made to the accuracy or completeness of the information contained herein, and same is submitted subject to errors, omissions, change of price, rental or other conditions, withdrawal without notice, and to any special listing conditions imposed by the property owner(s). As applicable, we make no representation as to the condition of the property (or properties) in question. (path: G:\1 - Projects\Mills, B\1 - Flyers\3855s500w.LJ)



**CUSHMAN &  
WAKEFIELD**  
Commerce

FOR LEASE

**3855 South 500 West Units I & J**  
South Salt Lake City, UT 84115

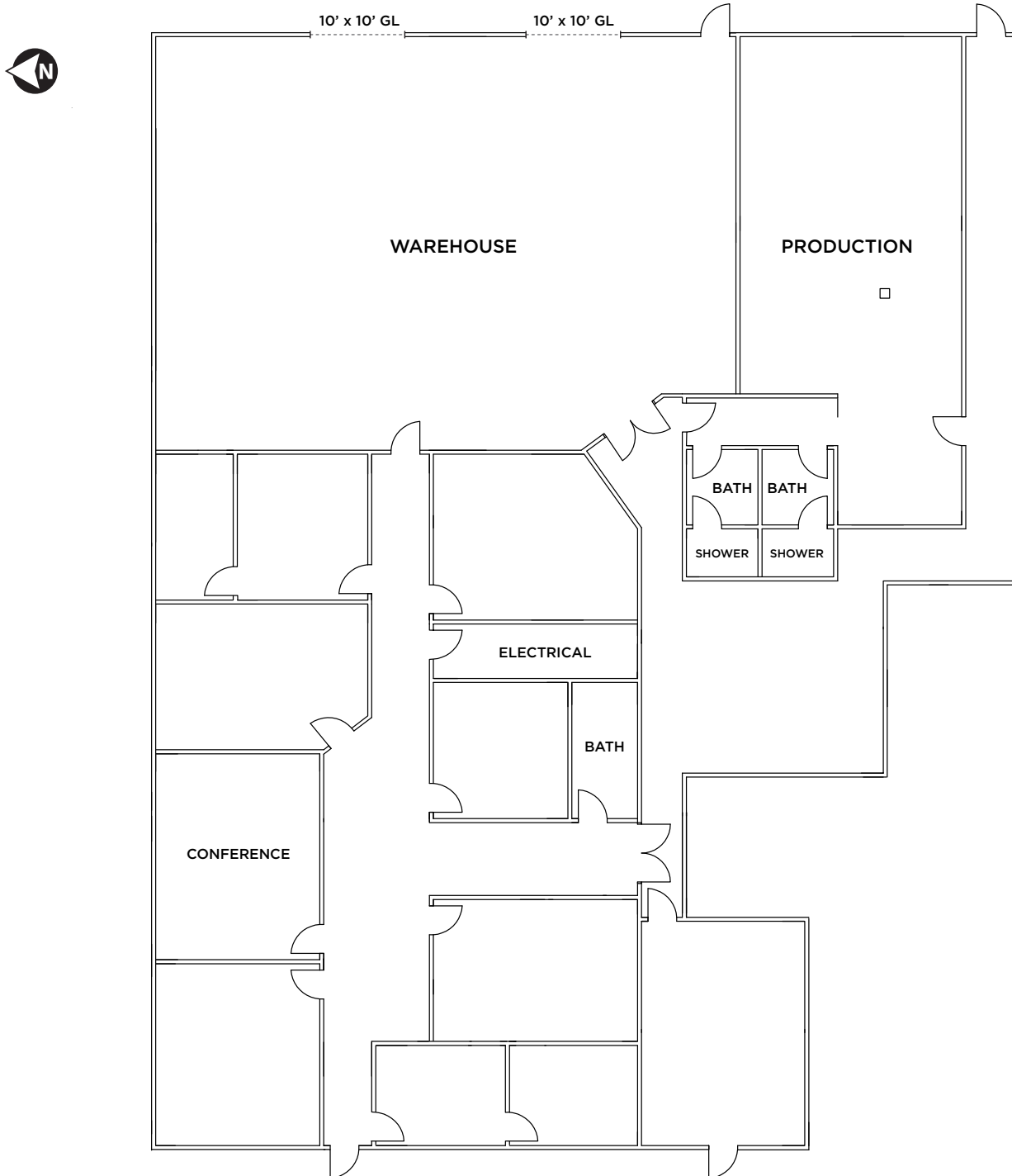

**Bob Mills**  
Executive Director  
+1 801 303 5551  
bmills@comre.com

170 South Main Street, Suite 1600  
Salt Lake City, UT 84101  
Main +1 801 322 2000  
Fax +1 801 322 2040  
**comre.com**

*Independently Owned and Operated / A Member of the Cushman & Wakefield Alliance*

Cushman & Wakefield Copyright 2017. No warranty or representation, express or implied, is made to the accuracy or completeness of the information contained herein, and same is submitted subject to errors, omissions, change of price, rental or other conditions, withdrawal without notice, and to any special listing conditions imposed by the property owner(s). As applicable, we make no representation as to the condition of the property (or properties) in question. (path: G:\1 - Projects\Mills, B\1 - Flyers\3855s500w.LJ)