

48-02 48th Avenue, Long Island City

For Lease

**143,600 SF Warehouse Plus 10,500 Parking
Divisions 10.5K / 15K / 20K / 33K**



For Further Information and Inspection, Please Contact Exclusive Agents:

 **Sholom &
Zuckerbrot** Realty LLC
Established 1962

Michael Dokianos
(718) 732-0623
mdokianos@s-z.com

Joseph Meyerson
(718) 732-0622
jmeyerson@s-z.com

John G. J. Ritter
(718) 371-0131
jritter@s-z.com

Kaufman Astoria Studios 35-11 35th Avenue, Long Island City, NY 11106 • (718) 392-5959 • Fax (718) 937-6546 • www.s-z.com

Although all information is from sources deemed reliable, and no representation is made as to the accuracy thereof, it is submitted subject to errors, omissions, changes of price, prior sale, or withdrawal without notice

48-02 48th Avenue, Long Island City, NY

Available
143,600 sq. ft. Plus
10,500 sq. ft. Land

Features:

- ❖ Divisible to 10,404 sf
- ❖ Fireproof – Sprinklered
- ❖ 14' – 20' ceiling height
- ❖ 10 interior docks
- ❖ 2 drive-in
- ❖ Heavy AMPS; oil & gas heat
- ❖ Column spacing 30' X 30'
- ❖ 10,000 sf parking (30 cars)
- ❖ 3 mins to 7 train at 46 St – Bliss St.
- ❖ Zone M1-1
- ❖ Block 2292 Lot 7

Ideal For:

E-Commerce distribution,
Film & TV studio production
Building Material
Warehouse, Mini-storage
Food distribution
Entertainment facility

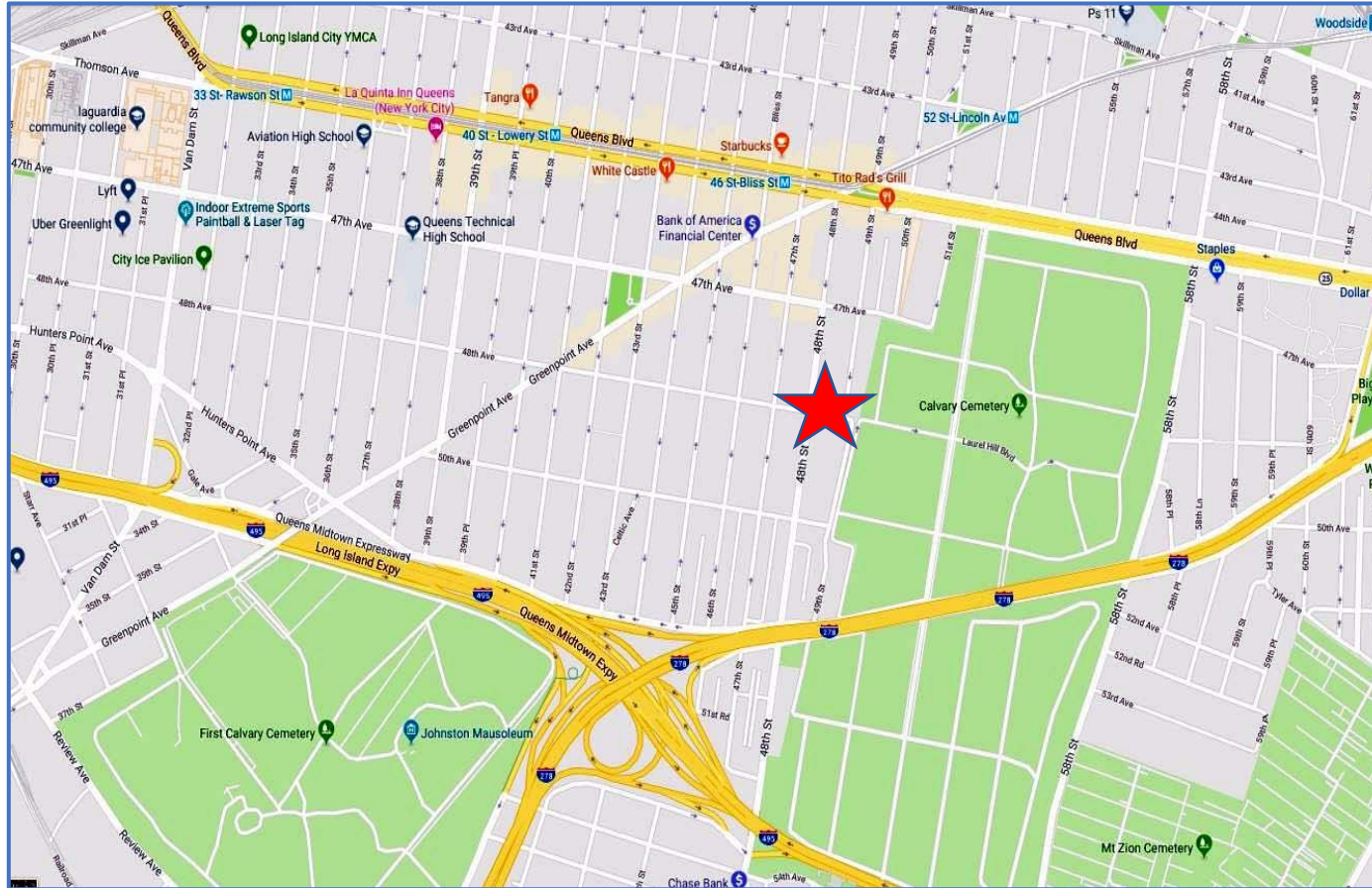

**Sholom &
Zuckerbrot** Realty LLC
Established 1962

Michael Dokianos
(718) 732-0623
mdokianos@s-z.com

Joseph Meyerson
(718) 732-0622
jmeyerson@s-z.com

John G. J. Ritter
(718) 371-0131
jritter@s-z.com

Kaufman Astoria Studios 35-11 35th Avenue, Long Island City, NY 11106 • (718) 392-5959 • Fax (718) 937-6546 • www.s-z.com

Although all information is from sources deemed reliable, and no representation is made as to the accuracy thereof, it is submitted subject to errors, omissions, changes of price, prior sale, or withdrawal without notice

48-02 48th Avenue, Long Island City, NY



 **Sholom &
Zuckerbrot** Realty LLC
Established 1962

Michael Dokianos
(718) 732-0623
mdokianos@s-z.com

Joseph Meyerson
(718) 732-0622
jmeyerson@s-z.com

John G. J. Ritter
(718) 371-0131
jritter@s-z.com

Kaufman Astoria Studios 35-11 35th Avenue, Long Island City, NY 11106 • (718) 392-5959 • Fax (718) 937-6546 • www.s-z.com

Although all information is from sources deemed reliable, and no representation is made as to the accuracy thereof, it is submitted subject to errors, omissions, changes of price, prior sale, or withdrawal without notice

48-02 48th Avenue, Long Island City, NY

First Floor

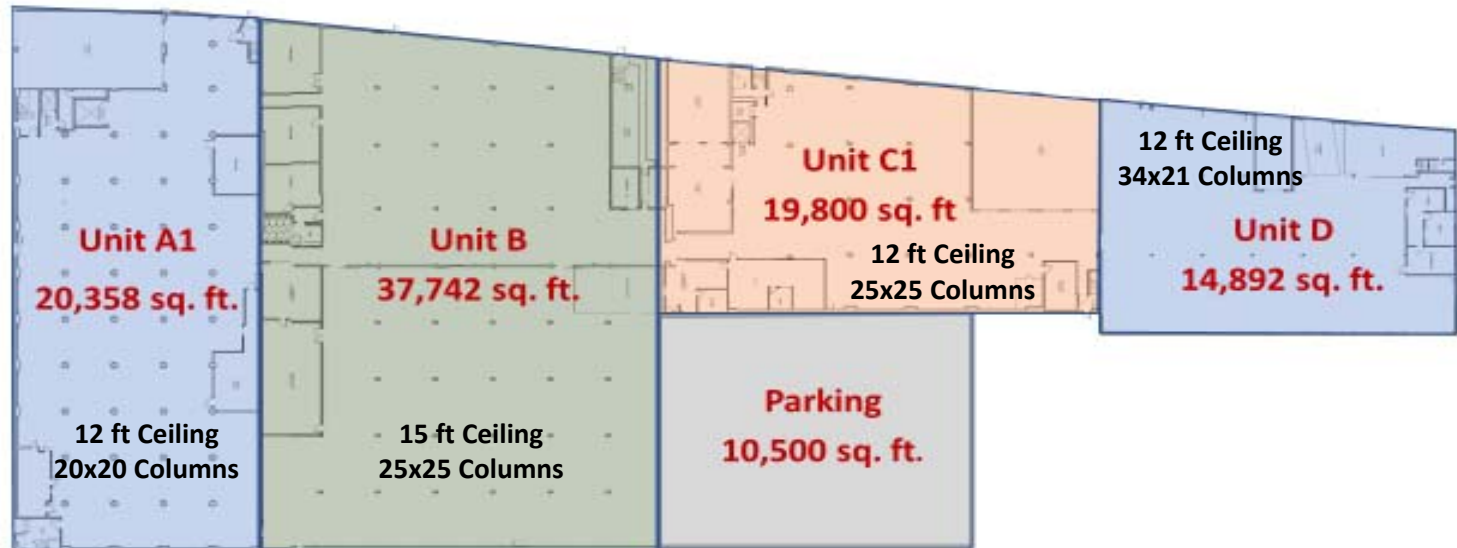

Unit B – Owner will configure docks to Tenant's request

48-02 48th Avenue, Long Island City, NY

Second Floor

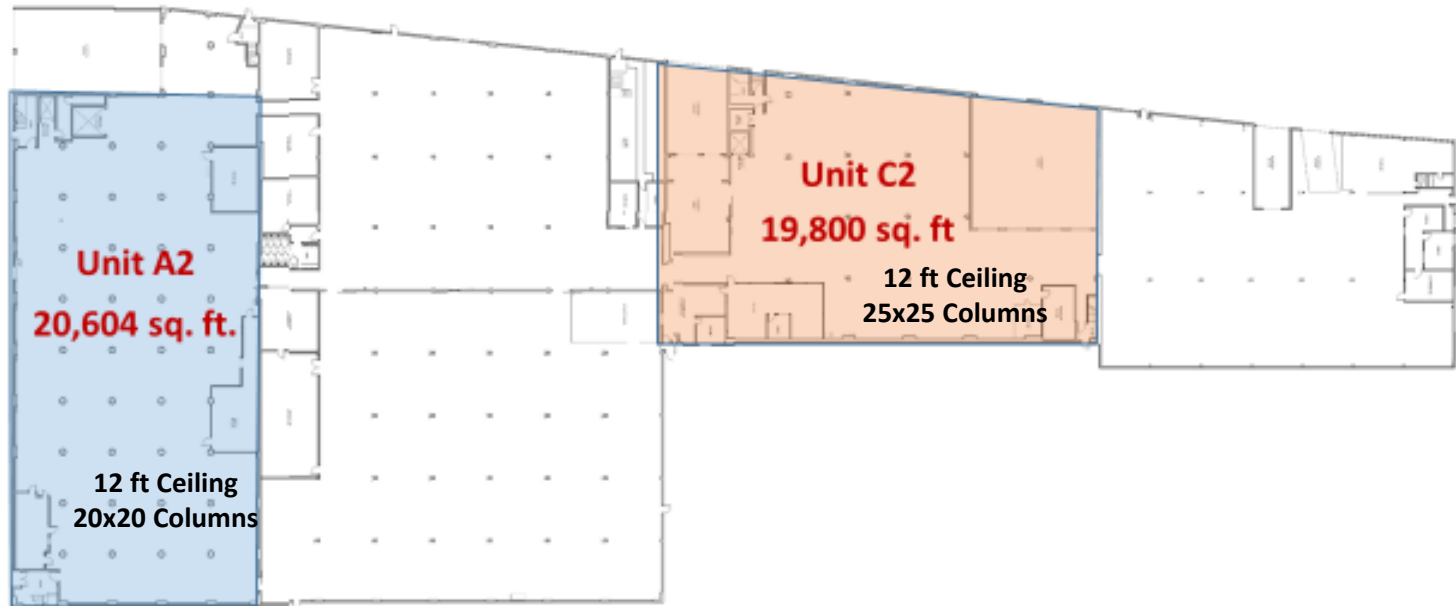

48-02 48th Avenue, Long Island City, NY

Third Floor

