

FOR LEASE 5,544 SF

→ OVERVIEW

6th Avenue Business Park is conveniently located at the southwest corner of West 6th Avenue and Indiana Street offering easy access to 6th Avenue, I-70 and C-470 and just 15 short minutes to the downtown Denver central business district.



→ PROPERTY STATISTICS

Available	Immediately
Available SF	5,544
Office SF	3,659
Warehouse SF	1,885
Base Rent	\$9.00/SF
2012 NNN	\$4.12/SF
Monthly Rent	\$6,061.44
Loading Dock	None
Drive-In Loading	One (1)
Drop Ceiling	10' - 0"
Parking Facilities	Unreserved, Surface
Power	110 Amp/3-Phase
Zoning	PUD
Taxes	Unincorporated Jefferson County

14828 W. 6th Ave., Unit 1-B
Golden, CO 80401

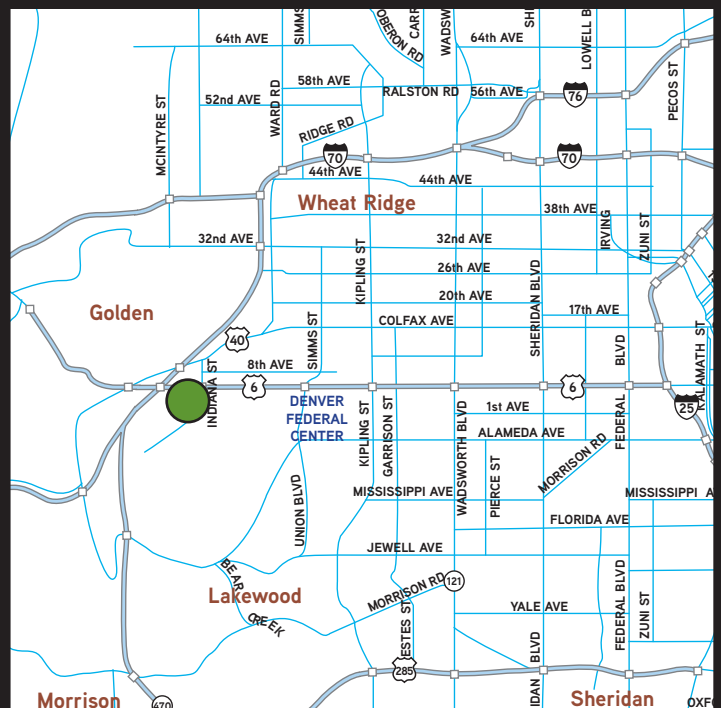

FIRST INDUSTRIAL REALTY TRUST

8200 Park Meadows Drive, Suite 8226, Lone Tree, CO 80124
T: (303) 220-5565 F: (303) 220-5585 www.firstindustrial.com



14828 W. 6th Ave., Unit 1-B
Golden, CO 80401

FOR LEASE 5,544 SF

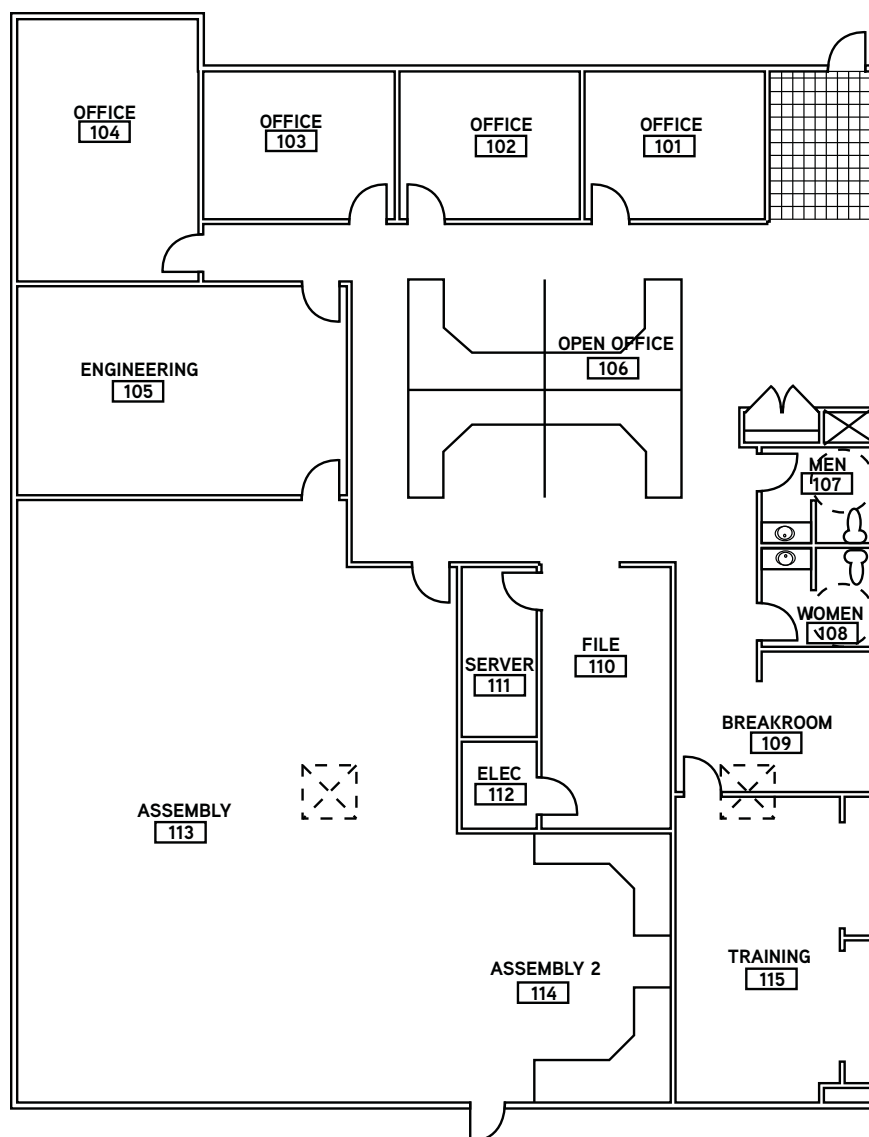

→ CONTACT

Exclusive Agent:



Chris Fisher, Jr.
(720) 833-4612
christopher.fisher@colliers.com

T.J. Smith, SIOR
(303) 283-4576
tj.smith@colliers.com

COLLIERS INTERNATIONAL

4643 South Ulster Street
Suite 1000
Denver, Colorado 80237
303.745.5800
303.745.5888 fax
www.colliers.com

All information furnished regarding the property for sale, rental or financing is obtained from sources deemed reliable. No representation is made to the accuracy thereof and is submitted subject to errors, omissions, change of price rental or other conditions, prior sale, lease, or financing, or withdrawal without notice. First Industrial Realty Trust, Inc. represents the Seller in this transaction and as such owes all duties and obligations thereto.

FIRST INDUSTRIAL REALTY TRUST

8200 Park Meadows Drive, Suite 8226, Lone Tree, CO 80124
T: (303) 220-5565 F: (303) 220-5585 www.firstindustrial.com

