

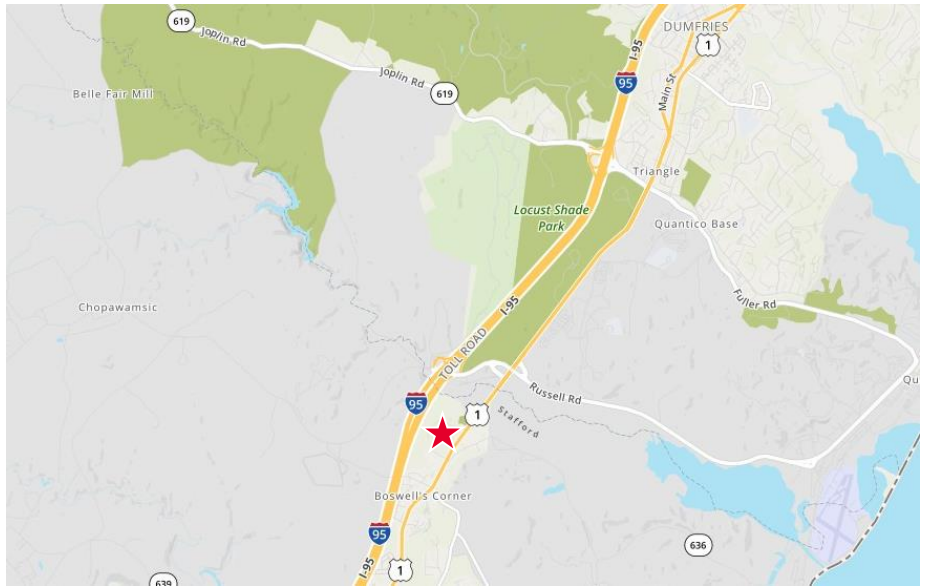

**Property Features**

- 8' x 8' Roll-up door
- Reception area, offices, conference room, kitchen and bathrooms
- Electric, phone, Internet and water available
- Zoned M-1 Light Industrial

Specifications	
Available SF	12,000 SF
Lease Rate	\$10 PSF
Parking	25 spaces



For more information, contact:

**VIRGIL NELSON, CCIM**  
 540 322 4150  
 virgil.nelson@thalhimer.com

Eagle Village  
 1125 Jefferson Davis Highway, Suite 350  
 Fredericksburg, VA 22401-8449  
 www.thalhimer.com

FLOOR PLAN

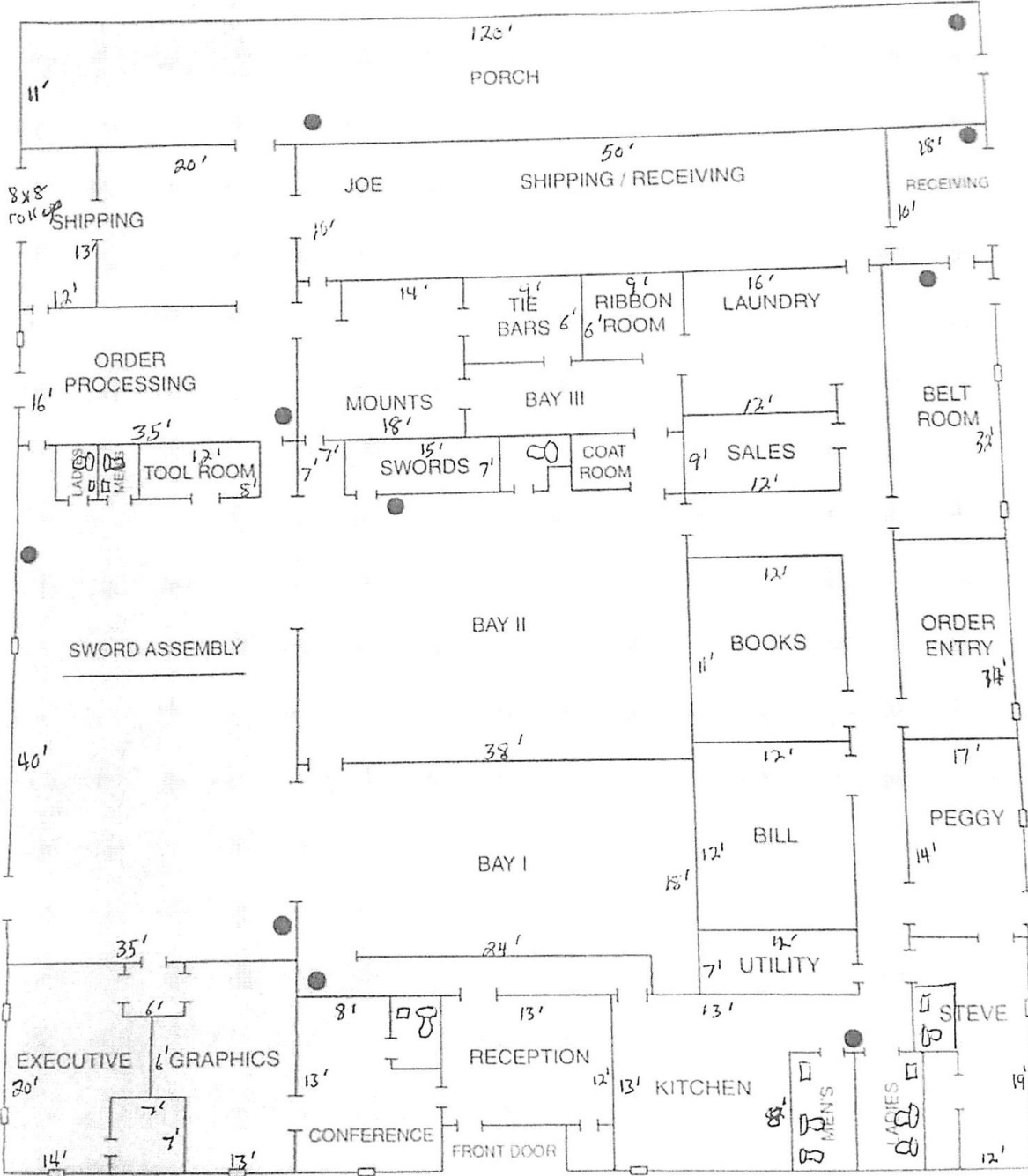

For more information, contact:

**VIRGIL NELSON, CCIM**  
 540 322 4150  
 virgil.nelson@thalhimer.com

Eagle Village  
 1125 Jefferson Davis Highway, Suite 350  
 Fredericksburg, VA 22401-8449  
 www.thalhimer.com



INTERIOR PHOTOS



For more information, contact:

**VIRGIL NELSON, CCIM**  
540 322 4150  
[virgil.nelson@thalhimer.com](mailto:virgil.nelson@thalhimer.com)

Eagle Village  
1125 Jefferson Davis Highway, Suite 350  
Fredericksburg, VA 22401-8449  
[www.thalhimer.com](http://www.thalhimer.com)

*Independently Owned and Operated / A Member of the Cushman & Wakefield Alliance*

*Cushman & Wakefield | Thalhimer © 2015. No warranty or representation, express or implied, is made to the accuracy or completeness of the information contained herein, and same is submitted subject to errors, omissions, change of price, rental or other conditions, withdrawal without notice, and to any special listing conditions imposed by the property owner(s). As applicable, we make no representation as to the condition of the property (or properties) in question.*