

SOHO

NEW YORK
NY

302 CANAL STREET



SPACE DETAILS

LOCATION

South block between Church Street and Broadway

APPROXIMATE SIZE

Ground Floor	1,200 SF
Lower Level	1,200 SF

FRONTAGE

20 FT on Canal Street
20 FT on Lispenard Street

CEILING HEIGHT

Ground Floor	13 FT
--------------	-------

SITE STATUS

Currently GNC

NEIGHBORS

Chase, Bank of America, Opening Ceremony, Foot Locker and Pearl River Mart

COMMENTS

Dual entrances on Canal and Lispenard Streets

Located along a major thoroughfare with heavy residential, tourist and vehicular traffic

Easily accessible to the 6 N Q R W J and Z Subway lines at Canal Street with 15 million annual riders

GROUND FLOOR

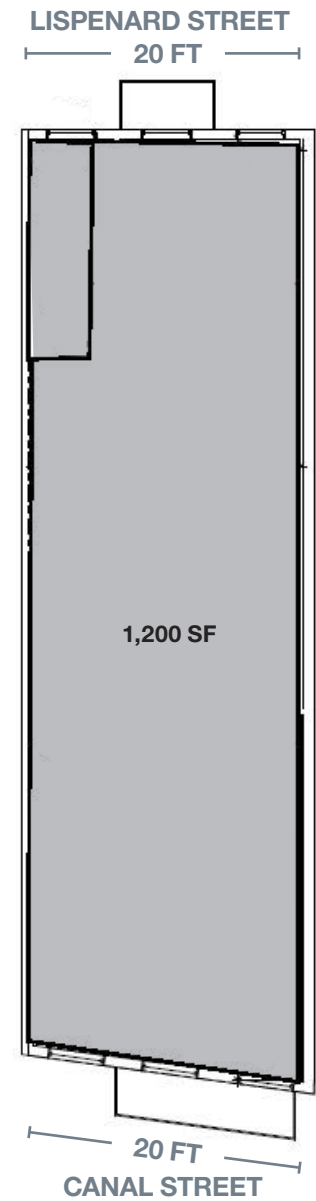

AREA RETAIL

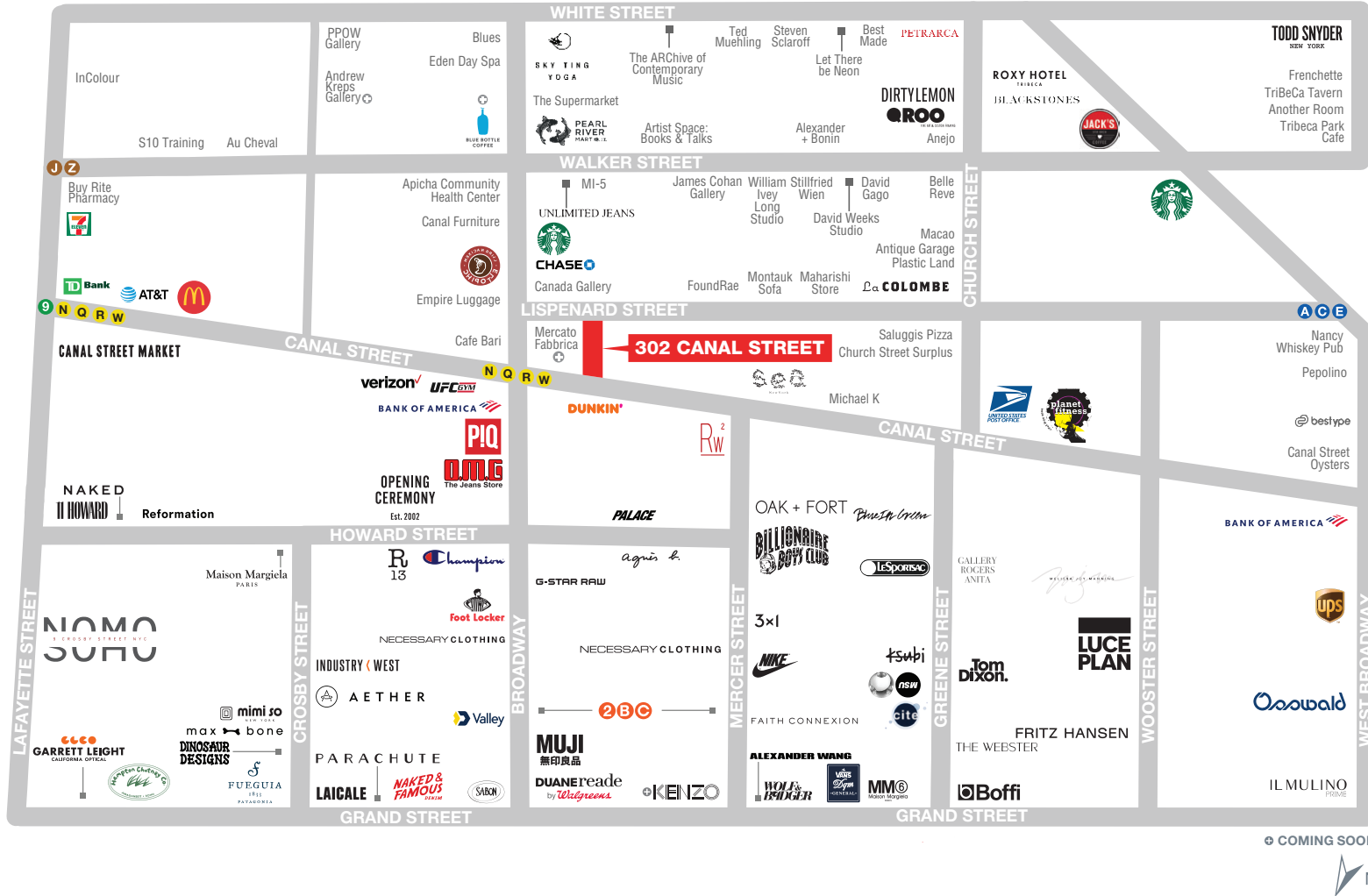

CONTACT EXCLUSIVE AGENT

JASON PRUGER
212.372.2092
jason.pruger@ngkf.com