

**±73,422 SF**

**2221 & 2233 E. PHILADELPHIA ST. ONTARIO, CALIFORNIA**

**FOR SALE/LEASE**

**Newly Refurbished**



**FEATURES:**

- ±73,422 SF on 3.09 Acres of Land
- ±12,690 sf of "Turn-Key/Fully Furnished" HVAC Office (2-Story) with premium quality furniture, cubicles and storage
- 24' Minimum Clear Height
- Seven (7) Grade Level Doors
- Three (3) Dock High Doors (Plus 3 Possible DH Doors)
- 6,000 Amps, 277/480 Volt Power (Verify)
- .45/3,000 Sprinkler System
- T-8 Warehouse Lighting (w/ Motion Sensors)
- Fiber optic cable equipped
- Warehouse vacuum system in place
- Large fully secured yard
- Distributed power throughout warehouse
- Located in the IE West, fronting Philadelphia St, less than 1 mile to the CA-60 and close to the I-15 & I-10



COMMERCIAL REAL ESTATE SERVICES

3535 Inland Empire Blvd. • Ontario, CA 91764  
ph: 909.989.7771 fx: 909.944.8250  
www.lee-assoc.com | Corporate ID # 00976995

**KEN JONES**  
909.373.2726  
kjones@lee-assoc.com  
License #01703262

**STEPHEN DEVERIAN**  
909.373.2938  
sdeverian@lee-assoc.com  
License #01964686

**MIKE WOLFE**  
909.373.2915  
mwolfe@lee-assoc.com  
License #01410974

All information furnished regarding property for sale, rental or financing is from sources deemed reliable, but no warranty or representation is made to the accuracy thereof and same is submitted to errors, omissions, change of price, rental or other conditions prior to sale, lease or financing or withdrawal without notice. No liability of any kind is to be imposed on the broker herein.

**±73,422 SF**

**2221 & 2233 E. PHILADELPHIA ST. ONTARIO, CALIFORNIA**

2221 Philadelphia Street

2223 Philadelphia Street

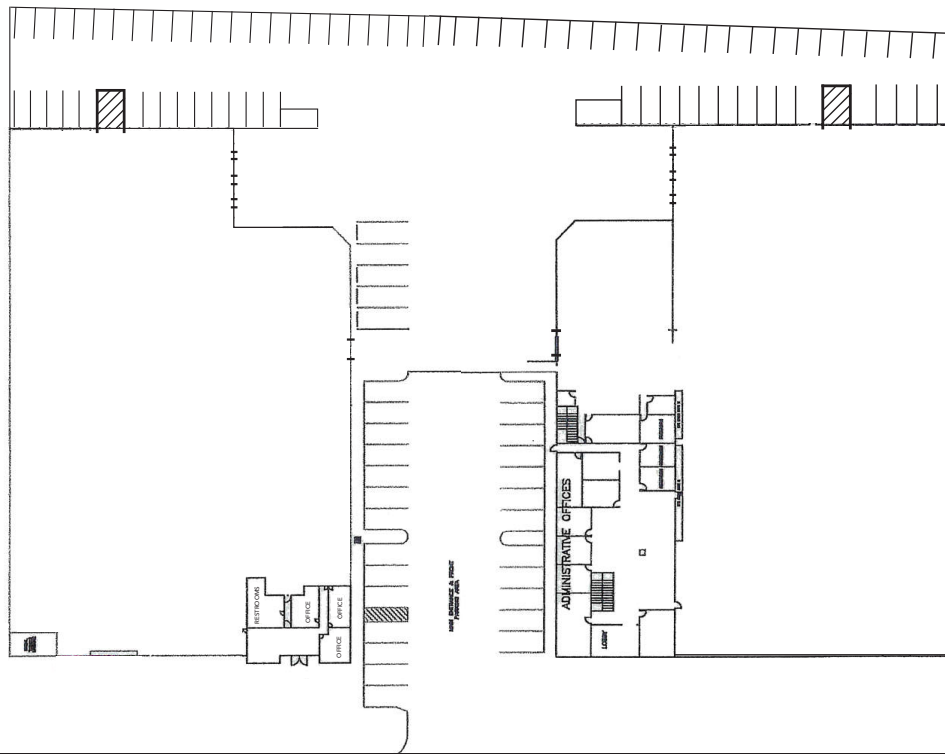

Philadelphia Street

Second Floor  
Office Layout

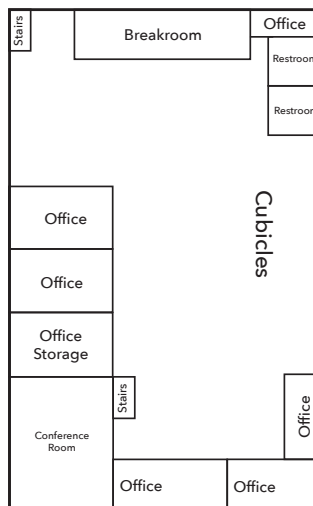

Philadelphia Street

**FOR SALE/LEASE**



COMMERCIAL REAL ESTATE SERVICES

3535 Inland Empire Blvd. • Ontario, CA 91764  
ph: 909.989.7771 fx: 909.944.8250  
www.lee-assoc.com | Corporate ID # 00976995

**KEN JONES**  
909.373.2726  
kjones@lee-assoc.com  
License #01703262

**STEPHEN DEVERIAN**  
909.373.2938  
sdeverian@lee-assoc.com  
License #01964686

**MIKE WOLFE**  
909.373.2915  
mwolfe@lee-assoc.com  
License #01410974

All information furnished regarding property for sale, rental or financing is from sources deemed reliable, but no warranty or representation is made to the accuracy thereof and same is submitted to errors, omissions, change of price, rental or other conditions prior to sale, lease or financing or withdrawal without notice. No liability of any kind is to be imposed on the broker herein.



**±73,422 SF**

**2221 & 2233 E. PHILADELPHIA ST. ONTARIO, CALIFORNIA**

**FOR SALE/LEASE**



**LEE & ASSOCIATES**

COMMERCIAL REAL ESTATE SERVICES

3535 Inland Empire Blvd. • Ontario, CA 91764  
ph: 909.989.7771 fx: 909.944.8250  
www.lee-assoc.com | Corporate ID # 00976995

**KEN JONES**  
909.373.2726  
kjones@lee-assoc.com  
License #01703262

**STEPHEN DEVERIAN**  
909.373.2938  
sdeverian@lee-assoc.com  
License #01964686

**MIKE WOLFE**  
909.373.2915  
mwolfe@lee-assoc.com  
License #01410974

All information furnished regarding property for sale, rental or financing is from sources deemed reliable, but no warranty or representation is made to the accuracy thereof and same is submitted to errors, omissions, change of price, rental or other conditions prior to sale, lease or financing or withdrawal without notice. No liability of any kind is to be imposed on the broker herein.