

312 7TH AVE

NW Corner of 8th St - Park Slope BK

LEVITAN



312 7TH AVE

NW Corner of 8th St - Park Slope BK

GROUND: 1,887 sf
BASEMENT: 1,887 sf
FRONTAGE: 125' wraparound
CONDITION: Vanilla box to be provided

CONDITION: Immediate

NEIGHBORS: Methodist Hospital, John Jay High School, Starbucks, 5 Guys, Just Salad, Pokeworks, AT&T, Chipotle, Bank Of America, Cohen's Fashion Optical, Greentree Pharmacy



RETAIL MAP



312 7TH AVE

NW Corner of 8th St

Basement Floorplan

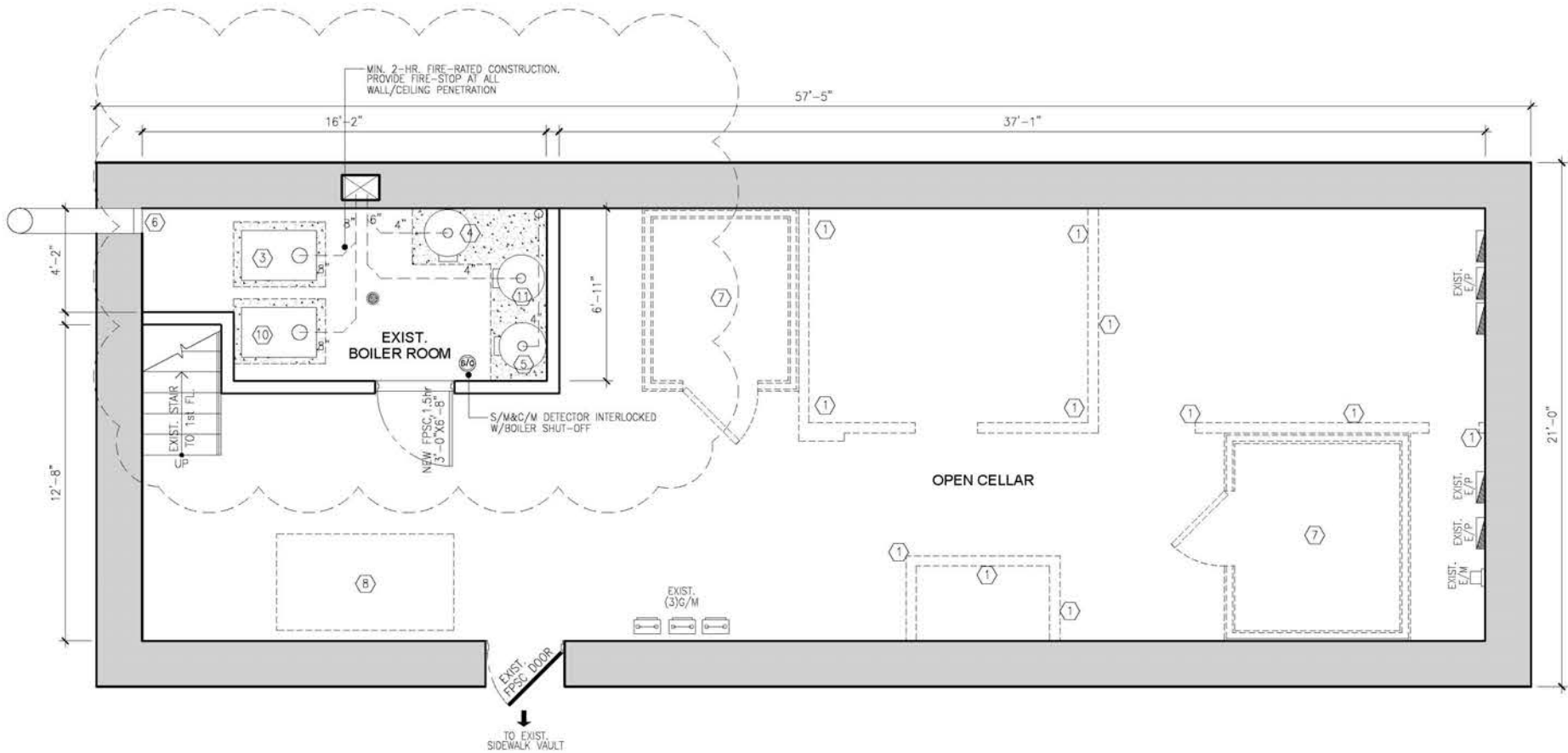

LEVITAN

www.levitanrealestate.com