

# Gateway Center Availabilities August 2019

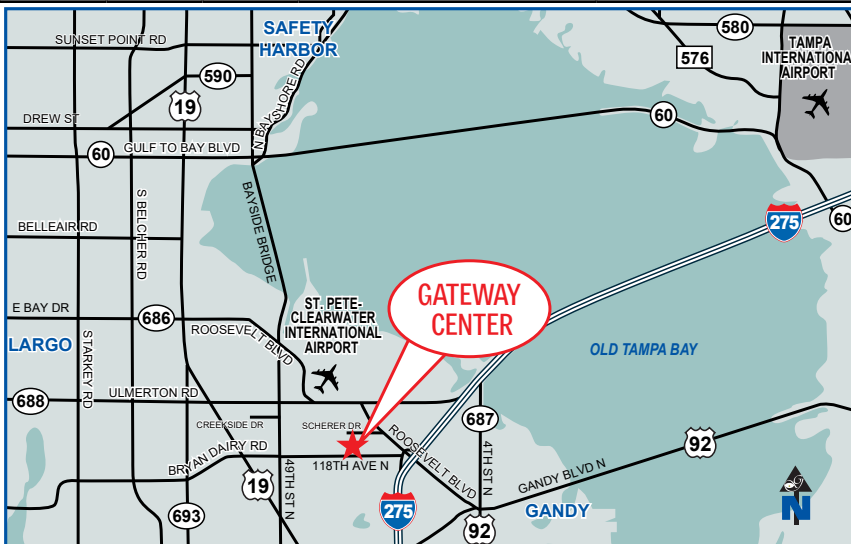

**3320 - 3380 Scherer Drive • St. Petersburg, FL 33716**

SQ. FT.	BLDG.	SUITE	LOADING	OFFICE/WAREHOUSE	CLEAR HEIGHT	LEASE RATE
7,143	3320	B	4 Truck Wells	1,685 Office / 5,458 Warehouse	15' to 19'	\$9.25 NNN
7,418	3360	E	1 Truck Well	2,698 Office / 4,720 Warehouse	15' to 19'	\$9.25 NNN
9,300	3380	D	1 Dock & 2 Grade	4,945 Office / 4,355 Warehouse	15' to 19'	\$9.25 NNN



FOR MORE INFORMATION CONTACT:

**CHRISTINA PETTI**

Cell: 813.245.1246

Email: [christina@ipgcommercialrealty.com](mailto:christina@ipgcommercialrealty.com)

**JOHN AYERS, CCIM**

Cell: 813.690.6539 • Email: [jayers@ccim.net](mailto:jayers@ccim.net)

**Industrial Property Group, Inc.**

Licensed Real Estate Broker

2202 N. Westshore Blvd. • Suite 200 • Tampa, FL 33607

[www.ipgcommercialrealty.com](http://www.ipgcommercialrealty.com)

OWNED AND MANAGED BY:



No warranty or representation, expressed or implied, is made as to the accuracy of the information contained herein, and same is submitted subject to errors, omissions, change of price, rental or other conditions, withdrawal without notice, and to any special listing conditions imposed by our principals.

# Gateway Center Site Plan/Availabilities August 2019

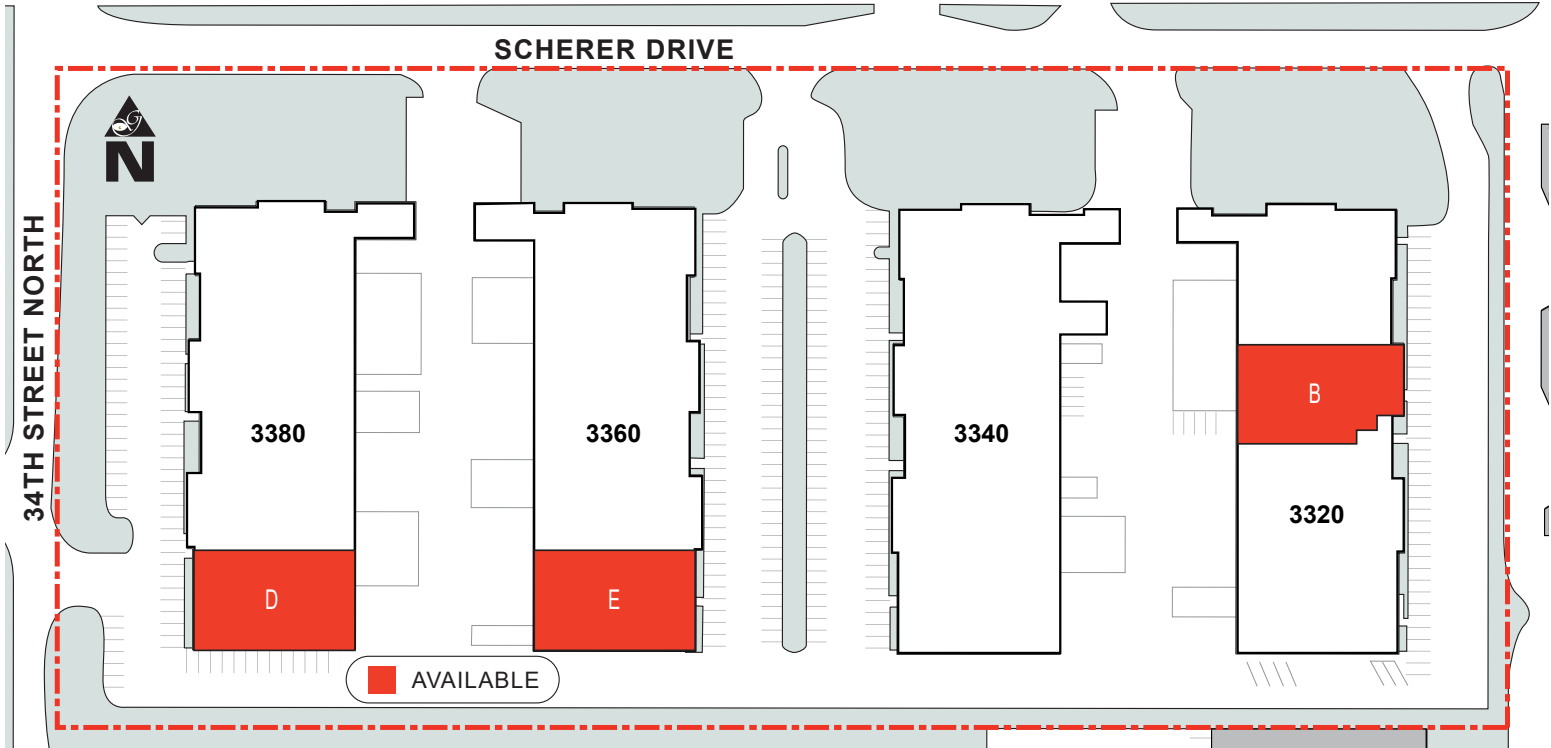

OWNED AND MANAGED BY:



FOR MORE INFORMATION CONTACT:

**CHRISTINA PETTI**

Cell: 813.245.1246

Email: [christina@ipgcommercialrealty.com](mailto:christina@ipgcommercialrealty.com)

**JOHN AYERS, CCIM**

Cell: 813.690.6539 • Email: [jayers@ccim.net](mailto:jayers@ccim.net)

**Industrial Property Group, Inc.**

Licensed Real Estate Broker

2202 N. Westshore Blvd. • Suite 200 • Tampa, FL 33607

[www.ipgcommercialrealty.com](http://www.ipgcommercialrealty.com)



No warranty or representation, expressed or implied, is made as to the accuracy of the information contained herein, and same is submitted subject to errors, omissions, change of price, rental or other conditions, withdrawal without notice, and to any special listing conditions imposed by our principals.