



DRIVE-THRU SITE IN PRIME INGLEWOOD FOR LEASE

3104 W. CENTURY BLVD, INGLEWOOD, CA 90303

1801 Century Park East, Suite 1550
Los Angeles, California 90067
P 310.275.8222 F 310.275.8223
www.cag-re.com
License #01876070

Alex Shabani
Senior Managing Director
Phone: 310.272.7397
Email: alex@cag-re.com
Lic: 01352902

cag | COMMERCIAL
ASSET GROUP



PRIME INGLEWOOD SIGNALIZED INTERSECTION OF CENTURY BLVD & CRENSHAW BLVD

3104 W. CENTURY BLVD, INGLEWOOD, CA 90303

Highlights

- Approximately 2,363 Sq Ft Drive-Thru Restaurant
- Former Burger King Site
- Well Maintained Structure with Excellent Curb Appeal
- Ample Parking & Excellent Street Exposure & Signage
- 1/2-Mile From New Proposed Rams Football Stadium
- Join: Food4Less Factory2U, 99cent Only & More

Area Amenities

- Main & Main Corner
- Signalized Intersection
- Heavy Auto Traffic— CPD 123,000
- .4-Miles to New Football Stadium
- Population: 1 Mile Radius 32,360
- Income: 1 Mile Radius \$63,429
- Neighboring Tenants: Costco, Marshalls, Us Bank, Bed Bath, Target, Home Depot, El Super

ADDITIONAL PHOTOS

3104 W. CENTURY BLVD, INGLEWOOD, CA 90303



MAP

3104 W. CENTURY BLVD, INGLEWOOD, CA 90303

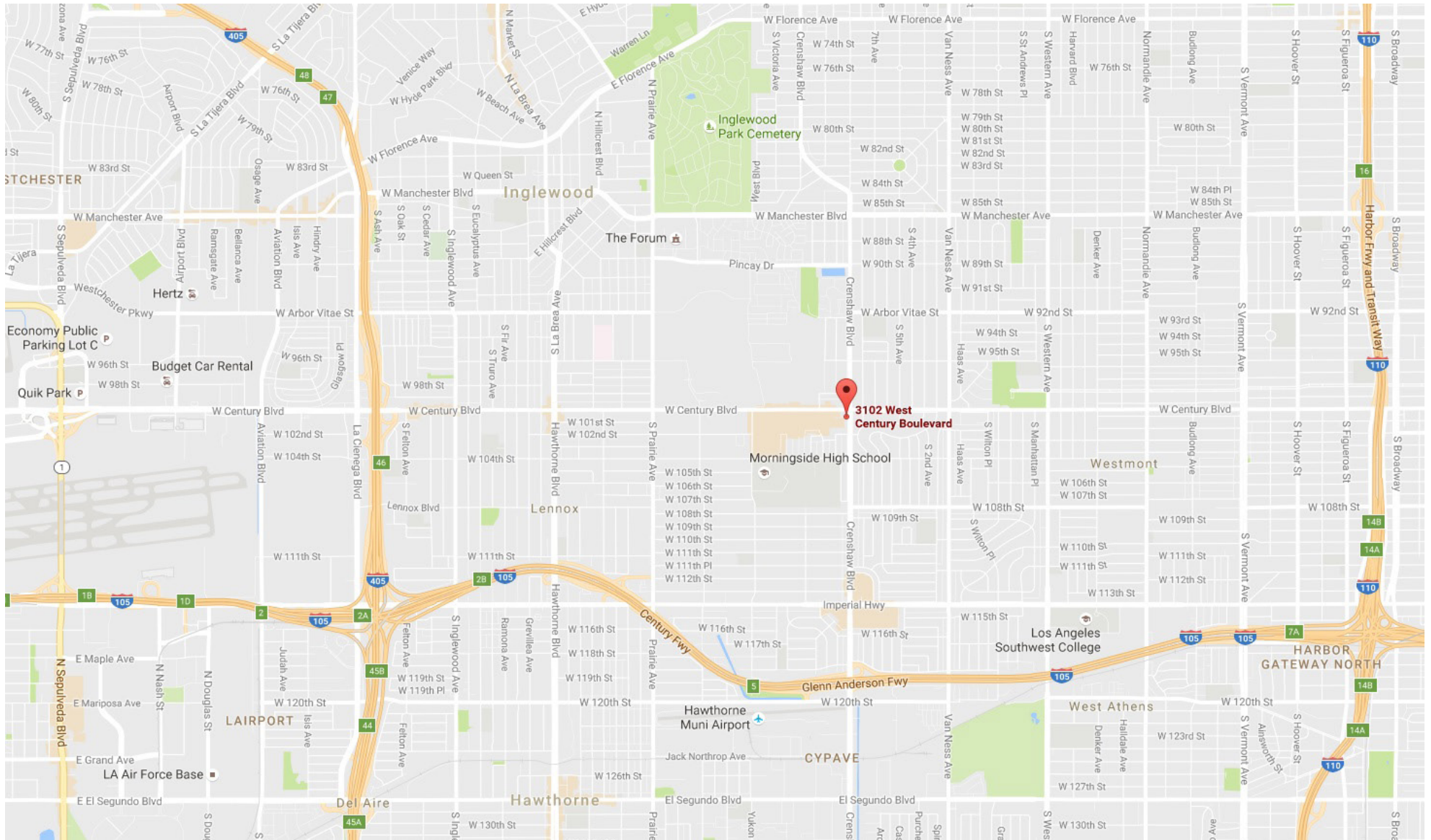

AERIAL

3104 W. CENTURY BLVD, INGLEWOOD, CA 90303

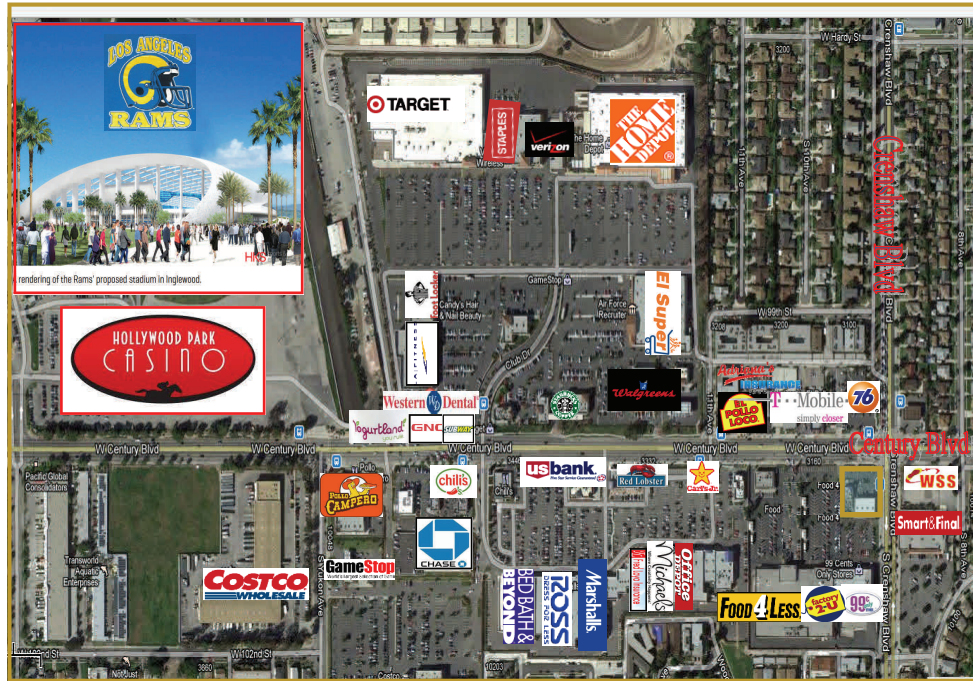
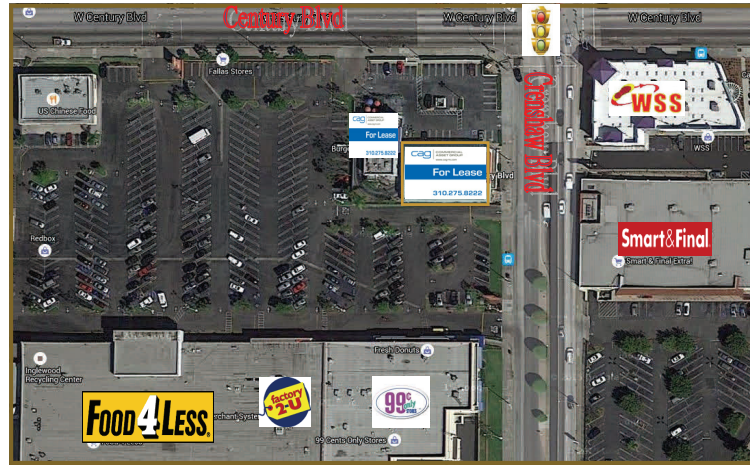

DEMOGRAPHICS

3104 W. CENTURY BLVD, INGLEWOOD, CA 90303

	1 mile(s)	3 mile(s)	5 mile(s)
Population: 2014B			
Total Population	32,360	380,688	905,510
Female Population	53.57%	52.41%	51.88%
Male Population	46.43%	47.59%	48.12%
Population Density	10,299	13,462	11,528
Population Median Age	35.2	32.1	32.4
Employed Civilian Population 16+	13,219	148,221	356,526
% White Collar	57.0%	46.6%	47.7%
% Blue Collar	43.0%	53.4%	52.3%
Total Employees	5,657	81,748	272,624
Total Establishments*	585	8,699	24,715
Population Growth 2000-2010	-1.18%	-0.51%	2.91%
Population Growth 2014B-2019	-0.29%	0.51%	1.10%
Income: 2014B			
Average Household Income	\$63,429	\$51,813	\$58,354
Median Household Income	\$46,856	\$36,851	\$39,523
Per Capita Income	\$20,788	\$16,662	\$18,267
Avg Income Growth 2000-2010	35.52%	33.20%	32.85%
Avg Income Growth 2014B-2019	17.68%	17.74%	17.01%
Households: 2014B			
Households	10,505	121,299	281,348
Average Household Size	3.03	3.09	3.17
Hhld Growth 2000-2010	1.03%	-0.53%	1.10%
Hhld Growth 2014B-2019	0.58%	0.95%	1.22%
Housing Units: 2014B			
Occupied Units	10,505	121,299	281,348
% Occupied Units	98.79%	97.18%	97.03%
% Vacant Housing Units	1.21%	2.82%	2.97%
Owner Occ Housing Growth 2000-2010	4.03%	-3.04%	-0.88%
Owner Occ Housing Growth 2000-2019	6.66%	-1.94%	-0.04%
Owner Occ Housing Growth 2014B-2019	1.32%	0.57%	0.50%
Occ Housing Growth 2000-2010	1.03%	-0.53%	1.10%
Occ Housing Growth 2010-2019	3.90%	4.66%	4.85%
Occ Housing Growth 2014B-2019	0.58%	0.95%	1.22%
Race and Ethnicity: 2014B			
% American Indian or Alaska Native Population	0.49%	0.66%	0.67%
% Asian Population	0.61%	2.18%	4.83%
% Black Population	55.72%	40.21%	32.55%
% Hawaiian or Pacific Islander Population	0.46%	0.42%	0.36%
% Multirace Population	3.81%	4.15%	4.46%
% Other Race Population	22.97%	29.18%	30.03%
% White Population	15.94%	23.19%	27.10%
% Hispanic Population	40.37%	53.40%	54.57%
% Non Hispanic Population	59.63%	46.60%	45.43%

SITE PLAN

3104 W. CENTURY BLVD, INGLEWOOD, CA 90303



Century Blvd

Crenshaw Blvd

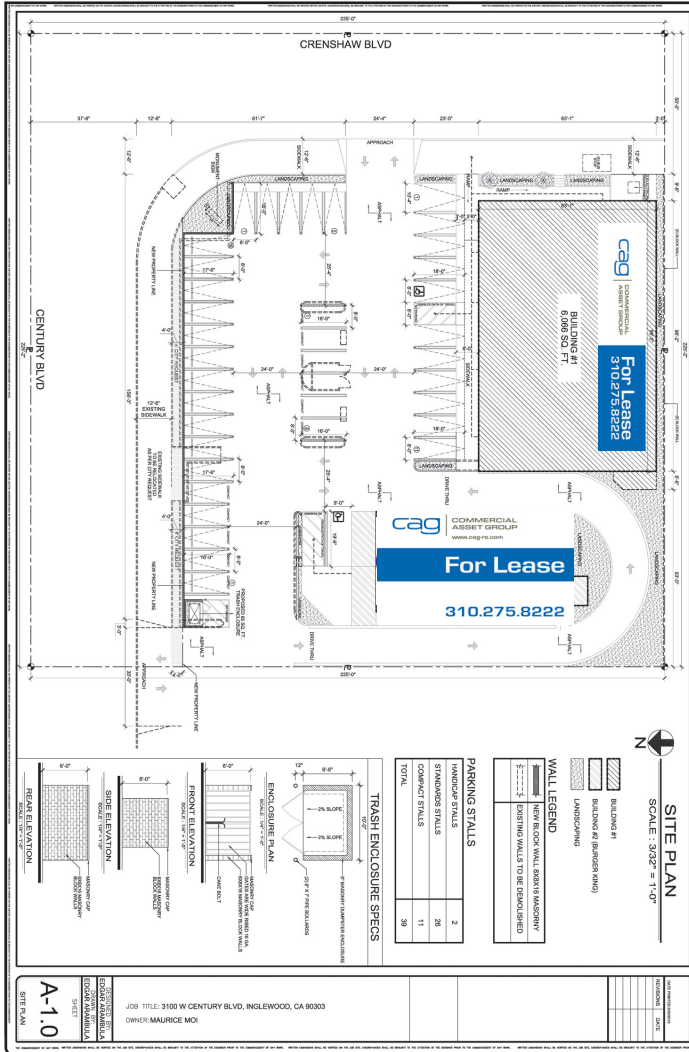



For more information, please call.



1801 Century Park East, Suite 1550
Los Angeles, California 90067
Phone 310.275.8222 Fax 310.275.8223
www.cag-re.com
License #01876070

Alex Shabani
Senior Managing Director
Phone: 310.272.7397
Email: alex@cag-re.com
Lic: 01352902

These materials are based on information and content provided by others, which we believe are accurate. No guarantee, warranty or representation is made by Commercial Asset Group, Inc. or its personnel. All interested parties must independently verify accuracy and completeness. As well, any projections, assumptions, opinion, or estimates are used for example only and do not represent the current or future performance of the identified property. Your tax, financial, legal and toxic substance advisors should conduct a careful investigation of the property and its suitability for your needs, including land use limitations. The property is subject to prior lease, sale, change in price, or withdrawal from the market without notice.