



**AVAILABLE FOR LEASE**



## TAMPA EAST INDUSTRIAL PARK

1421 Massaro Blvd | Tampa, FL 33619

**12,000 SF**



### PROPERTY HIGHLIGHTS

- Available SF: 12,000 Fully A/C Warehouse
- Office SF: +/- 3,000
- Clear Height: 14'
- Loading: 2 Grade Level Doors
- Column Spacing: 40' x 40'
- Electrical: 3 Phase / 240 Volt
- Air Conditioned: 100%

Located within the 2.27 million square foot Tampa East Industrial Park, 1421 Massaro Boulevard has superior access to Interstate-4, Interstate-75, State Road 60 and Highway 301.

The location, just north of the intersection of Highway 301 and SR 60, is at the center of the heaviest concentration of distribution space in the Tampa Bay area, and is recognized as the premier distribution location within the Tampa industrial market.

**JESSICA MIZRAHI**  
Director  
+1 813 204 5323  
Jessica.mizrahi@cushwake.com

One Tampa City Center, Suite 3300  
Tampa, FL 33602  
Main +1 813 223 6300  
cushmanwakefield.com



# TAMPA EAST INDUSTRIAL PARK

1421 Massaro Blvd | Tampa, FL 33619

**12,000 SF**

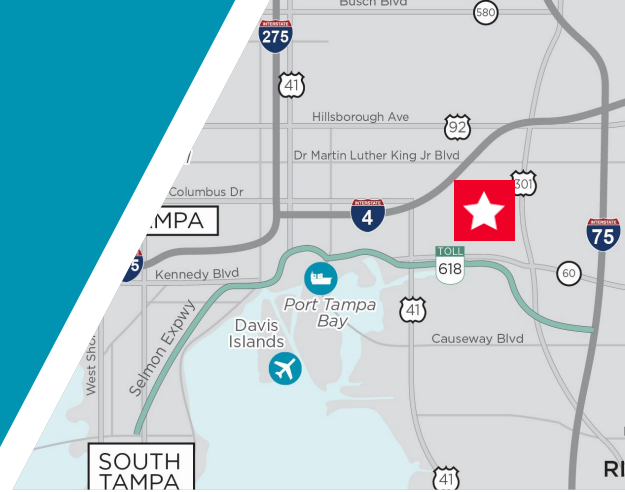

## FLOOR PLAN

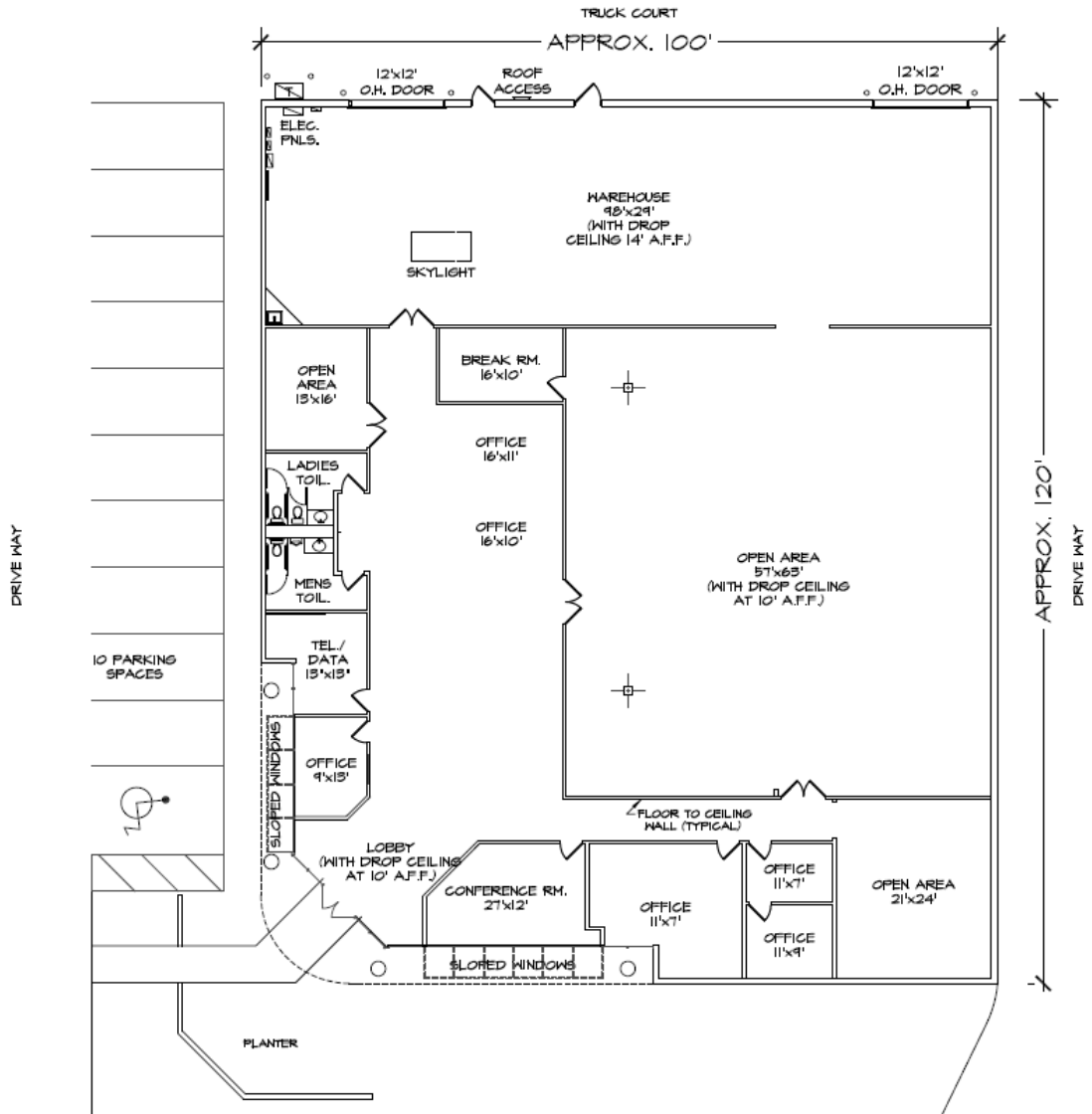

**JESSICA MIZRAHI**  
 Director  
 +1 813 204 5323  
 Jessica.mizrahi@cushwake.com

One Tampa City Center, Suite 3300  
 Tampa, FL 33602  
 Main +1 813 223 6300  
 cushmanwakefield.com