

manhasset, ny

407-411 plandome road

retail/restaurant space in the heart of manhasset | for lease



DEMOGRAPHICS	1 MILE	3 MILES	5 MILES
Population	10,965	101,760	335,344
Median HHI	\$179,514	\$121,952	\$102,360
Daytime Population	11,914	81,446	185,128

Available	1,100 square feet } 2,350 square feet } can be combined
Asking Rent	Upon Request
Area Retail	Rite Aid, Starbucks, Dunkin Donuts, Chase Bank, Wells Fargo, Chocolate Works, and many more
Comments	<ul style="list-style-type: none">• second generation restaurant space• close proximity to the Manhasset LIRR with an annual ridership of over 1.7 million passengers• immediate occupancy• traffic count of 19,000 vehicles per day on Plandome Road• one of Long Island's busiest and most affluent "Main Streets"• clean column free space• 2 designated parking spots per tenant in the rear

For More Information:

William Diakakis | diakakis@sabre.life | T 516 874 8070 x1521

sabre.life



manhasset, ny

407-411 plandome road

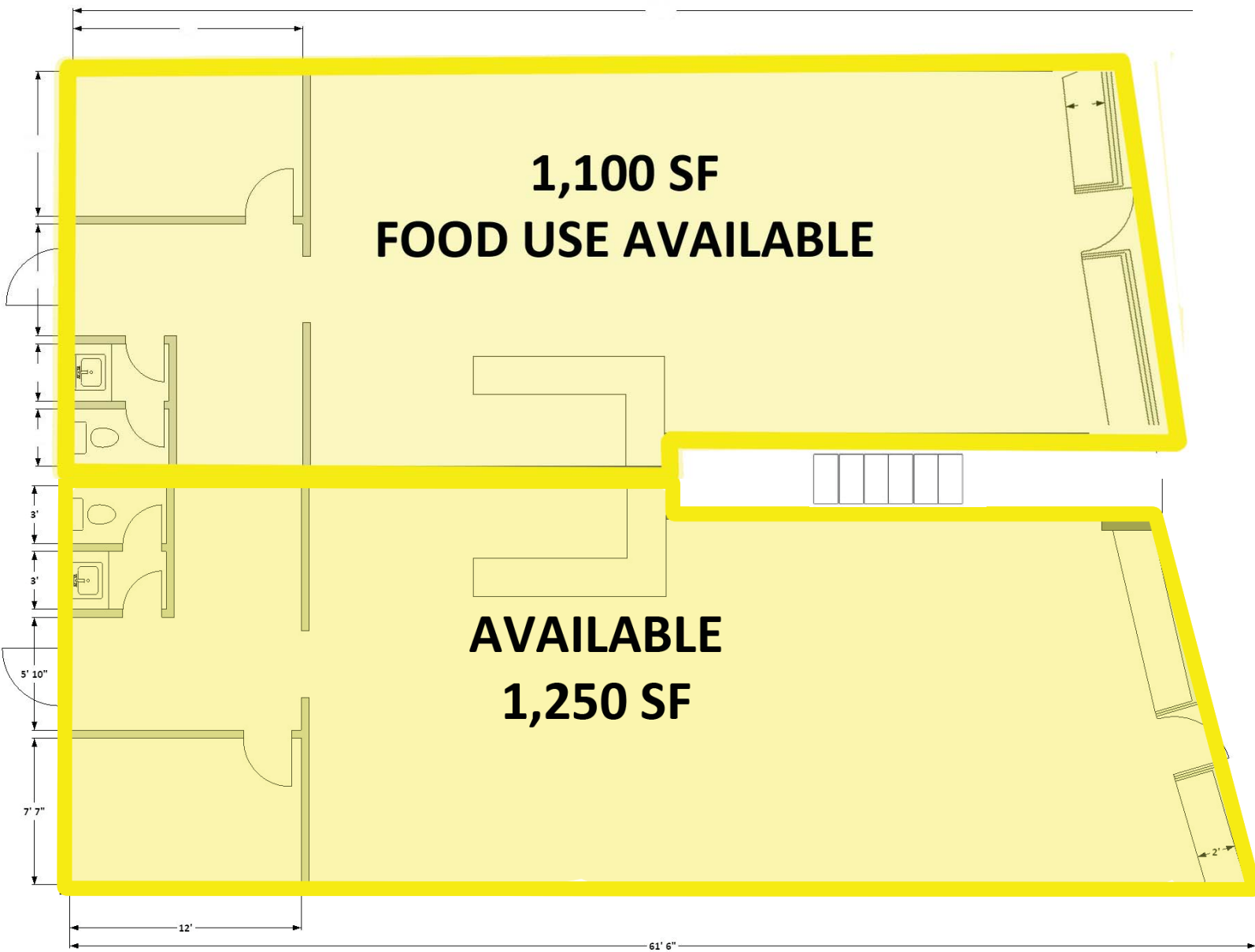

For More Information:

William Diakakis | diakakis@sabre.life | T 516 874 8070 x1521

sabre.life



manhasset, ny

407-411 plandome road

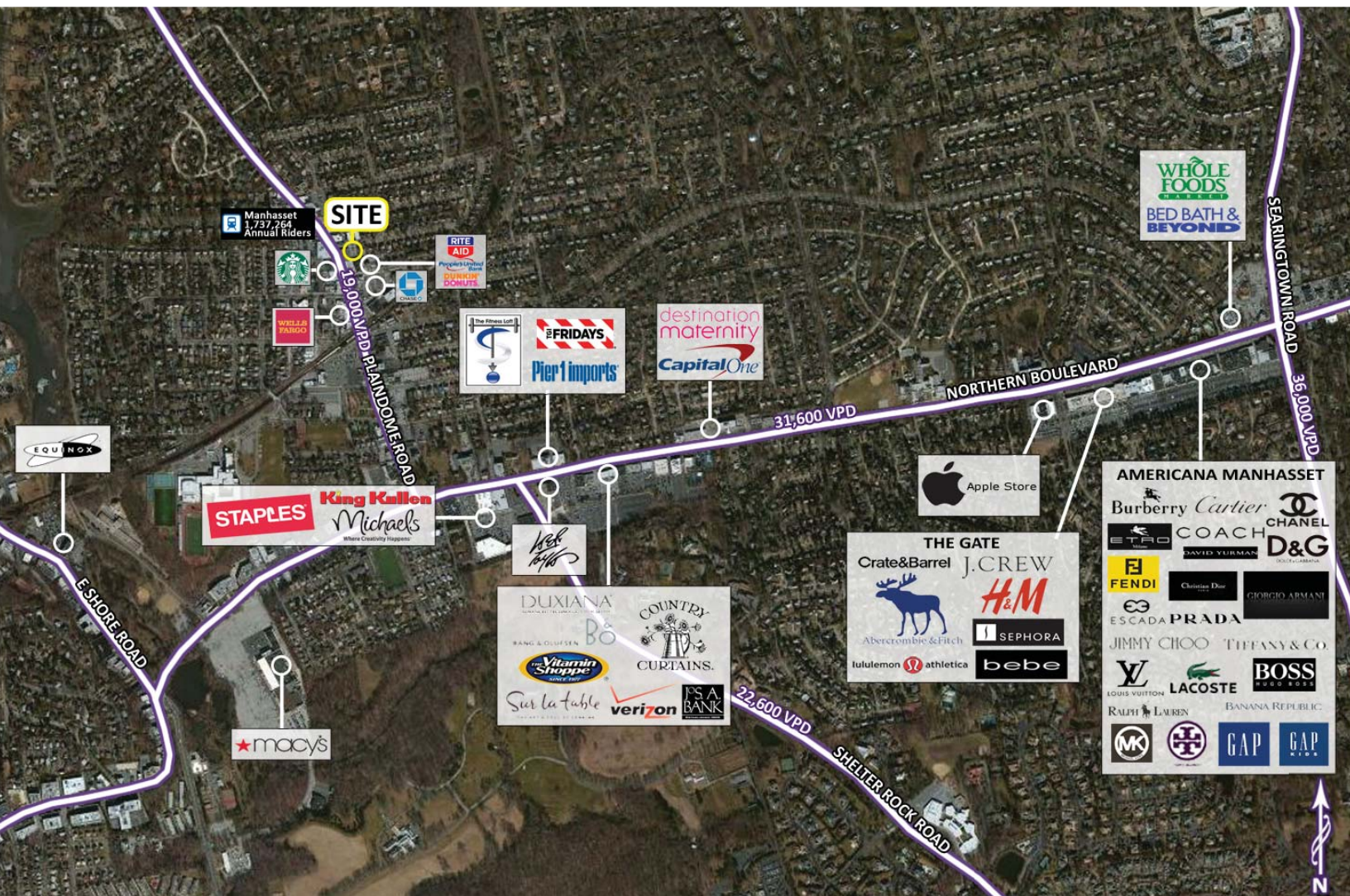

For More Information:

William Diakakis | diakakis@sabre.life | T 516 874 8070 x1521

Sabre Real Estate Group, LLC

500 Old Country Road Garden City NY 11530

500 Route 17 South Hasbrouck Heights NJ 07604

135 Madison Avenue 8th Floor New York NY 10016

sabre.life

© Sabre Real Estate Group, LLC. This information has been obtained from sources believed reliable. We have not verified it and make no guarantee, warranty or representation about it. Any projections, opinions, assumptions or estimates used are for example only and do not represent the current or future performance of the property. You and your advisors should conduct a careful, independent investigation of the property to determine to your satisfaction the suitability of the property for your needs.

SABRE