

700 LA TERRAZA BOULEVARD

# La Terraza

CORPORATE CENTER  
ESCONDIDO, CA 92025

 VIRTUAL  
TOUR

*Office Space For Lease*

**CBRE**

# building features & amenities



## Location

Immediately off the I-15 Freeway  
Walking distance to several restaurants,  
24 Hour Fitness and retail amenities



**Building Size**  
26,975 SF



**Year Built**  
2003



**Lease Rate**  
\$2.50 + E



**Elevator Served**  
One (1)



**Stories**  
Two (2)



**Parking**  
4.00/1,000 SF



**Lot Size**  
3.89 Acres

# floor plan

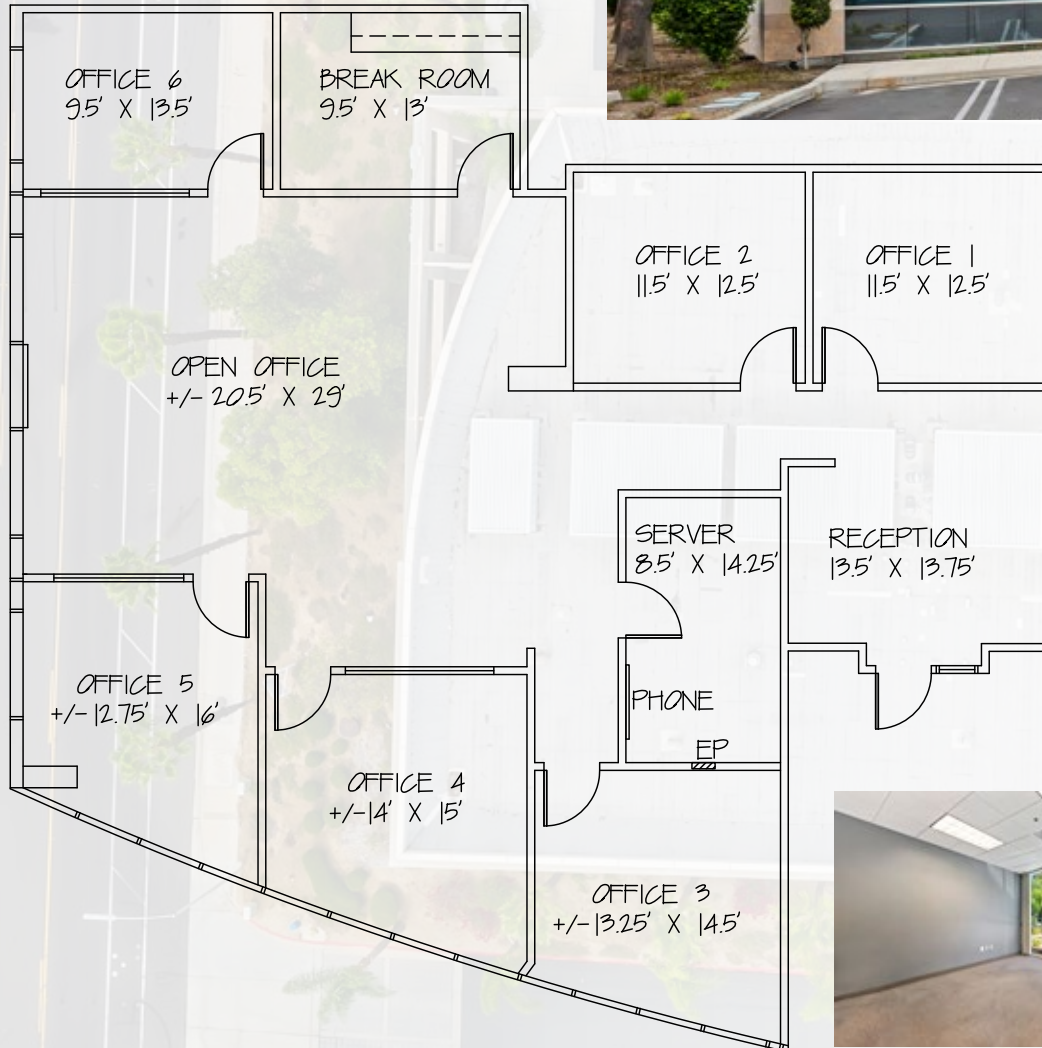

## As-Built Plan

**Suite 110**

**2,675 SF**

Suite Features: Reception area with tile flooring and a built-in reception desk, six (6) private offices, kitchen, storage room with file cabinets and open area with cubicles in place.

 **VIRTUAL  
TOUR**





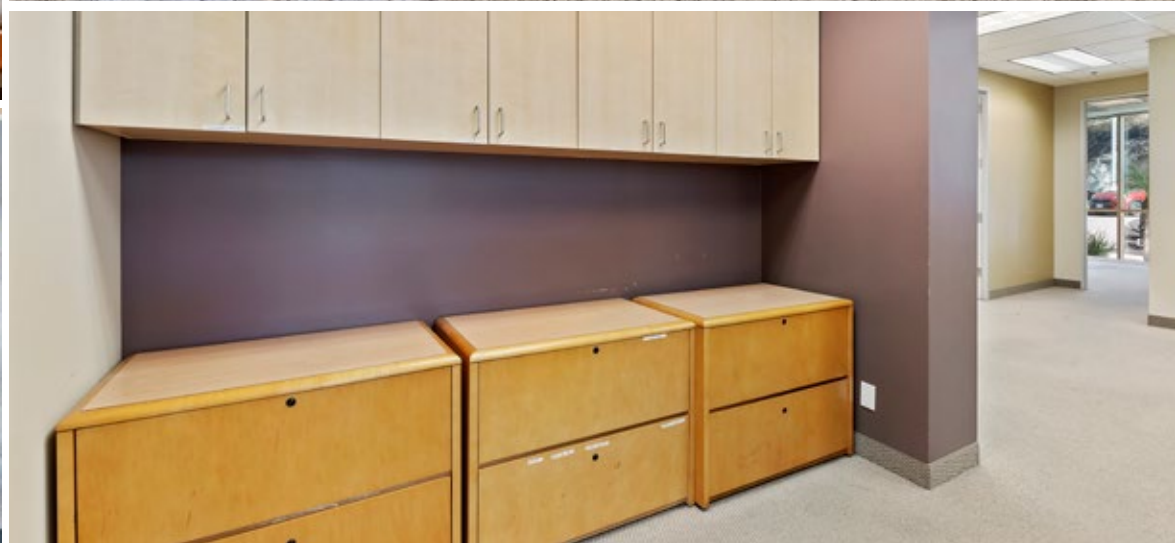

*aerial*

700 LA TERRAZA BOULEVARD

# La Terraza

CORPORATE CENTER

15

La Terraza Blvd



location



**Heading South on I-15**  
Exit W Valley Pkwy Exit  
Turn Left on W Valley Pkwy  
Turn Right on La Terraza Blvd

**Heading North on I-15**  
Exit W 9th Avenue  
Turn Right on W 9th Ave  
Turn Left on La Terraza Blvd

La Terraza

# regional map

700 LA TERRAZA BOULEVARD  
**La Terraza**  
CORPORATE CENTER

1.4 mi to 15/78 Interchange  
30 mi to San Diego  
38 mi to Temecula

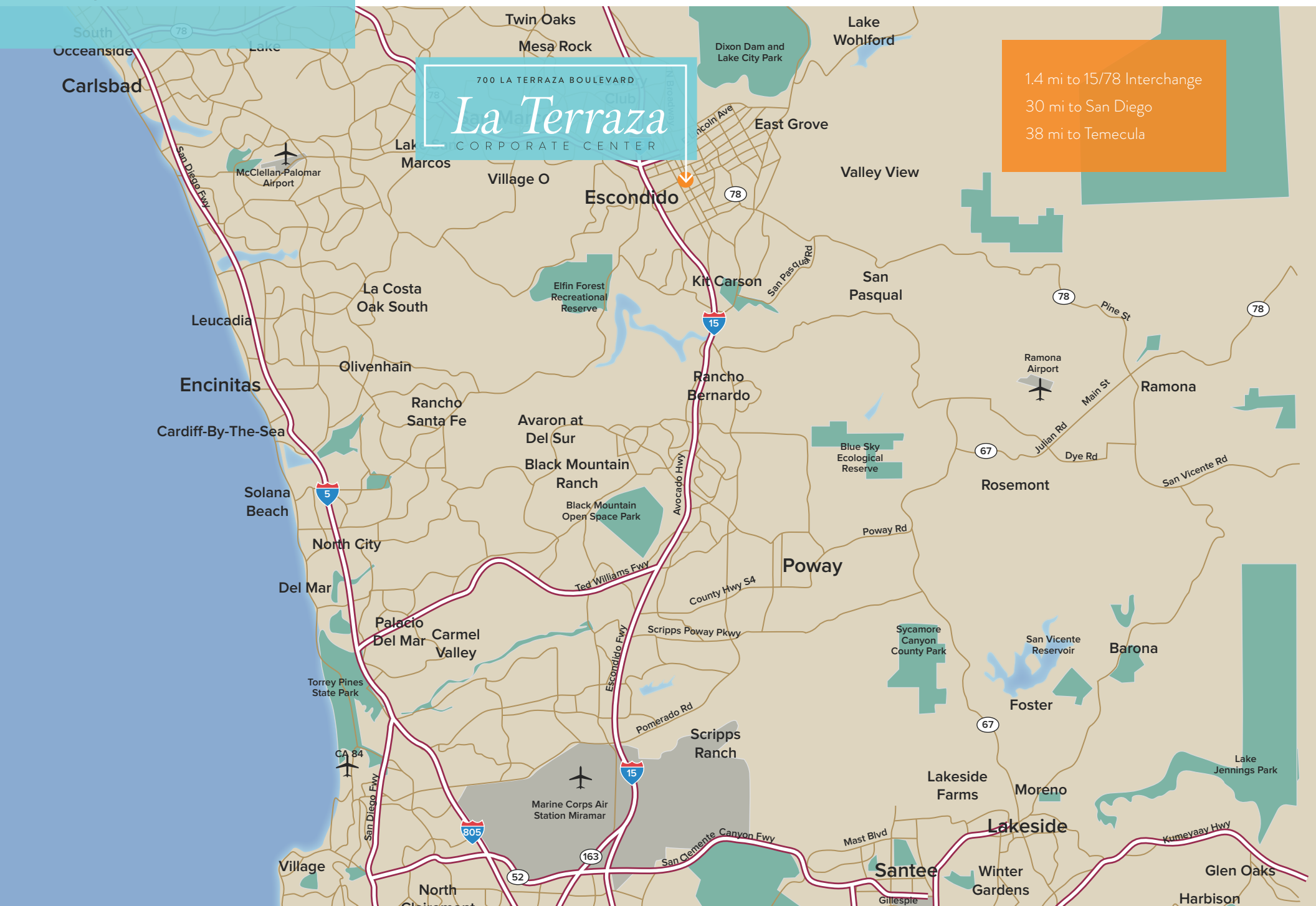



700 LA TERRAZA BOULEVARD

# La Terraza

CORPORATE CENTER

ESCONDIDO, CA 92025



## *Scott Kincaid*

Lic. 01228565

+1 858 546 4691

scott.kincaid@cbre.com

## *Krista Kirksey*

Lic. 01405552

+1 858 546 2620

krista.kirskey@cbre.com

© 2020 CBRE, Inc. All rights reserved. This information has been obtained from sources believed reliable, but has not been verified for accuracy or completeness. You should conduct a careful, independent investigation of the property and verify all information. Any reliance on this information is solely at your own risk.

**CBRE**