



Eden Prairie, MN 55344

## Freestanding Building Restaurant Space For Lease In Eden Prairie

### Space Available:

- Suite 6411: 5,470 sf (available restaurant space)
- 2024 CAM: \$2.75 psf and Tax: \$3.07 psf
- Lease Rates: \$25.00 psf Net

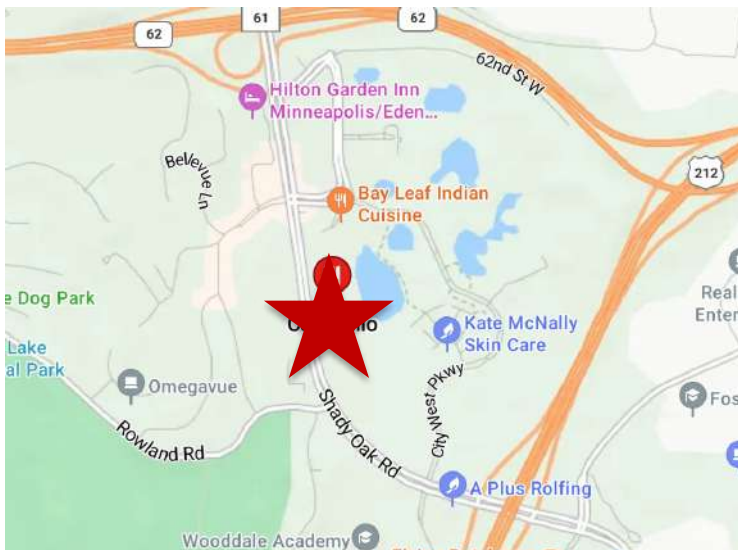

### Highlights and Features:

- Freestanding Building
- Current restaurant space
- Very visible neighborhood center
- Located on Shady Oak Road and City West Parkway
- Immediate access to Highway 62, Highway 212 and I-494
- United Health 1.5 million-square-foot campus across the street housing approximately 6,500 workers
- Shady Oak co-tenants include Bay Leaf Indian Cuisine, City West Fan Man, TC Running World, Jimmy John's, Advance Services, Haven Asian Eatery, and Stretch Labs

### Demographics and Traffic Counts:

- Average Population: 1 mile - 2,949, 3 miles - 60,443, and 5 miles - 199,106
- Average Household Income: 1 mile - \$129,721, 3 miles - \$131,756, and 5 miles - \$137,021
- Traffic Counts: Shady Oak Road North - 15,900 vpd, South - 14,800 vpd, Hwy 62 West - 29,000 vpd and Hwy 62 East - 31,000 vpd



**Christianson & Company**  
COMMERCIAL REAL ESTATE SERVICES  
[www.SpaceAvailableMN.com](http://www.SpaceAvailableMN.com)

**CORFAC**  
INTERNATIONAL

**LAURA GILL**  
612.310.5399

[laura@christiansonandco.com](mailto:laura@christiansonandco.com)

**LISA CHRISTIANSON**  
952.393.1212

[lisa@christiansonandco.com](mailto:lisa@christiansonandco.com)

This information is accurate as of the date of printing and is subject to change without notice. All information is deemed accurate, but cannot be guaranteed.

[www.SpaceAvailableMN.com](http://www.SpaceAvailableMN.com)

Giving developers, business owners and commercial real estate investors the gifts of experience and personal attention.



# Space Plan

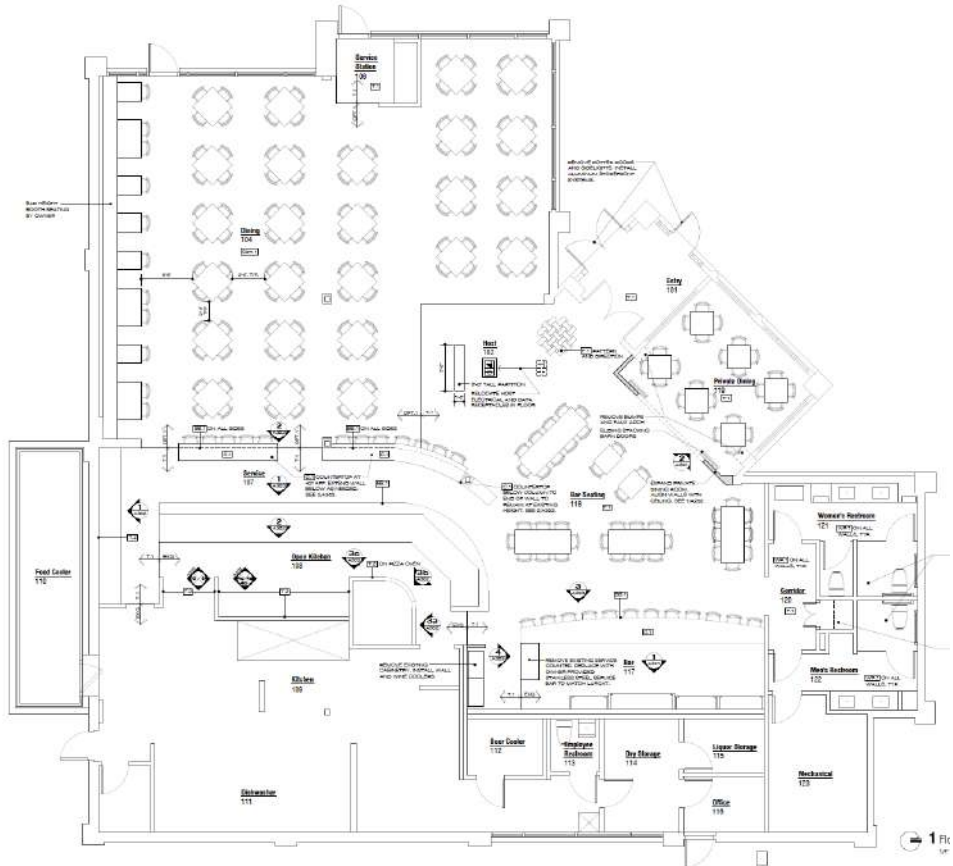

Aerial



This information is accurate as of the date of printing and is subject to change without notice. All information is deemed accurate, but cannot be guaranteed.