

FOR LEASE: 7,215 SQUARE FEET
4807-4811 NORMA STREET, DALLAS, TX 75247

INDUSTRIAL REAL ESTATE BROKERAGE

WWW.MERCER-COMPANY.COM

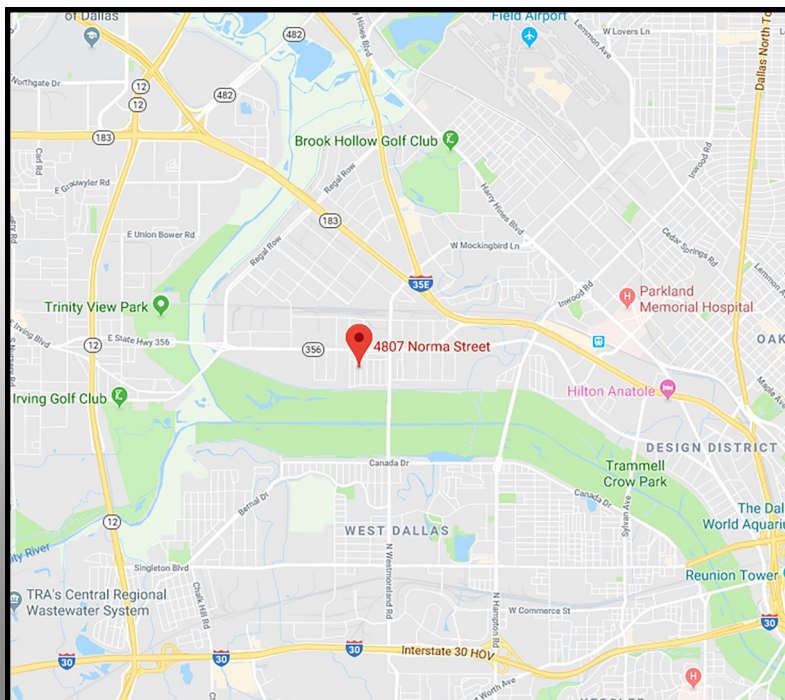

DETAILS

AVAILABLE FOR LEASE

- ◆ TOTAL SF: 7,215
- ◆ OFFICE SF: BTS
- ◆ CLEAR HEIGHT: 14' - 16'
- ◆ GRADE LEVEL DOORS: 3
- ◆ HEAVY POWER
- ◆ AVAILABLE SUITES: 2,235 SF | 2,745 SF | 4,980 SF
- ◆ YEAR OF CONSTRUCTION: 2018

JEREMY MERCER
CELL 214.682.3447
JEREMY@MERCER-COMPANY.COM

TURNER PETERSEN
CELL 214.906.4220
TPETERSEN@MERCER-COMPANY.COM

FOR LEASE: 7,215 SQUARE FEET

4807-4811 NORMA STREET, DALLAS, TX 75247

INDUSTRIAL REAL ESTATE BROKERAGE

WWW.MERCER-COMPANY.COM

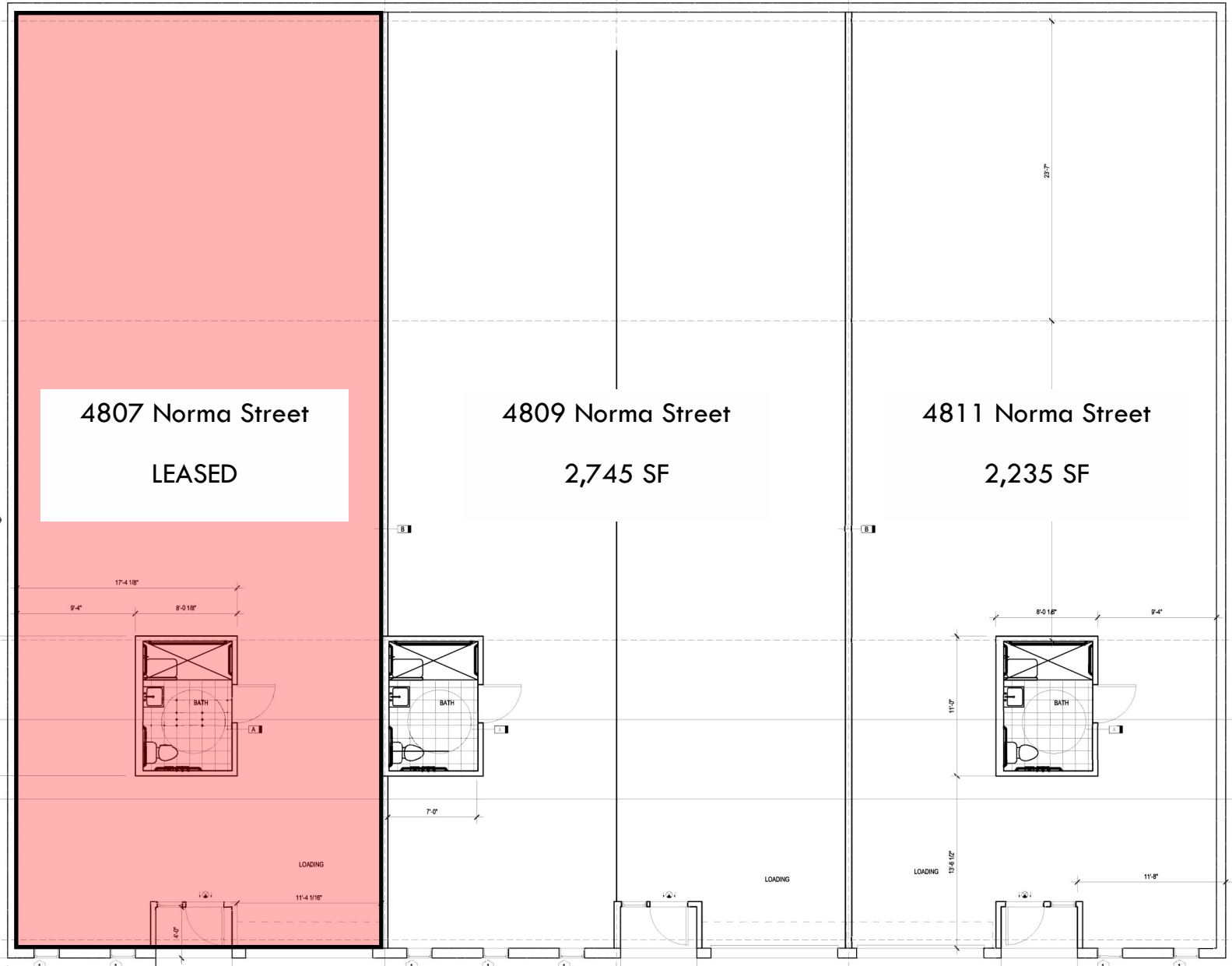
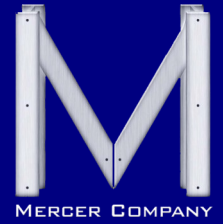

The information contained herein has been given to us by the owner of the property or other sources we deem reliable. We have no reason to doubt its accuracy, but we do not guarantee it. All information should be verified before purchase or lease.