

#105 14,641 S.F.

#100 2,471 S.F.

#120 3,755 S.F.

#125 16,147 S.F.

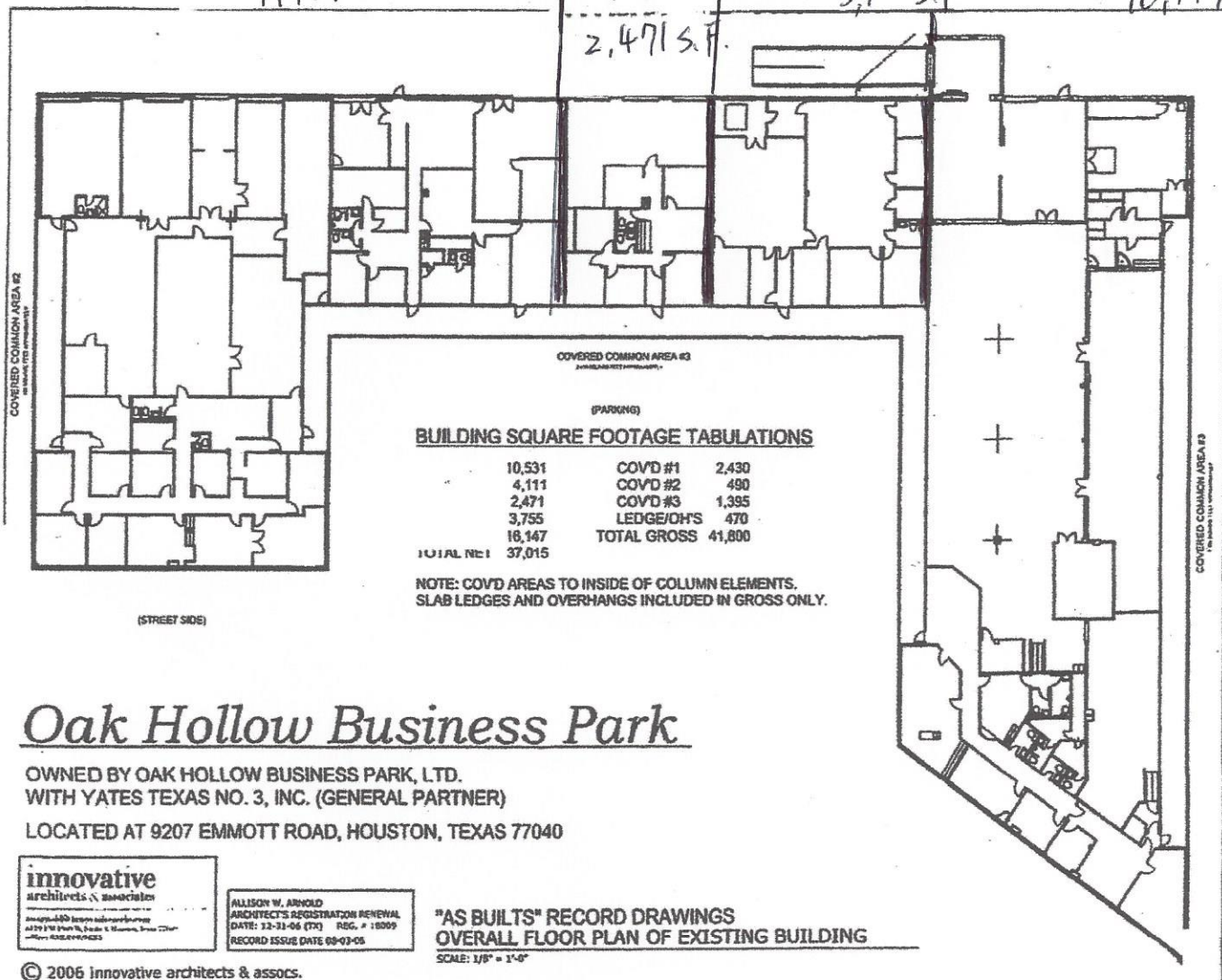

COVERED COMMON AREA #3  
(PARKING)

**BUILDING SQUARE FOOTAGE TABULATIONS**

10,531	COVD #1	2,430
4,111	COVD #2	490
2,471	COVD #3	1,395
3,755	LEDGE/OH'S	470
16,147	TOTAL GROSS	41,800
TOTAL NET		37,015

NOTE: COVD AREAS TO INSIDE OF COLUMN ELEMENTS.  
SLAB LEDGES AND OVERHANGS INCLUDED IN GROSS ONLY.

## Oak Hollow Business Park

OWNED BY OAK HOLLOW BUSINESS PARK, LTD.  
WITH YATES TEXAS NO. 3, INC. (GENERAL PARTNER)  
LOCATED AT 9207 EMMOTT ROAD, HOUSTON, TEXAS 77040

**innovative**  
architects & associates  
2004-2005 LEED Accredited Firm  
4375 West Loop South, Suite 1000, Houston, Texas 77027  
www.innovativearch.com

ALLISON W. ARNOLD  
ARCHITECT'S REGISTRATION RENEWAL  
DATE: 12-31-06 (TX) REG. # 18009  
RECORD ISSUE DATE 08-07-05

"AS BUILT" RECORD DRAWINGS  
OVERALL FLOOR PLAN OF EXISTING BUILDING  
SCALE: 1/8" = 1'-0"

© 2006 innovative architects & assoc.