



±1,300 SF OFFICE SPACE FOR LEASE

3131 S. BASCOM AVENUE
CAMPBELL, CA

ALEX LAGEMANN | LIC #02024474
alex.lagemann@cushwake.com
(408) 221-2310

CLARK STEELE | LIC #01995379
clark.steele@cushwake.com
(408) 436-3653

ERIK HALLGRIMSON | LIC #01274540
erik.hallgrimson@cushwake.com
(408) 615-3435



BUILDING HIGHLIGHTS

- ±10,272 SF Multi-Tenant Office/Medical Building
- Walking-distance to restaurants & retail
- Quick drives to The Pruneyard, Santana Row, Downtown San Jose, & Los Gatos
- Excellent access to Hwy 17, Hwy 85, & Hwy 280
- Monument signage available
- Covered & Uncovered 3.6/1,000 Parking

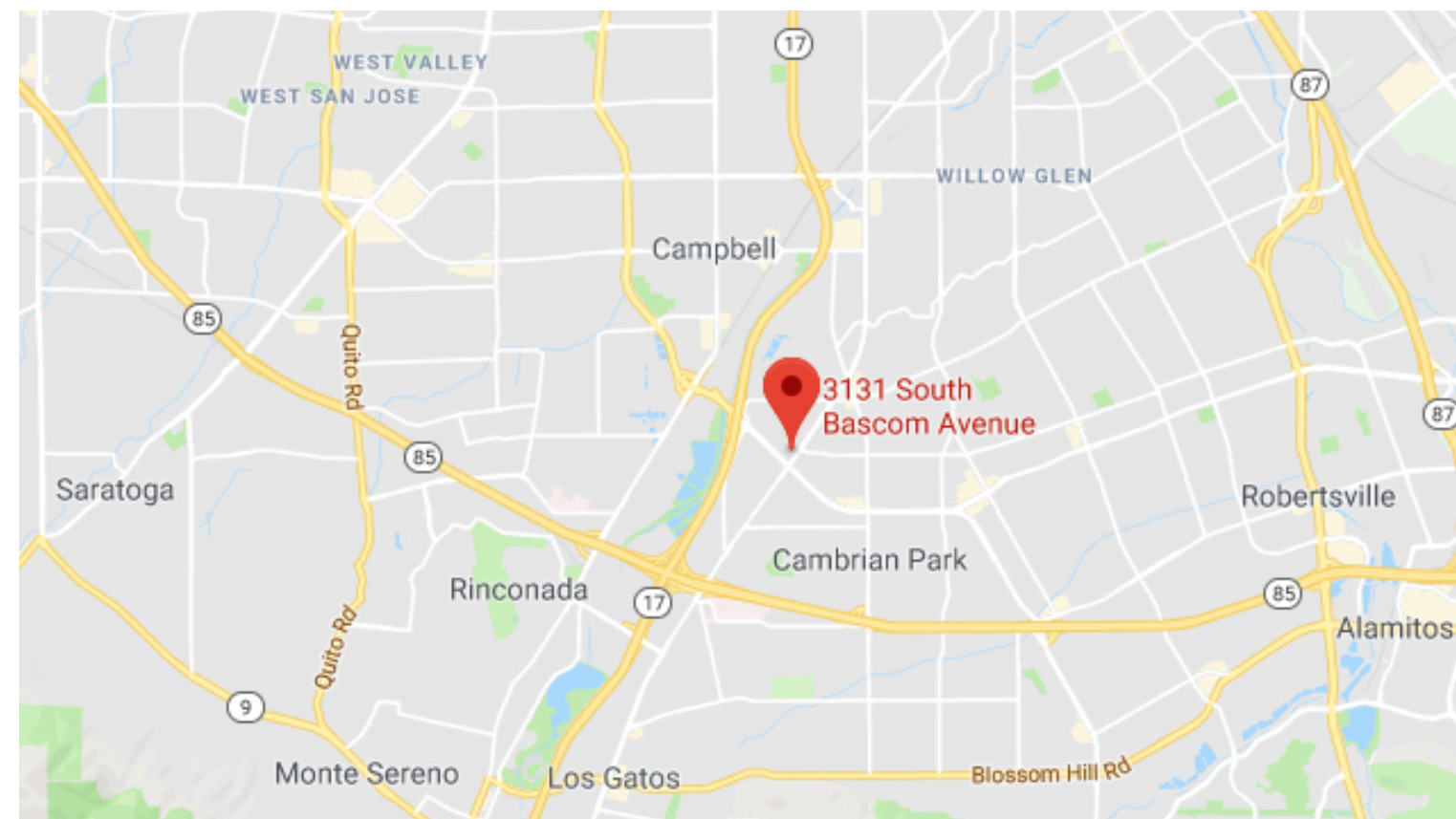

3131 S. BASCOM AVENUE, CAMPBELL, CA

AVAILABILITIES

SUITE	SIZE	AVAILABLE	COMMENTS
150	± 1,300 SF	Now	4 Offices, 1 Conference Room, Open Office, Break Area, Kitchenette



SUITE 150

±1,300 SF

*AVAILABLE NOW

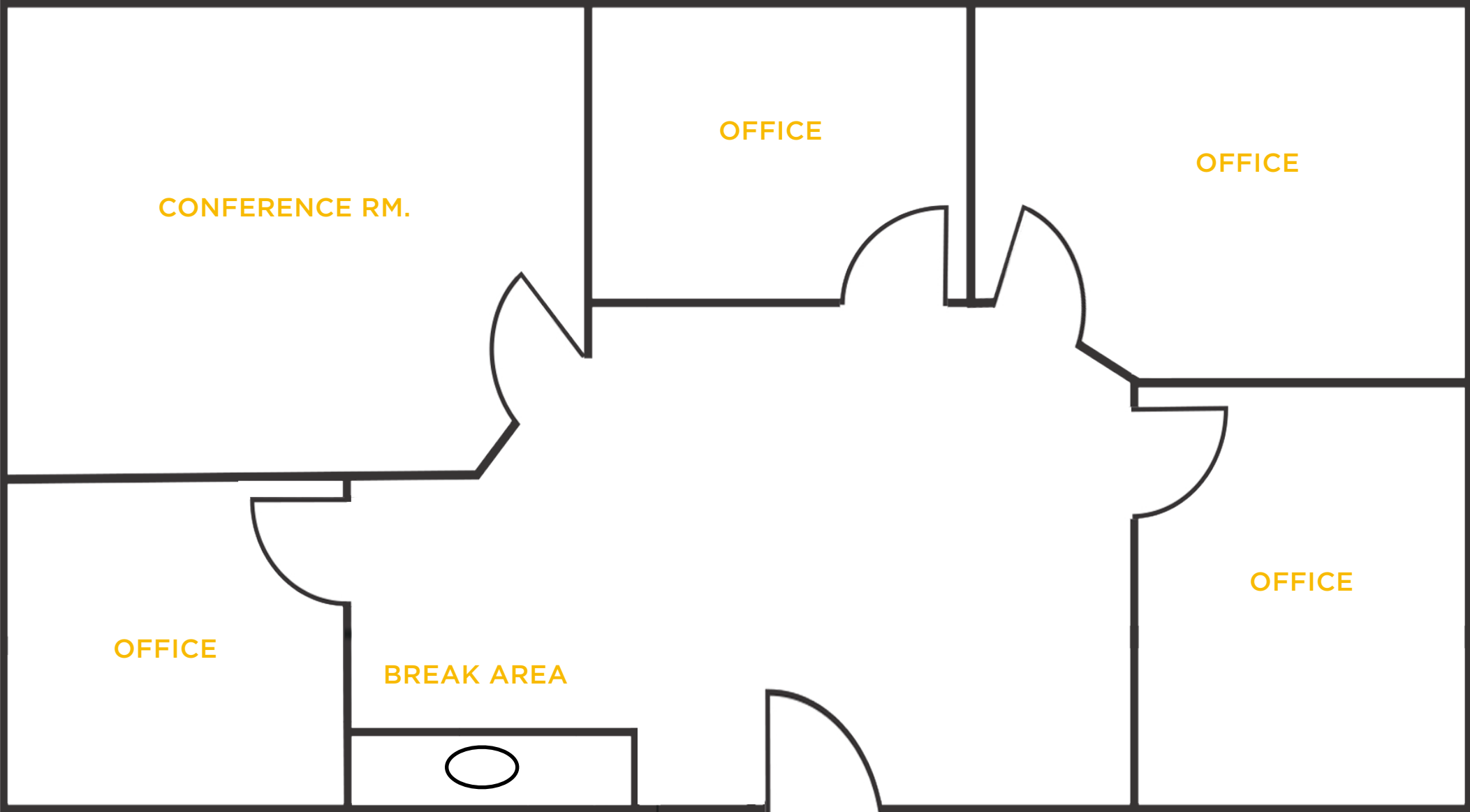



FOR MORE INFORMATION, PLEASE CONTACT:

ALEX LAGEMANN
(408) 221-2310
alex.lagemann@cushwake.com
LIC #02024474

CLARK STEELE
(408) 436-3653
clark.steele@cushwake.com
LIC #01995379

ERIK HALLGRIMSON
(408) 615-3435
erik.hallgrimson@cushwake.com
LIC #01274540



Cushman & Wakefield Copyright 2019. No warranty or representation, express or implied, is made to the accuracy or completeness of the information contained herein, and same is submitted subject to errors, omissions, change of price, rental or other conditions, withdrawal without notice, and to any special listing conditions imposed by the property owner(s). As applicable, we make no representation as to the condition of the property (or properties) in question.