

FOR LEASE

1055 FEATHERSTONE ROAD ROCKFORD, ILLINOIS



PROPERTY FEATURES

- + Up to 9,023 SF available
- + Attractive building in Rockford's prime office park.
- + Great for training/classroom, medical or general office uses.
- + Plentiful parking
- + Monument signage
- + Attractive landscaping
- + Easy access to E. State Street and I-90.
- + Close proximity to hotels, restaurants and the Chicago Rockford International Airport
- + Lease rate: negotiable



LOCATION MAP

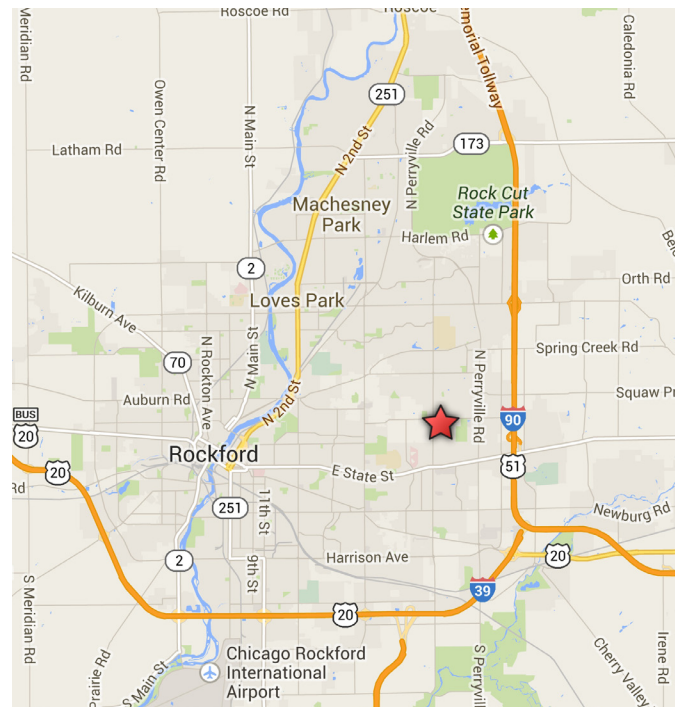

CONTACT

KAREN WALSH, CCIM

First Vice President
+1 815 218 3438
karen.walsh@cbre.com

www.cbre.com/karen.walsh

CBRE

FOR LEASE

1055 FEATHERSTONE ROAD, ROCKFORD, IL



FLOOR PLAN

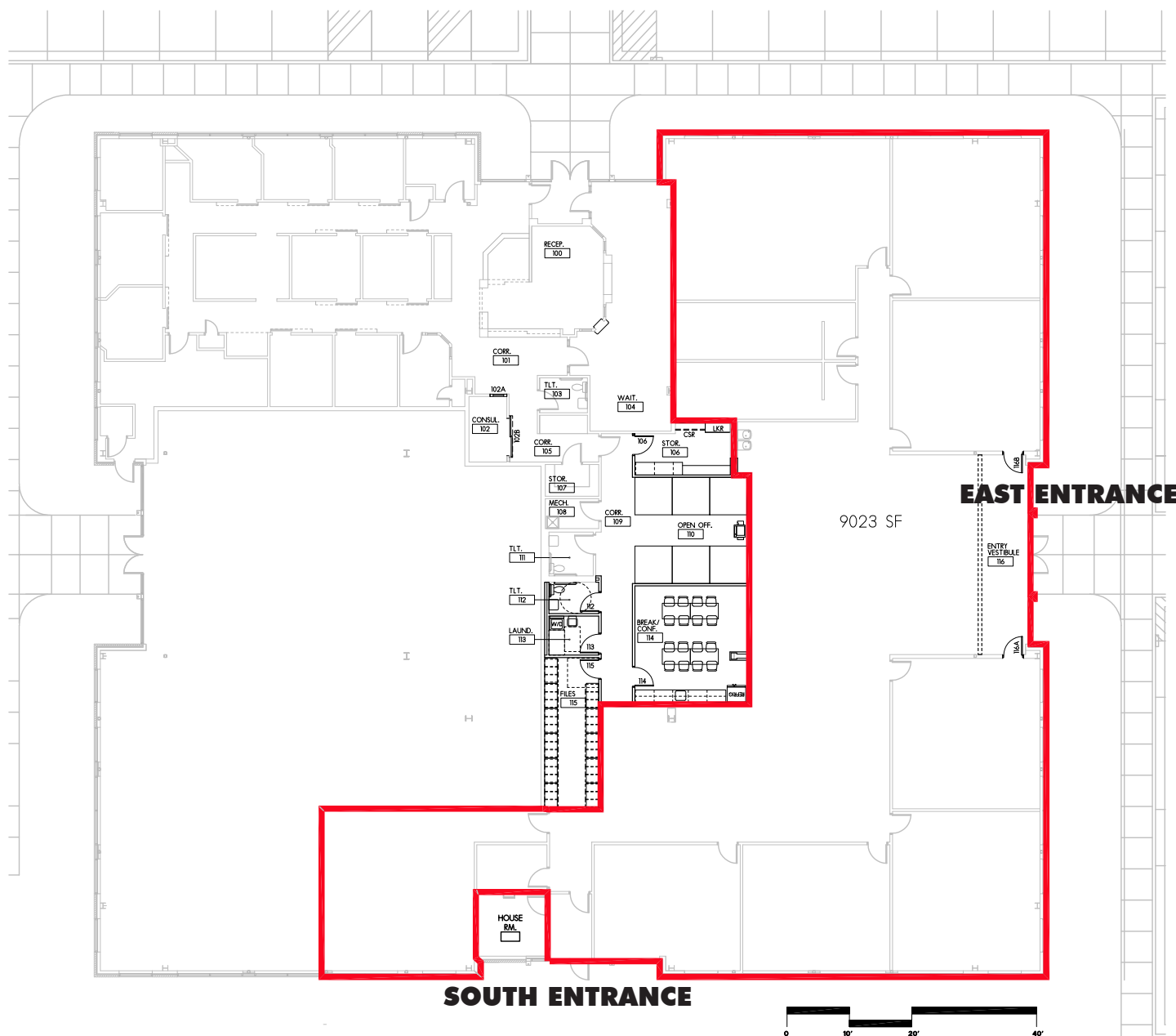

© 2019 CBRE, Inc. The information contained in this document has been obtained from sources believed reliable. While CBRE, Inc. does not doubt its accuracy, CBRE, Inc. has not verified it and makes no guarantee, warranty or representation about it. It is your responsibility to independently confirm its accuracy and completeness. Any projections, opinions, assumptions or estimates used are for example only and do not represent the current or future performance of the property. The value of this transaction to you depends on tax and other factors which should be evaluated by your tax, financial and legal advisors. You and your advisors should conduct a careful, independent investigation of the property to determine to your satisfaction the suitability of the property for your needs. Photos herein are the property of their respective owners and use of these images without the express written consent of the owner is prohibited. CBRE and the CBRE logo are service marks of CBRE, Inc. and/or its affiliated or related companies in the United States and other countries. All other marks displayed on this document are the property of their respective owners.

FOR LEASE

1055 FEATHERSTONE ROAD, ROCKFORD, IL



PHOTOS



www.cbre.com/karen.walsh

CBRE

FOR LEASE

1055 FEATHERSTONE ROAD, ROCKFORD, IL



AERIAL

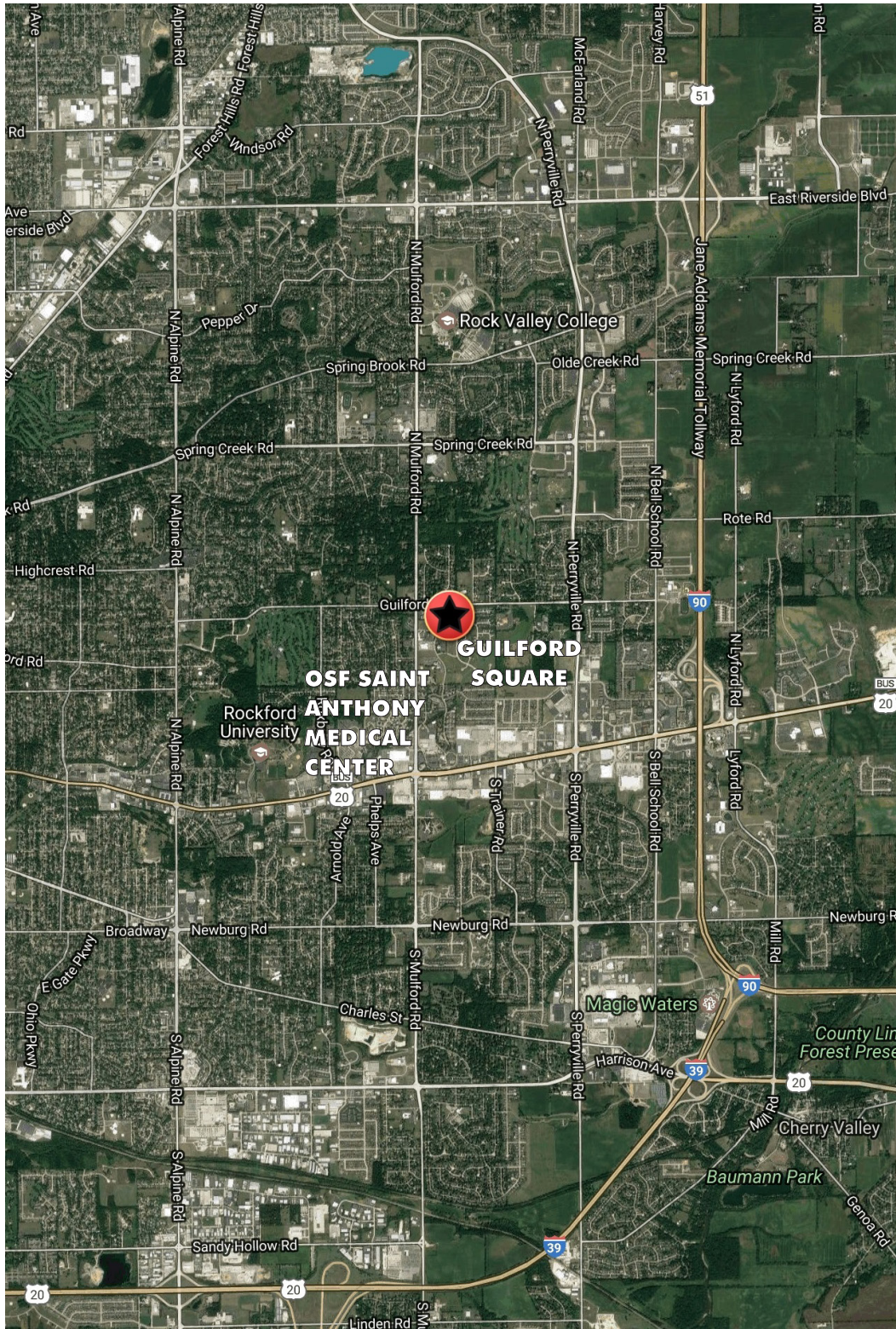

www.cbre.com/karen.walsh

CBRE