

FOR SUBLEASE

# Medical Space Sublease - Lake City

3050 NE 127TH STREET | SEATTLE 98125

RETAIL

PRIME LOCATION ON LAKE CITY WAY!



## PROPERTY HIGHLIGHTS

- + 3,590 SF
- + \$25 PSF + NNN
- + High visibility end cap, adjacent to Chipotle
- + Center anchored by Grocery Outlet, ACE Hardware, and O'Reilly Auto Parts
- + Monument signage
- + Abundant surface parking
- + Traffic count 38,148 VPD on Lake City Way NE\*
- + Currently built-out for medical use (former Immediate Clinic)
- + Sublease through 8/31/23 - longer term is possible

\*(Source: CoStar 2018)

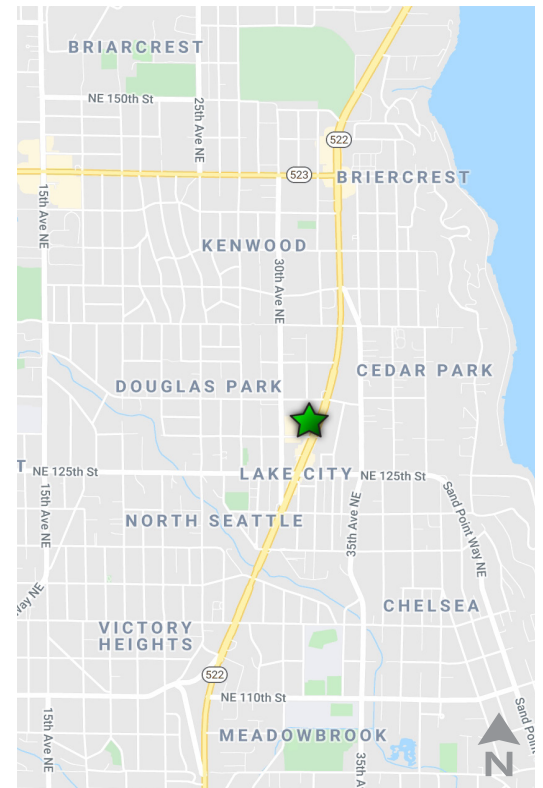

## Key Demographics

	1 Mile	3 Miles
2019 Households - Current Year Estimate	10,876	64,322
2019 Population - Current Year Estimate	23,877	146,927
2019 Average Household Income	\$101,776	\$120,499

Source: ERSI

3050 NE 127TH STREET, SEATTLE, WA 98125

[www.cbre.us/seattle](http://www.cbre.us/seattle)





FOR SUBLEASE

# Medical Space Sublease - Lake City

3050 NE 127TH STREET | SEATTLE 98125

RETAIL



\*VPD Source: CoStar 2018

FOR SUBLEASE

# Medical Space Sublease - Lake City

3050 NE 127TH STREET | SEATTLE 98125

RETAIL

## FLOOR PLAN

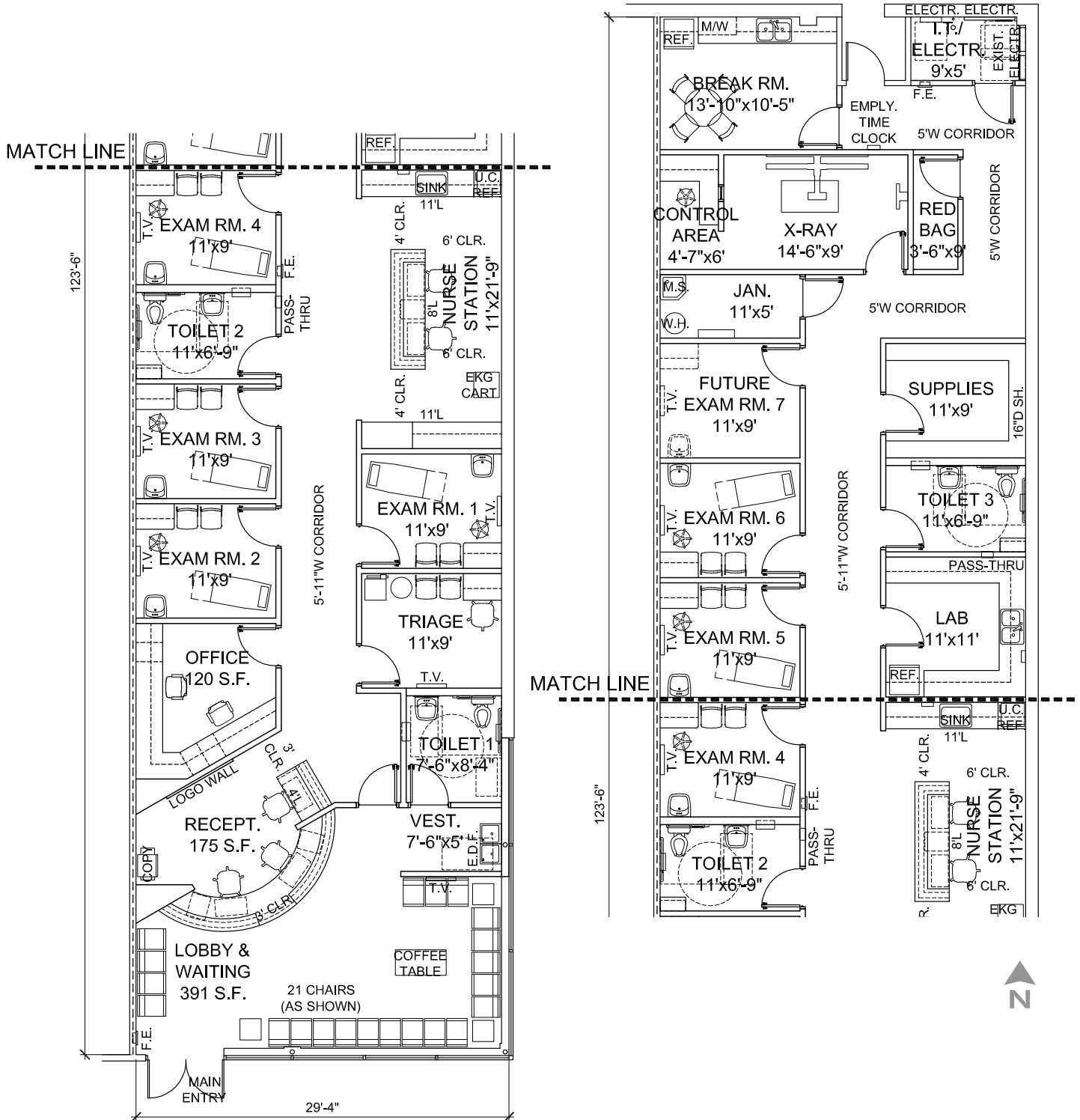

FOR SUBLEASE

# Medical Space Sublease - Lake City

3050 NE 127TH STREET | SEATTLE 98125

RETAIL

## DEMOGRAPHICS

	1 Mile	3 Mile
<b>Population</b>		
2019 Population - Current Year Estimate	23,877	146,927
2024 Population - Five Year Projection	25,437	155,728
2010 Population - Census	21,345	132,536
2000 Population - Census	20,064	127,455
2010-2019 Annual Population Growth Rate	1.22%	1.12%
2018-2024 Annual Population Growth Rate	1.27%	1.17%
<b>Households</b>		
2019 Households - Current Year Estimate	10,876	64,322
2024 Households - Five Year Projection	11,566	97,975
2010 Households - Census	9,747	58,428
2000 Households - Census	8,900	55,529
2010-2019 Annual Household Growth Rate	1.19%	1.04%
2019-2024 Annual Household Growth Rate	1.24%	1.11%
2019 Average Household Size	2.18	2.25
<b>Household Income</b>		
2019 Average Household Income	\$101,776	\$120,499
2024 Average Household Income	\$120,175	\$140,090
2019 Median Household Income	\$73,861	\$86,894
2024 Median Household Income	\$86,508	\$103,547
2019 Per Capita Income	\$46,474	\$52,759
2024 Per Capita Income	\$54,769	\$61,151

Source: ERSI

## CONTACT US

### Dan McGinnis

First Vice President  
+1 206 292 6092  
dan.mcginis@cbre.com

### Gretchen Hamm

Senior Associate  
+1 206 292 6166  
gretchen.hamm@cbre.com

### CBRE, Inc.

1420 5th Avenue  
Suite 1700  
Seattle, WA 98101

© 2019 CBRE, Inc. All rights reserved. This information has been obtained from sources believed reliable, but has not been verified for accuracy or completeness. You should conduct a careful, independent investigation of the property and verify all information. Any reliance on this information is solely at your own risk. CBRE and the CBRE logo are service marks of CBRE, Inc. All other marks displayed on this document are the property of their respective owners, and the use of such logos does not imply any affiliation with or endorsement of CBRE. Photos herein are the property of their respective owners. Use of these images without the express written consent of the owner is prohibited. 12220hp