

FOR SUBLEASE

The Pettygrove Building

1400 NW 22nd Avenue / Portland, OR 97210



MARK CARNESE

Executive Director

+1 503 279 1764

mark.carnese@cushwake.com

DOUG DEURWAARDER

Executive Director

+1 503 279 1752

doug.deurwaarder@cushwake.com



**CUSHMAN &
WAKEFIELD**

SECOND FLOOR

**Second Floor: 9,144 RSF,
divisible to 2,500 SF**

Property Highlights

- Highly visibly corner facade with wood laminate vestibule
- Excellent NW District location offers loads of amenities, walking distance to New Seasons Market & easy access to the Pearl
- Home to iconic Northwest brand Tillamook's new Portland office.
- New Northwest chic construction: high ceilings, oversized windows, and exposed wood beams
- Parking available
- Rate: \$25.50 NNN (NNNs estimated to be \$7.50)

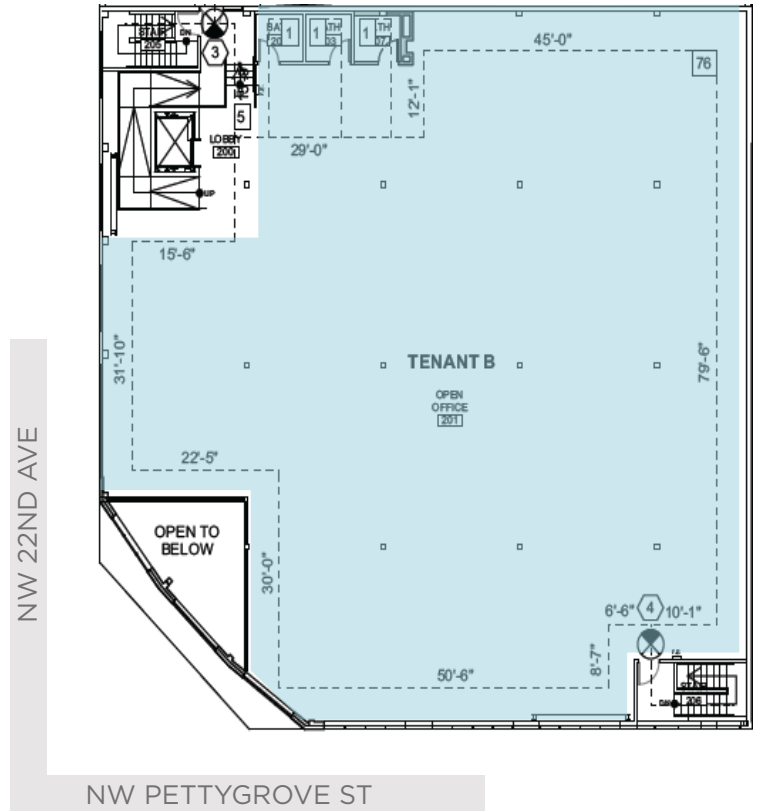



AMENITY MAP

SLABTOWN THE BEST NEW NEIGHBORHOOD IN PORTLAND

- Restaurant/Bar**
- R1** The Matador
- R2** Grassa
- R3** Moberi
- R4** Bull Run Distillery
- R5** Muse Winebar
- R6** St. Jack
- R7** Breakside Brewery
- R8** The Solo Club
- R9** Besaws
- R10** Lucky Labrador Brew Pub

- Coffee**
- C1** Starbucks
- C2** Vivace
- C3** New Seasons Market
- C4** Good Coffee
- Fitness & Health**
- F1** Studio Blue Pilates
- F2** Core Power Yoga
- F3** Orange Theory Fitness

- Services**
- S1** CVS Pharmacy
- S2** Zoom Care
- S3** Dove Lewis Animal Hospital
- S4** The Joint Chiropractic
- S5** Consolidated Community CU

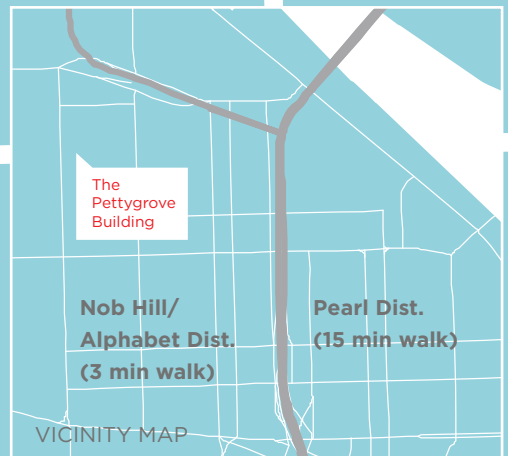

coffee shops



fitness/gyms



services



restaurant/bars

...within immediate walking distance.

TRANSPORTATION MAP

The Pettygrove Building



Walk Score 96



BikeScore 98



2 min Streetcar Stop
25 min Union Station
2 min Line 77
20 min MAX Red Line



1 min
7 min
1 min
4 min



North/South Streetcar Line



77 Bus Line



B Loop Streetcar Line



MAX Red Line



MAX Yellow Line



MAX Green Line

MARK CARNESE

Executive Director
 +1 503 279 1764
mark.carnese@cushwake.com

DOUG DEURWAARDER

Executive Director
 +1 503 279 1752
doug.deurwaarder@cushwake.com

200 SW Market Street, Suite 200
 Portland, OR 97201
 Main +1 503 279 1700
 Fax +1 503 274 6512
cushmanwakefield.com/Portland
 Brokers are Licensed in OR & WA



Cushman & Wakefield Copyright 2018. No warranty or representation, express or implied, is made to the accuracy or completeness of the information contained herein, and same is submitted subject to errors, omissions, change of price, rental or other conditions, withdrawal without notice, and to any special listing conditions imposed by the property owner(s). As applicable, we make no representation as to the condition of the property (or properties) in question.