

# RAIL SERVED BLDG FOR SALE OR LEASE

## BEARD INDUSTRIAL DISTRICT

427 DOHERTY AVENUE, MODESTO, CA

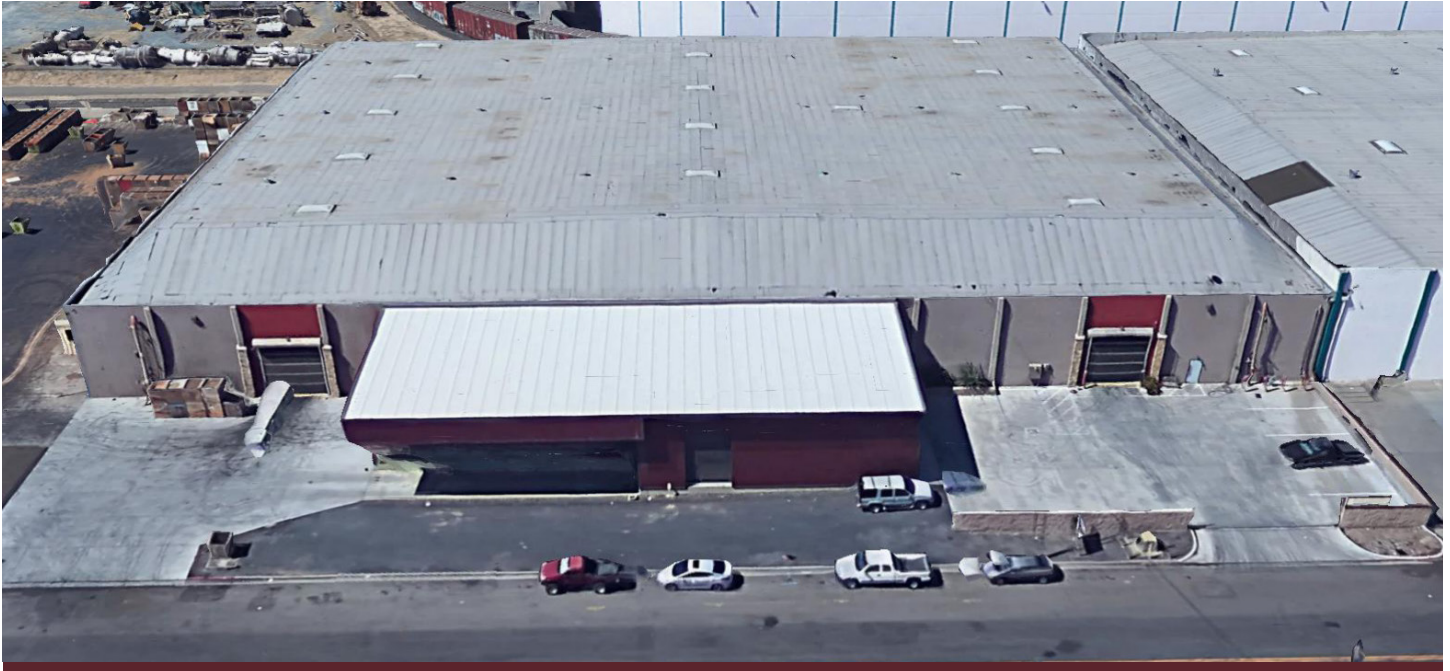

## LISTING DATA

**AVAILABLE SF:** 72,540± SF on 2.48± AC

**OFFICE SF:** 1,500± SF

**DOORS :**

Dock High: One (1) - well

Grade Level: Five (5) - (3) 12' x 14'  
(2) 14' x 14'

Rail: Three (3) (M&ET), short line  
rail road, 15' x 345' exterior  
dock

**CLEAR HEIGHT :** 25'±

**WHSE LIGHTS :** T-5 skylights

**BLDG DIMENSIONS :** Original - ±225' x 300'  
Expansion - ±42' x 120'

**COLUMN SPACING :** 20' x 90' - original section

**POWER :** 400 amps, 240/480 v, 3 phase

**COMMENTS:**

- 27,000± SF concrete yard at south end of building
- Rail served
- Attractive concrete tilt-up construction
- High speed Rytec dorrns and other recent upgrades
- In 15,000,000± SF Beard industrial District
- Available February 2019

## ECONOMIC DATA

**SALE PRICE:** Call agent for rates

**LEASE RATE:**

**Mark J. Reckers**

BRE #00938704

mreckers@lee-associates.com

D 209.983.6838

All information furnished regarding property for sale, rental or financing is from sources deemed reliable, but no warranty or representation is made to the accuracy thereof and same is submitted to errors, omissions, change of price, rental or other conditions prior to sale, lease or financing or withdrawal without notice. No liability of any kind is to be imposed on the broker herein.

# RAIL SERVED BLDG FOR SALE OR LEASE

## BEARD INDUSTRIAL DISTRICT

427 DOHERTY AVENUE, MODESTO, CA

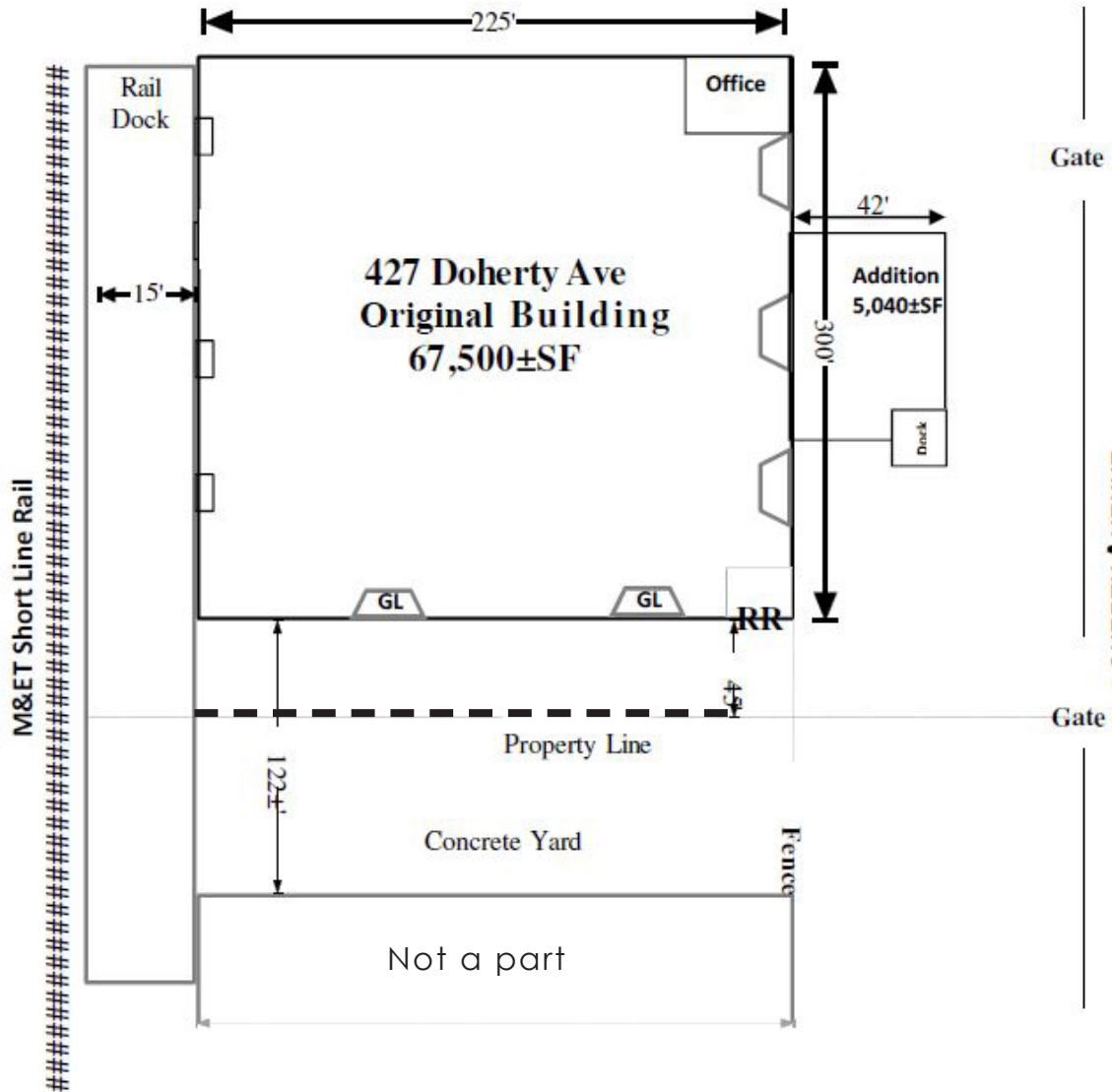

All information furnished regarding property for sale, rental or financing is from sources deemed reliable, but no warranty or representation is made to the accuracy thereof and same is submitted to errors, omissions, change of price, rental or other conditions prior to sale, lease or financing or withdrawal without notice. No liability of any kind is to be imposed on the broker herein.

# RAIL SERVED BLDG FOR SALE OR LEASE BEARD INDUSTRIAL DISTRICT 427 DOHERTY AVENUE, MODESTO, CA

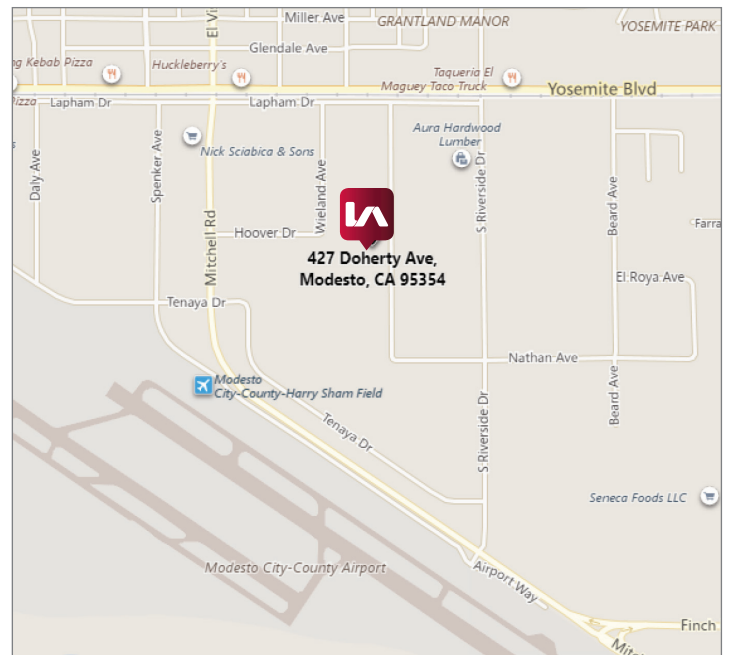
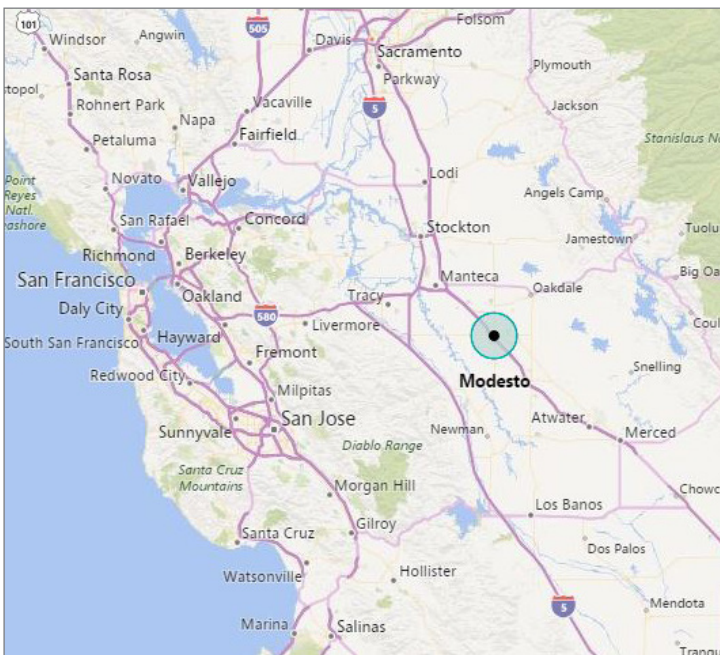
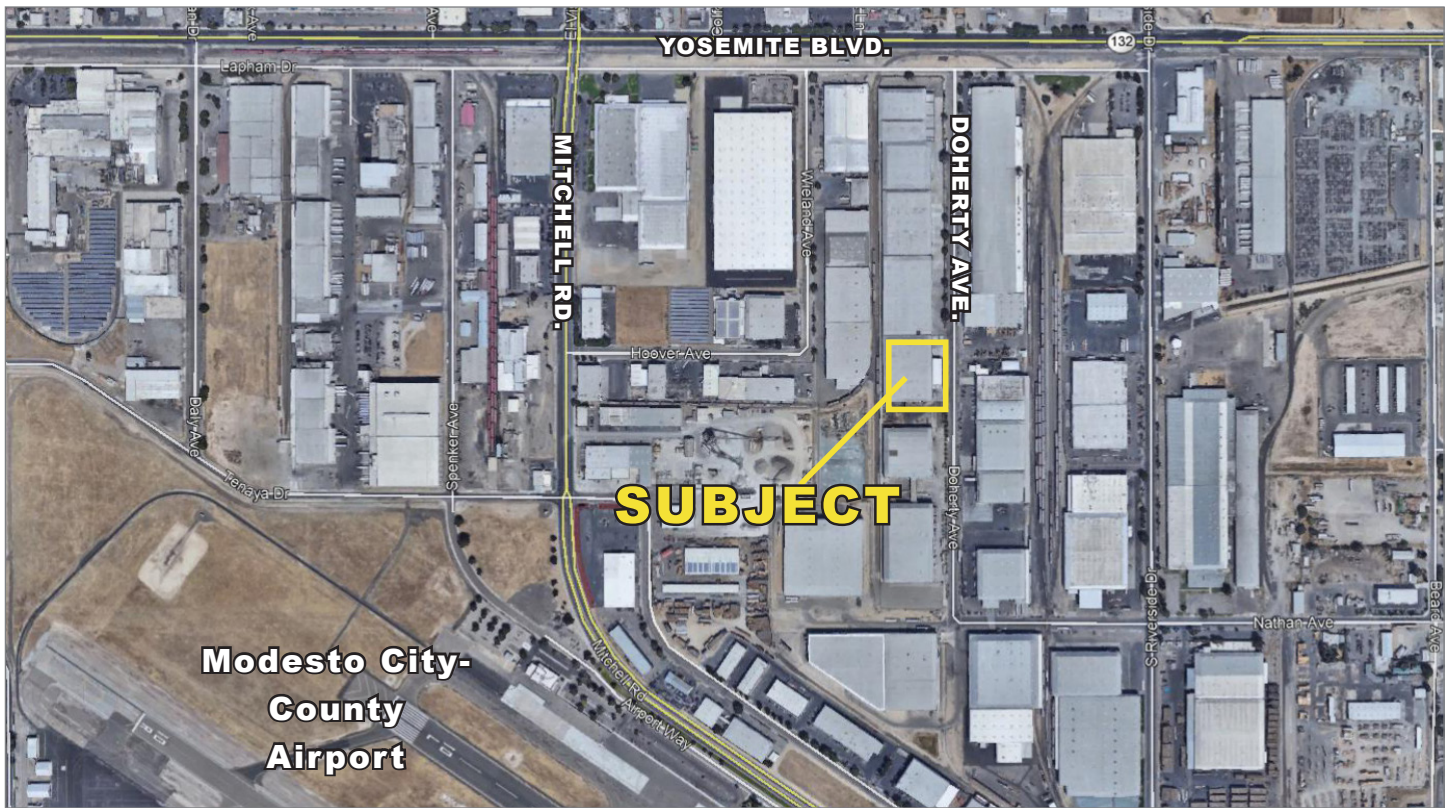

**Mark J. Reckers**

BRE #00938704

mreckers@lee-associates.com

D 209.983.6838

All information furnished regarding property for sale, rental or financing is from sources deemed reliable, but no warranty or representation is made to the accuracy thereof and same is submitted to errors, omissions, change of price, rental or other conditions prior to sale, lease or financing or withdrawal without notice. No liability of any kind is to be imposed on the broker herein.