

6,646 SF AVAILABLE

# CASCADES AT THE COLONY

5830 CRESCENT DRIVE | THE COLONY, TEXAS

## BUILDING 10

31,328 SF



### BUILDING HIGHLIGHTS:

Square Feet:	31,328 SF
Available:	6,646 SF
Office:	BTS
Warehouse:	6,646 SF
Bldg. Depth:	+/- 120'
Clear Height:	+/- 18'
Parking Spaces:	3 / 1,000 SF
Dock High Doors:	0
Drive-In Doors:	Grade Level

### FOR LEASING INFORMATION:

**NATHAN DURHAM**  
972.774.2503  
Nathan.Durham@transwestern.com

**CLAYTON JOHNSON**  
214.292.6426  
Clayton.Johnson@transwestern.com

 **TRANSWESTERN**<sup>®</sup>

2300 North Field Street | Suite 2000  
Dallas, Texas 75201

# CASCADES

AT THE COLONY

## BUILDING 10

31,328 SF | 6,646 SF Available

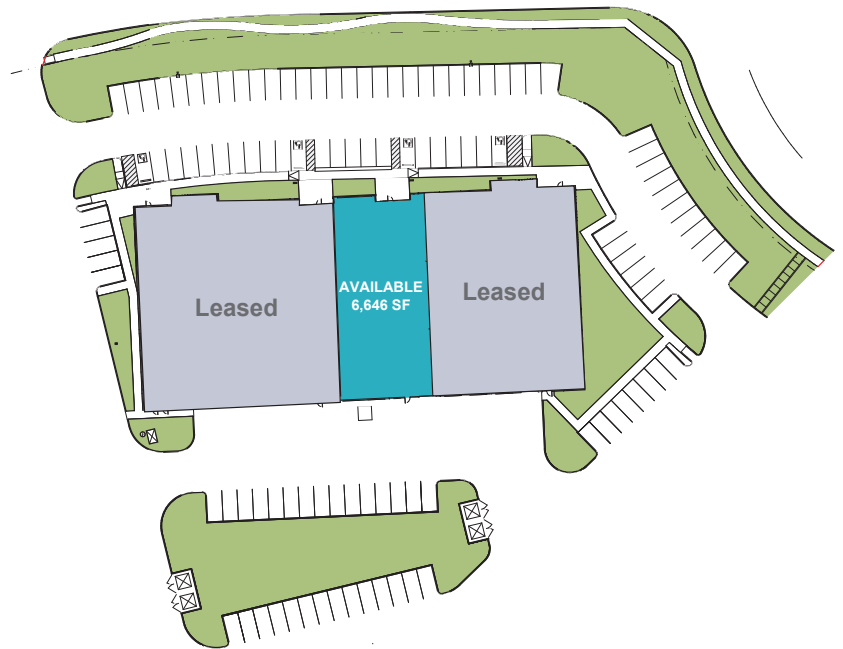
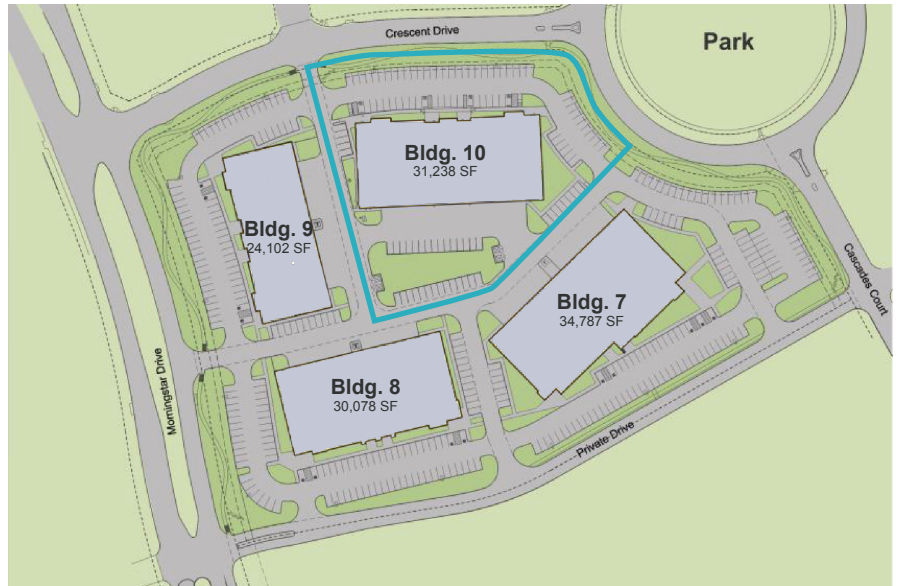

### FOR LEASING INFORMATION:

NATHAN DURHAM  
972.774.2503  
Nathan.Durham@transwestern.com

CLAYTON JOHNSON  
214.292.6426  
Clayton.Johnson@transwestern.com



2300 North Field Street | Suite 2000  
Dallas, Texas 75201

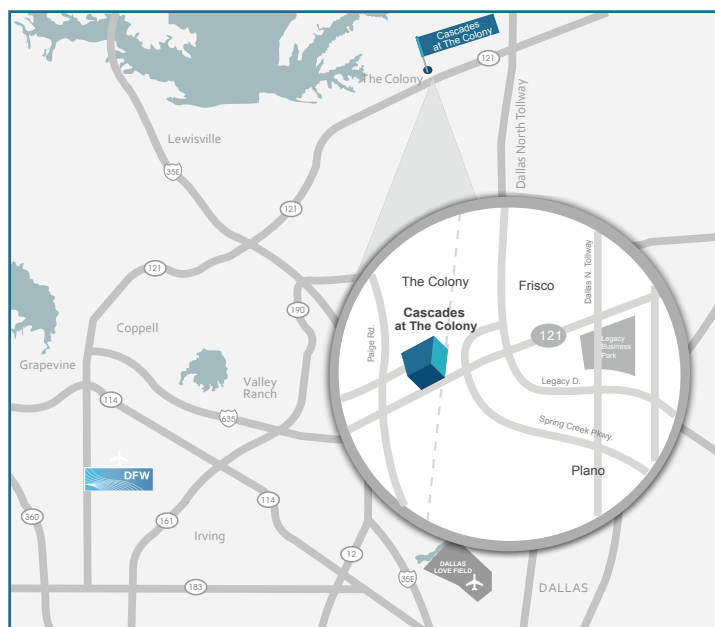

# CASCADES

AT THE COLONY

## BUILDING 10

31,328 SF | 6,646 SF Available

### FOR LEASING INFORMATION:

NATHAN DURHAM

972.774.2503

Nathan.Durham@transwestern.com

CLAYTON JOHNSON

214.292.6426

Clayton.Johnson@transwestern.com



2300 North Field Street | Suite 2000  
Dallas, Texas 75201

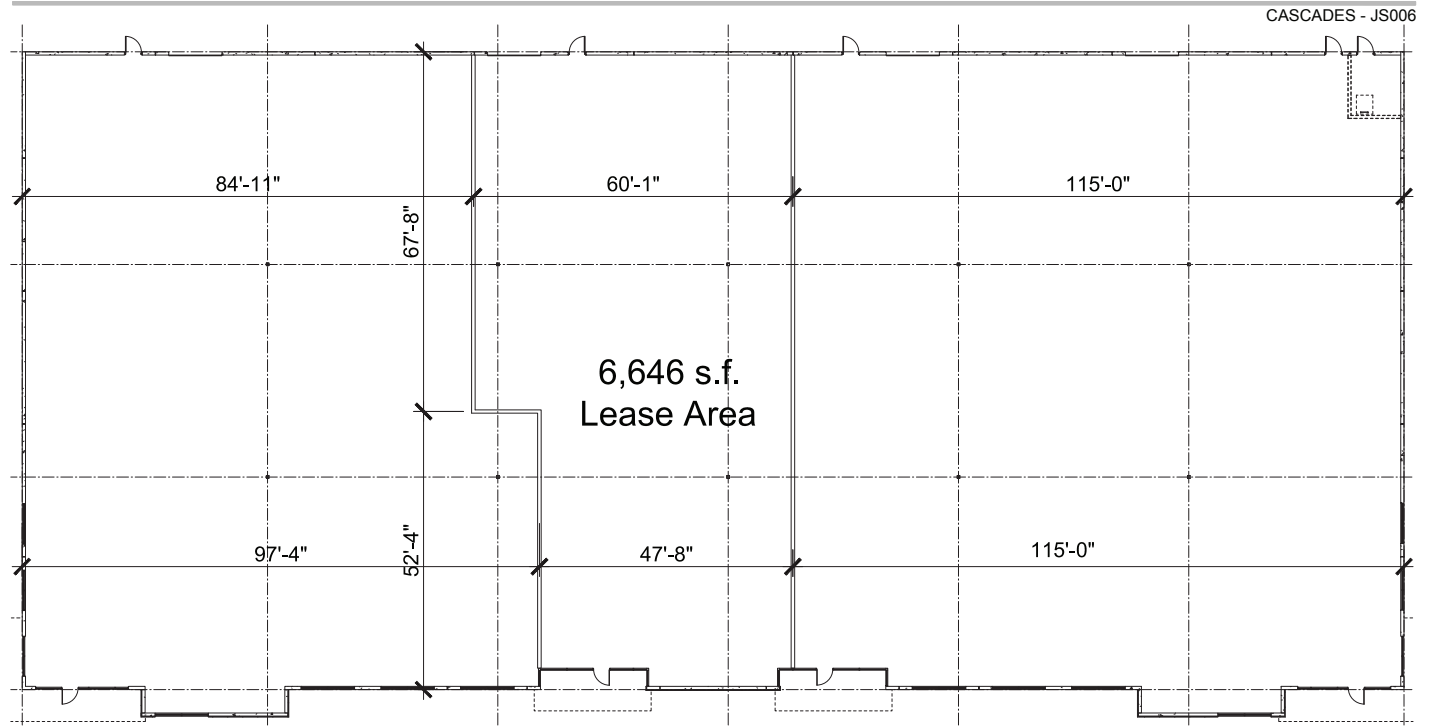

Building 10 Demising Wall Exhibit

August 28, 2015

