

25524 JOHN R ROAD  
MADISON HEIGHTS, MICHIGAN

INDUSTRIAL FOR SALE OR LEASE  
5,367 Square Feet Available



**SIGNATURE  
ASSOCIATES**  
KNOW SIGNATURE | KNOW RESULTS

**PETERSON ELECTRIC**



**VIEW  
INSIDE**



## PROPERTY FEATURES

- 5,367 square feet available
- 800 square feet of office
- 12'6" – 16' clear height
- (1) 12x14 grade level door
- Zoned Industrial
- 1,000 amps, 240 volts, 3-phase, buss duct power
- Great manufacturing building with light duty cranes
- Skylights and drains
- Main road frontage located at I-696 and I-75
- Lease Rate: \$5.50/sq.ft. NNN
- Sale Price: \$425,000 (\$79.19/sq.ft.)

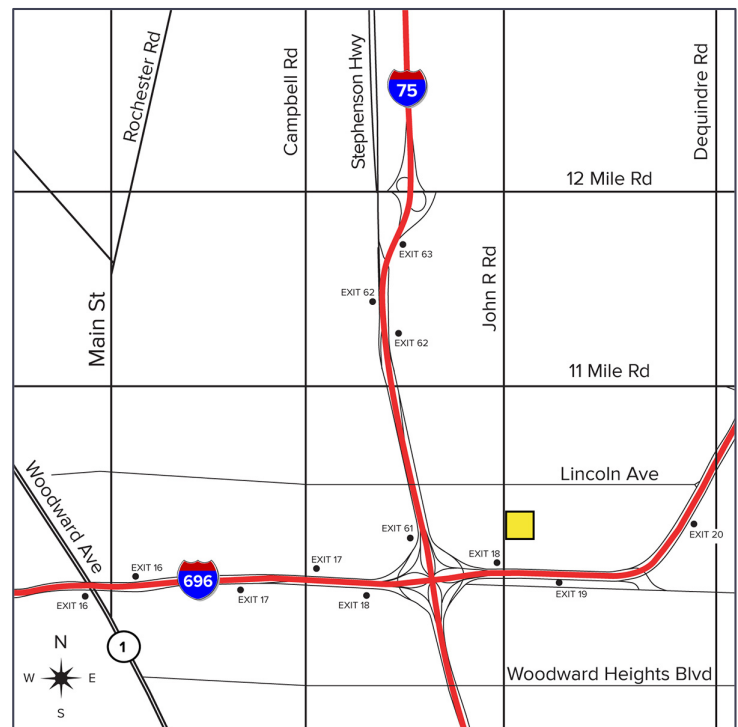

For more information, please contact:

**KRIS PAWLOWSKI**  
(248) 359 3801  
kpawlowski@signatureassociates.com

**SIGNATURE ASSOCIATES**  
One Towne Square, Suite 1200  
Southfield, MI 48076  
www.signatureassociates.com

25524 John R Road – Madison Heights, Michigan  
Industrial For Sale or Lease

5,367  
Square Feet  
AVAILABLE

Site Plan



For more information, please contact:

**KRIS PAWLOWSKI**  
(248) 359 3801  
kpawlowski@signatureassociates.com

**SIGNATURE ASSOCIATES**  
One Towne Square, Suite 1200  
Southfield, MI 48076  
www.signatureassociates.com

# 25524 John R Road – Madison Heights, Michigan

## Industrial For Sale or Lease

5,367  
Square Feet  
AVAILABLE

### Floor Plan

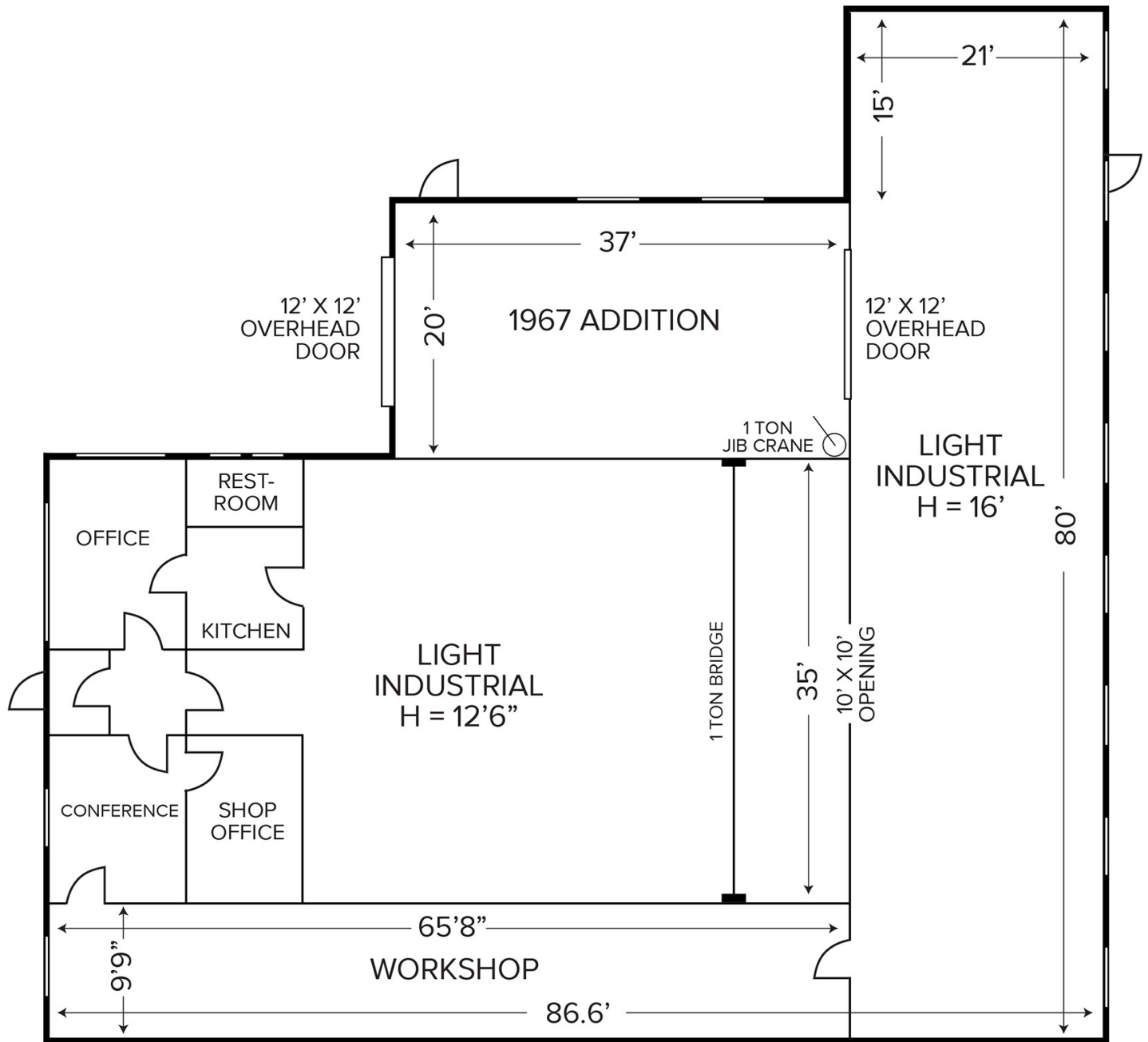

For more information, please contact:

**KRIS PAWLOWSKI**  
(248) 359 3801  
kpawlowski@signatureassociates.com

**SIGNATURE ASSOCIATES**  
One Towne Square, Suite 1200  
Southfield, MI 48076  
www.signatureassociates.com