

**NEW DEVELOPMENT**

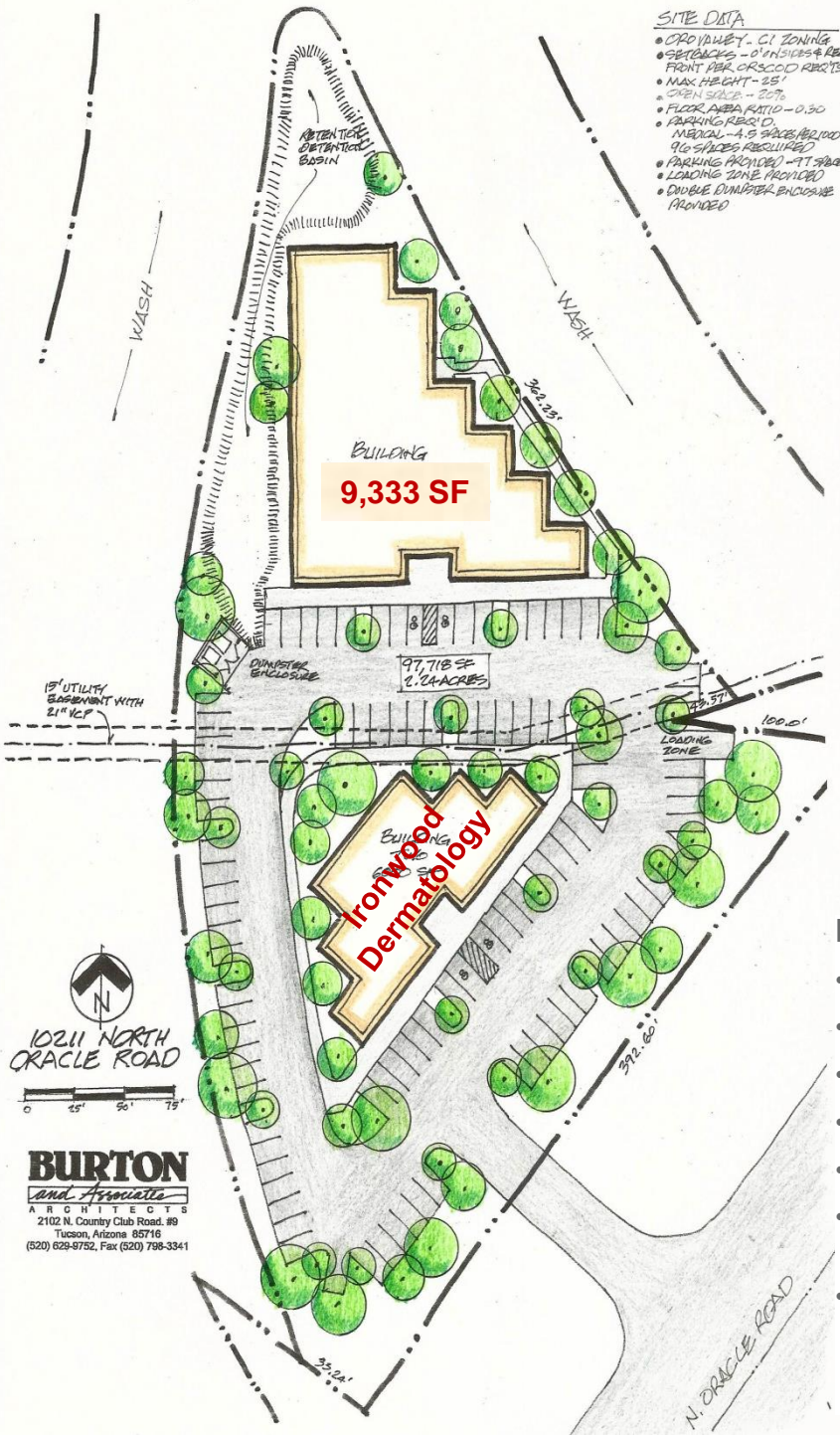

**2.38 Acres C-1 Zoned Land**  
**For Sale, Lease or Build-to-Suit**

**Property Features**

- One building site remaining – 9,333 SF
- 5/1000 parking ratio
- Excellent visibility and exposure
- Traffic counts more than 47,000 vpd
- 2016 population estimate - 78,000 (5 mile radius)
- Average Household Income - \$100,000 (5-Mile Radius)
- Close to Oro Valley Hospital, shopping, restaurants and services

For more information, please contact:

**Thomas J. Nieman, Principal**  
**Commercial Properties**  
 +1 520 546 2728  
 tnieman@picor.com

**PICOR Commercial Real Estate Services**  
 5151 E. Broadway Blvd, Suite 115  
 Tucson, Arizona 85711  
 phone: +1 520 748 7100  
 picor.com

Independently Owned and Operated / A Member of the Cushman & Wakefield Alliance  
 Cushman & Wakefield Copyright 2015. No warranty or representation, express or implied, is made to the accuracy or completeness of the information contained herein, and same is submitted subject to errors, omissions, change of price, rental or other conditions, withdrawal without notice, and to any special listing conditions imposed by the property owner(s). As applicable, we make no representation as to the condition of the property (or properties) in question.

**Area Map**

**NEW DEVELOPMENT**



For more information, contact:

**Thomas J. Nieman, Principal**  
**Commercial Properties**  
 +1 520 546 2728  
 tnieman@picor.com

**PICOR Commercial Real Estate Services**  
 5151 E. Broadway Blvd, Suite 115  
 Tucson, Arizona 85711  
 phone: +1 520 748 7100  
 picor.com

Independently Owned and Operated / A Member of the Cushman & Wakefield Alliance  
 Cushman & Wakefield Copyright 2015. No warranty or representation, express or implied, is made to the accuracy or completeness of the information contained herein, and same is submitted subject to errors, omissions, change of price, rental or other conditions, withdrawal without notice, and to any special listing conditions imposed by the property owner(s). As applicable, we make no representation as to the condition of the property (or properties) in question.