

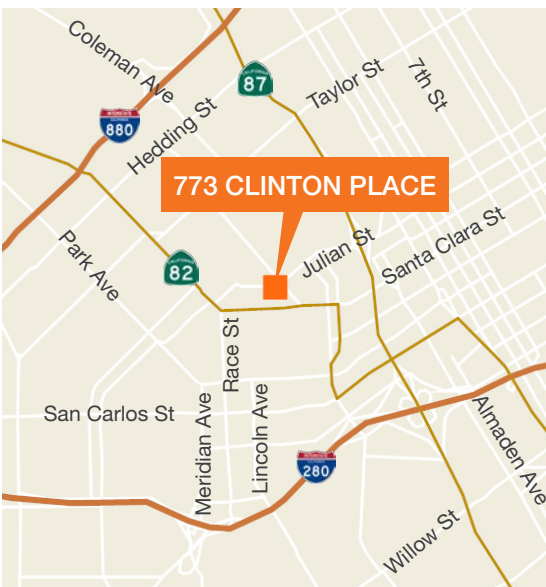

Available For Sale



773 CLINTON: ±1,386 SF OFFICE BUILDING
710/708 W JULIAN: ±4,470 SF MFG BUILDING

Ideal for Contractor's space

Zoning: Light Industrial; General Plan: Urban Village

Great freeway access to Highways 87 and 280

±0.4 miles from Diridon Caltrain station

Billboard Rental income in place

Call to show; do not disturb Tenant

Asking Price: \$2,050,000 (\$350 PSF)

Contact

Mike Denevi
408.588.2384
mdenevi@kiddermathews.com
LIC #00843926

James Viso
408.588.2330
jviso@kiddermathews.com
LIC #01751851

kiddermathews.com

773 Clinton Place

Two Buildings Totaling $\pm 5,856$ SF For Sale

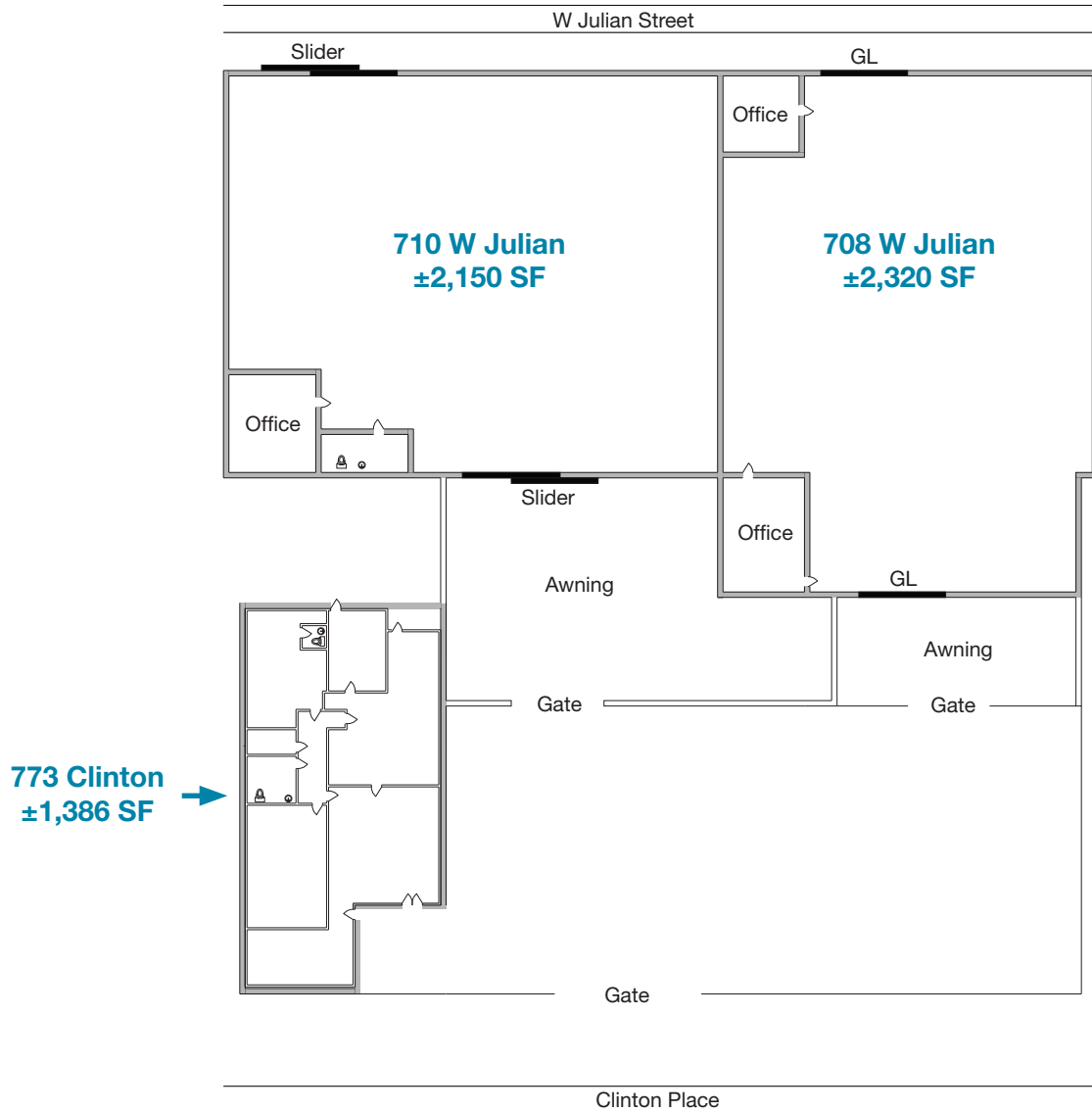

Contact

Mike Denevi
408.588.2384
mdenevi@kiddermathews.com
LIC #00843926

James Viso
408.588.2330
jviso@kiddermathews.com
LIC #01751851

kiddermathews.com

773 Clinton Place

Two Buildings Totaling ±5,856 SF For Sale

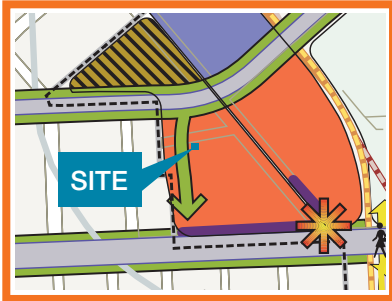

KEY | GENERAL USE PLAN

- Downtown
- Commercial Downtown
- Urban Village
- Transit Employment Center
- Combined Industrial/Commercial
- Transit Residential (65-250 du/ac)
- Urban Residential (30-95 du/ac)
- Residential Neighborhood (typically 8 du/ac)
- Open Space, Parklands, and Habitat
- Public/Quasi Public
- Land use not adopted by City Council
Refer to the General Plan for guidance
- Required Retail Frontage
- Arterial Street
- Collector Street
- Green Street
- Green Connection
- Neighborhood/Activity Center
- Pedestrian Connection
- Station

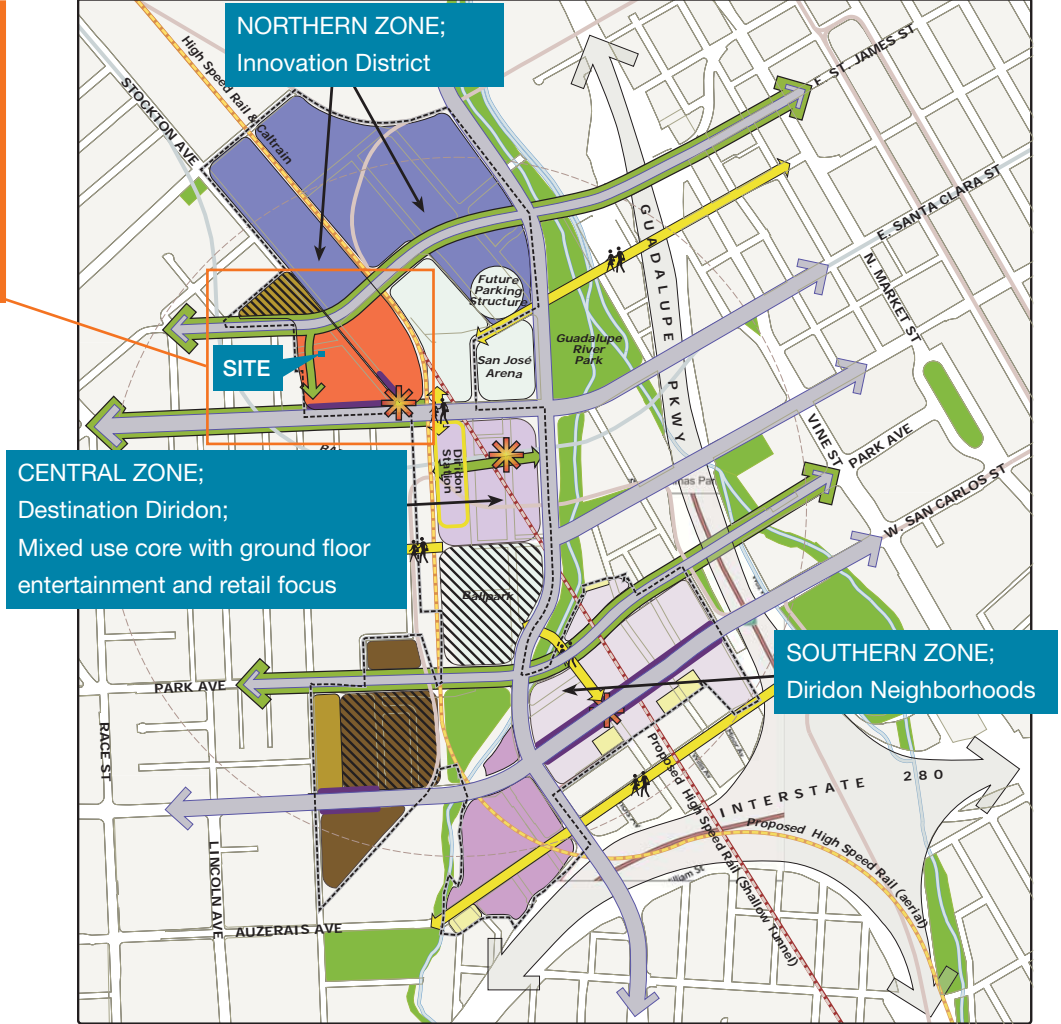

Contact

Mike Denevi
408.588.2384
mdenevi@kiddermathews.com
LIC #00843926

James Viso
408.588.2330
jviso@kiddermathews.com
LIC #01751851

kiddermathews.com

This information supplied herein is from sources we deem reliable. It is provided without any representation, warranty or guarantee, expressed or implied as to its accuracy. Prospective Buyer or Tenant should conduct an independent investigation and verification of all matters deemed to be material, including, but not limited to, statements of income and expenses. Consult your attorney, accountant, or other professional advisor.

