



**THALHIMER**

FOR LEASE

# MADISON SQUARE SHOPPING CENTER

4088 Electric Road | Roanoke, VA 24018



For more information, contact:

**BARRY WARD**  
Vice President  
540 767 3015  
[barry.ward@thalhimer.com](mailto:barry.ward@thalhimer.com)

Wells Fargo Tower  
10 S. Jefferson Street, Suite 1750  
Roanoke, VA 24011  
[www.thalhimer.com](http://www.thalhimer.com)

Independently Owned and Operated / A Member of the Cushman & Wakefield Alliance

Cushman & Wakefield / Thalhimer © 2015. No warranty or representation, express or implied, is made to the accuracy or completeness of the information contained herein, and same is submitted subject to errors, omissions, change of price, rental or other conditions, withdrawal without notice, and to any special listing conditions imposed by the property owner(s). As applicable, we make no representation as to the condition of the property (or properties) in question.

**FOR LEASE  
MADISON SQUARE SHOPPING CENTER**

4088 Electric Road | Roanoke, VA 24018

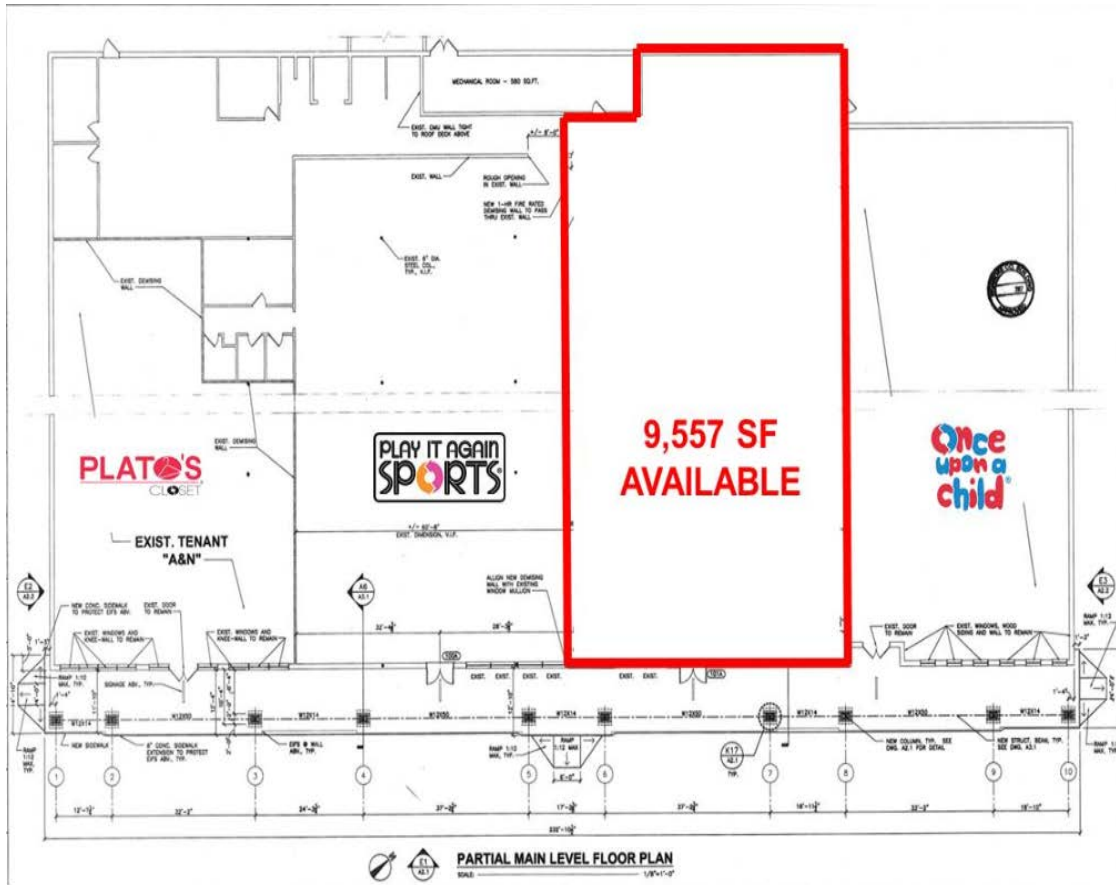

**Property Features**

- Excellent Southwest County Visibility
- Attractive Recent Renovations
- 0.1 Miles from Area Shopping Mall
- Heavy Daily Consumer Traffic road
- Electric Road – 27,000 VPD

**Demographics**

	1 Mile	3 Miles	5 Miles
Population	6,155	49,854	105,720
Avg. HH Income	\$67,877	\$74,871	\$63,691
Daytime Population	7,354	32,754	80,192

**Join Tenants/Nearby Retailers**



For more information, contact:

**BARRY WARD**  
Vice President  
540 767 3015  
barry.ward@thalhimer.com

Wells Fargo Tower  
10 S. Jefferson Street, Suite 1750  
Roanoke, VA 24011  
www.thalhimer.com