

Tin Man Road

3± Acres of Prime Industrial Land

Mentor, Ohio 44060 (Lake County)



Tin Man Road, Mentor, Ohio 44060

Property Features:

- 3± Acres Prime Industrial Land
- Leveled and Cleared
- Zoned M2 – Heavy Manufacturing
- Utilities at the Street
- Mentor Economic Development Incentives Available for Qualified Buyers
 - ~Mentor Incentive Grant (MIG)
 - ~Mentor Economic Development Grant (MEDG)
- Great Location with Easy Access to Heisley Road, SR 2, SR 44 and Minutes to Interstate 90

Sale Price \$204,000.00

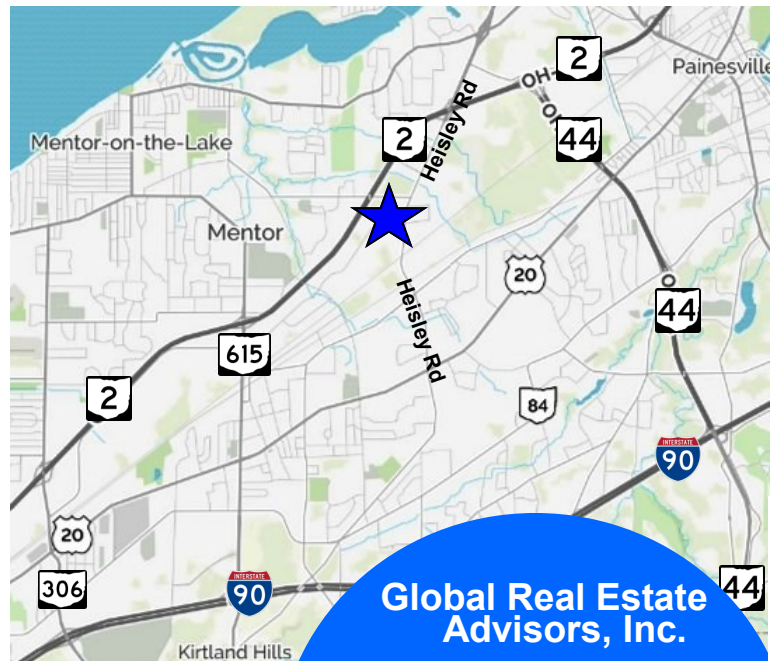

www.GlobalCommercialRE.com

8585 East Ave., Mentor, Ohio 44060

Real Estate Advisors Inc.
BROKER

**Global Real Estate
Advisors, Inc.**

Nancy Stark Zangerle

440-255-5552 x 229

216-316-0913 Cell

Nancy@GlobalCommercialRE.com

Neil Sawicki, SIOR, Broker

440-255-5552 x 221

Neil@GlobalCommercialRE.com

This information has been secured from sources we believe are reliable, but we make no representations or warranties, expressed or implied, as to the accuracy of the information. References to condition, square footage or age are approximate. Buyer or Tenant acknowledges that they are relying on their own investigations and are not relying on Broker provided information. Procuring broker shall only be entitled to a commission, calculated in accordance with the rates approved by our principal only if such procuring broker executes a brokerage agreement acceptable to us and our principal and the conditions as set forth in the brokerage agreement are fully and unconditionally satisfied. Although all information furnished regarding property for sale, rental, or financing is from sources deemed reliable, such information has not been verified and no express representation is made nor is any to be implied as to the accuracy thereof and it is submitted subject to errors, omissions, change of price, rental or other conditions, prior sale, lease or financing, or withdrawal without notice and to any special conditions imposed by our principal.

Tin Man Road

3± Acres of Prime Industrial Land

Mentor, Ohio 44060 (Lake County)

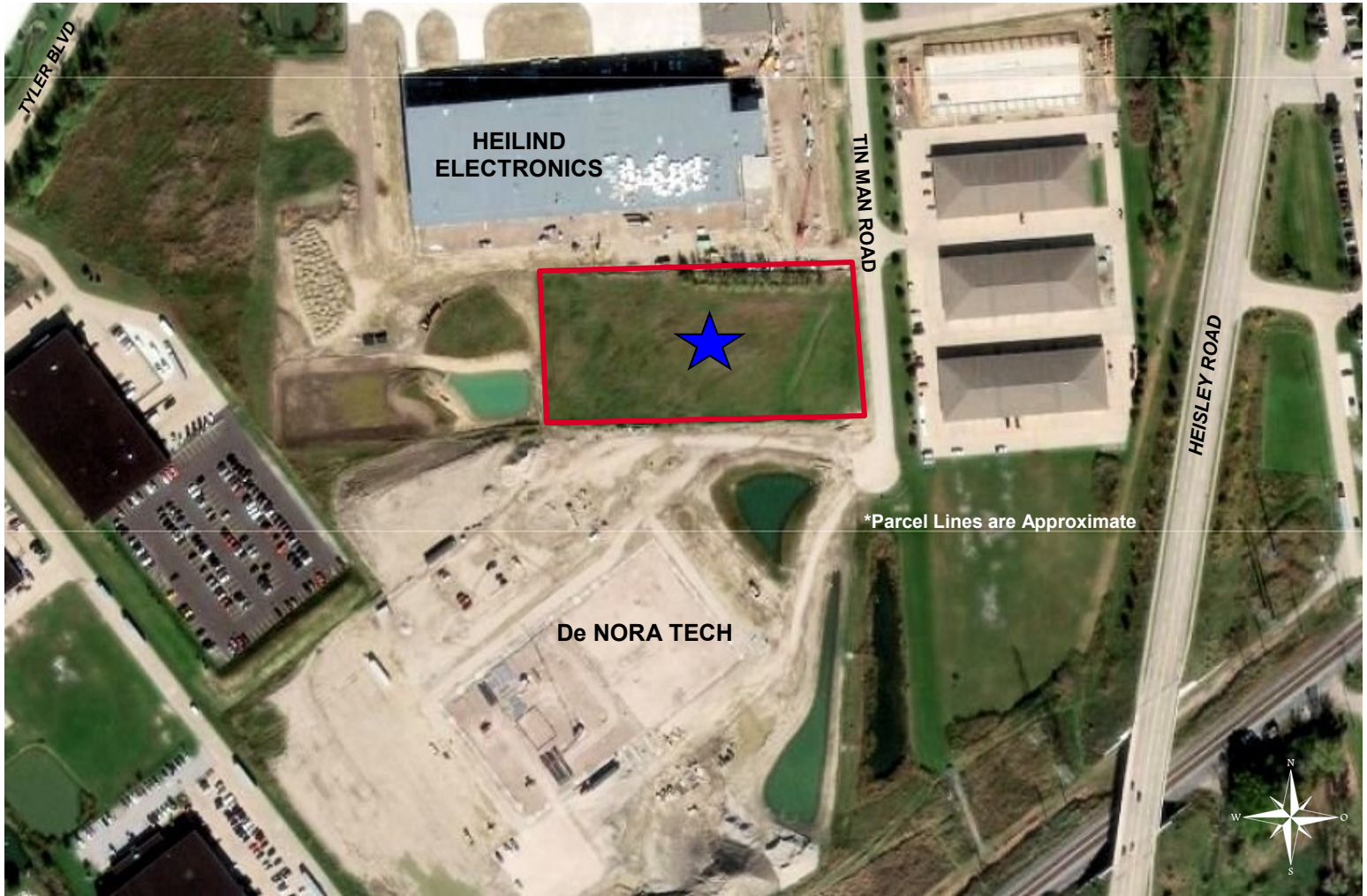

Mentor, Ohio Means Business

- **The City of Mentor** is a manufacturing leader in the state of Ohio with a strong concentration of research and development, engineering, and metalworking firms serving the advanced manufacturing, aerospace, polymer, and biomedical industry clusters. Nearly 300 manufacturers have chosen Mentor as their home.
- **A Strategic Location** - Direct access to multiple major interstate highways, two railways, one international and several general aviation airports. 30 kilometers from major deepwater port in Cleveland, Ohio with direct rail connection. Located within 800 kilometers of 50% of the US population. Attractive and safe community on shores of Lake Erie consistently voted as one of the "Best Places to Live in America".
- **Ready to Work** - Mentor maintains a skilled and stable workforce
- **Ready to Build** - Mentor has ten Industrial Parks and over 3,200 Acres for Manufacturing Use.



www.GlobalCommercialRE.com

8585 East Ave., Mentor, Ohio 44060

Real Estate Advisors Inc.
BROKER

**Global Real Estate
Advisors, Inc.**

Nancy Stark Zangerle

440-255-5552 x 229

216-316-0913 Cell

Nancy@GlobalCommercialRE.com

Neil Sawicki, SIOR, Broker

440-255-5552 x 221

Neil@GlobalCommercialRE.com

This information has been secured from sources we believe are reliable, but we make no representations or warranties, expressed or implied, as to the accuracy of the information. References to condition, square footage or age are approximate. Buyer or Tenant acknowledges that they are relying on their own investigations and are not relying on Broker provided information. Procuring broker shall only be entitled to a commission, calculated in accordance with the rates approved by our principal only if such procuring broker executes a brokerage agreement acceptable to us and our principal and the conditions as set forth in the brokerage agreement are fully and unconditionally satisfied. Although all information furnished regarding property for sale, rental, or financing is from sources deemed reliable, such information has not been verified and no express representation is made nor is any to be implied as to the accuracy thereof and it is submitted subject to errors, omissions, change of price, rental or other conditions, prior sale, lease or financing, or withdrawal without notice and to any special conditions imposed by our principal.