

4,000-18,000 SF AVAILABLE FOR LEASE

2514-2518 WISCONSIN AVENUE, DOWNERS GROVE, ILLINOIS



BUILDING SPECIFICATIONS

- BUILDING SIZE:** ± 46,000 SF
- CEILING HEIGHT:** 16' clear
- POWER:** 200a; 120/208v
3-phase (per unit)
- SPRINKLER:** Yes
- HEAT:** Gas
- AIR CONDITIONING:** 100%

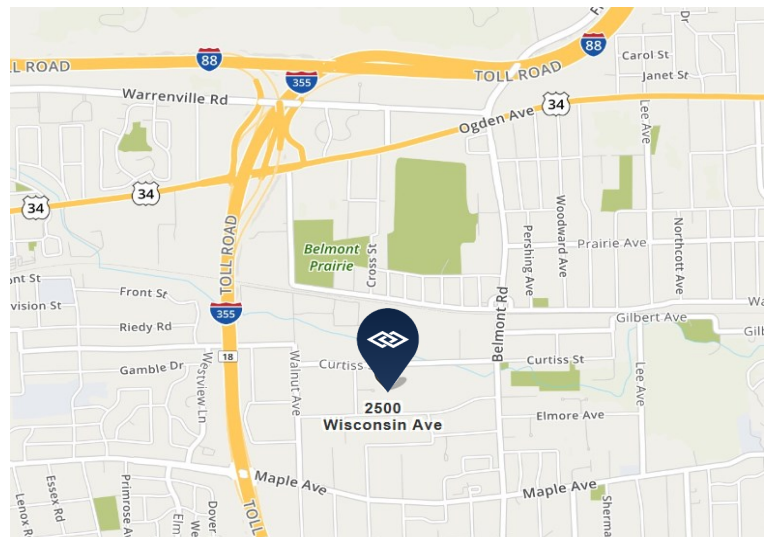

AVAILABLE UNITS:

	2514	2516	2518	2514-2518
SIZE (SF):	4,000	5,000	9,000	18,000
OFFICE (SF):	±1,200	±850	±1,800	±3,850
LOADING:	1 ext	1 ext	1 ext 1 DID	3 ext 1 DID
LEASE RATE (psf):	\$8.50 modified gross	\$8.50 modified gross	\$8.50 modified gross	\$8.50 modified gross

FEATURES

- Great office/warehouse flex units
- Ellsworth Industrial Park
- Excellent access to expressway at I-355 and Maple Ave.

FOR ADDITIONAL INFORMATION, PLEASE CONTACT:

MANDY LEWANDOWSKI
Associate
(630) 993-3851
mandy@darwinrealty.com

4,000-18,000 SF AVAILABLE FOR LEASE

2514-2518 WISCONSIN AVENUE, DOWNERS GROVE, ILLINOIS

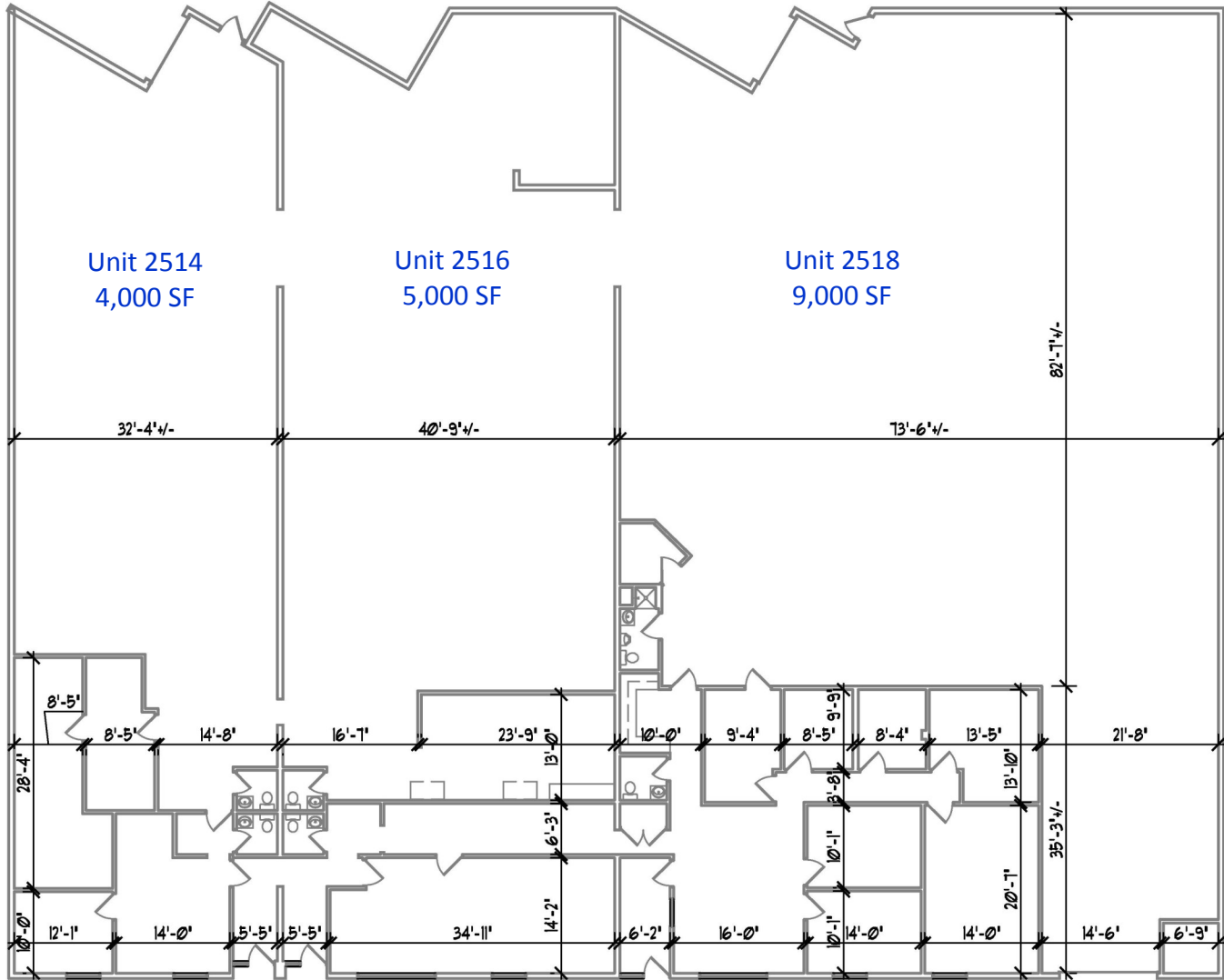

FOR ADDITIONAL
INFORMATION,
PLEASE CONTACT:

MANDY LEWANDOWSKI
Associate
(630) 993-3851
mandy@darwinrealty.com