

# FOR LEASE 2,072 SQ. FT.

# Voit

REAL ESTATE SERVICES

## MAJOR STREET FRONTAGE



330 E. Orangethorpe Avenue, Suite H, Placentia, CA 92870

### Features:

- 2,072 Total Square Feet
- **Major Street Frontage**
- Approx. 415 Square Feet of Office
- Multi-Tenant Building
- 2:1 Parking Ratio
- ±16' Clearance (verify)
- 1 Ground Level Loading Door
- No Common Area Maintenance Fee's
- High Visibility Location
- Great Freeway Access 57 & 91 Fwys



For Further Information, Please Contact:

**Hayden Socci, CCIM**

Vice President

714.935.2379

hsocci@voitco.com

Lic #01705038

# FOR LEASE

330 E. Orangethorpe Avenue, Suite H, Placentia, CA 92870

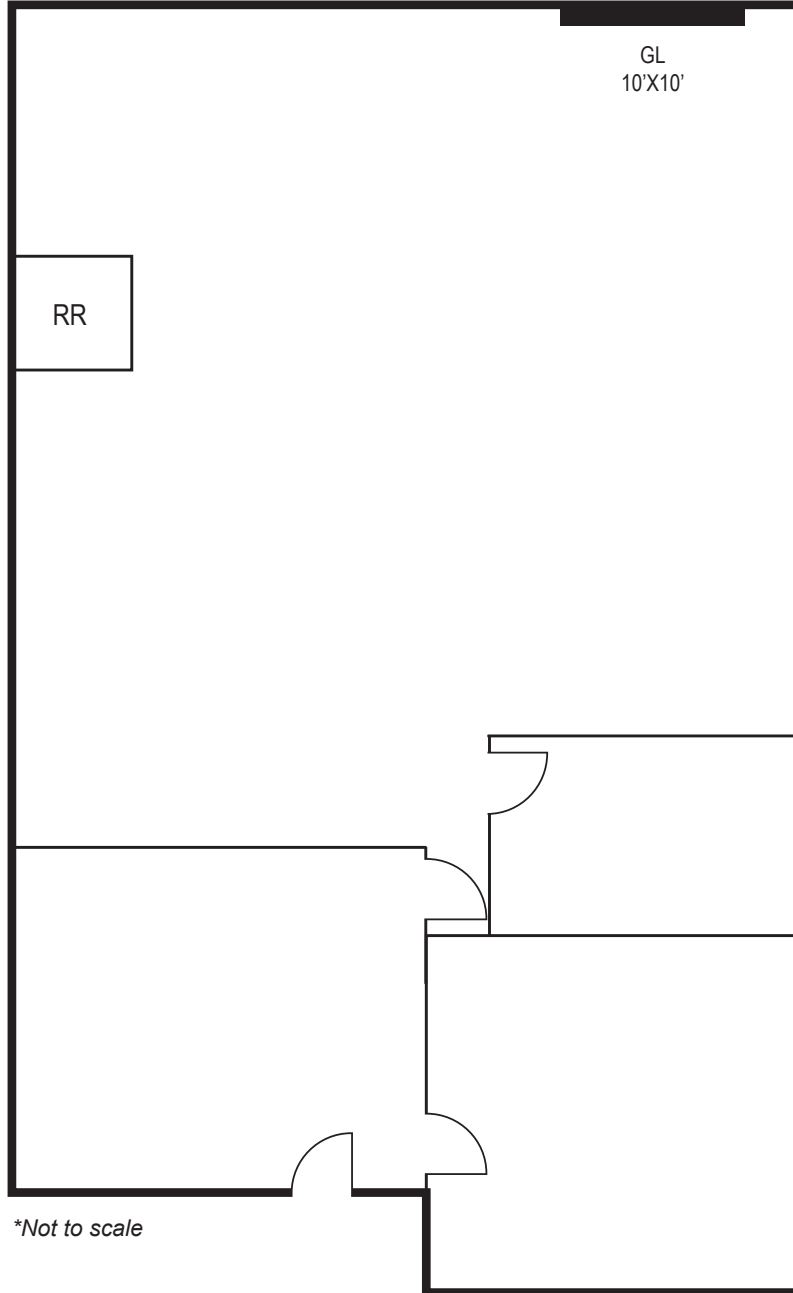

For Further Information, Please Contact:

**Hayden Socci, CCIM**

Vice President

714.935.2379

hsocci@voitco.com

Lic #01705038

# Voit

REAL ESTATE SERVICES

2400 E. Katella Ave., Ste. 750, Anaheim, CA 92806 • 714.978.7880 • 714.978.3471 Fax • Lic #01333376 | [www.voitco.com](http://www.voitco.com)

The information contained herein has been obtained from sources we deem reliable. While we have no reason to doubt its accuracy, we do not guarantee it.  
©2010 Voit Real Estate Services, Inc. All Rights Reserved. Real People. Real Solutions.™ is a trademark of Voit Real Estate Services.

**CORFAC**  
International