

FOR LEASE

Upland Distribution Center

14401 East 33rd Place, Unit A / Aurora, Colorado 80011



Prime End-Cap Space



19,898 SF Available For Lease

Lease Rate: Negotiable

Property Features

Available	±19,898 SF
Office	±3,800 SF
Loading	3 Dock-high doors 1 Drive-in door (12' x 14')
Clear Height	22'
Sprinklers	Yes
Power	200 Amps, 120/208 volts, 3-phase (TBV)
Zoning	M-1
Parking Ratio	1.0 : 1,000 SF
NNN Expenses	\$2.41/SF (2019)

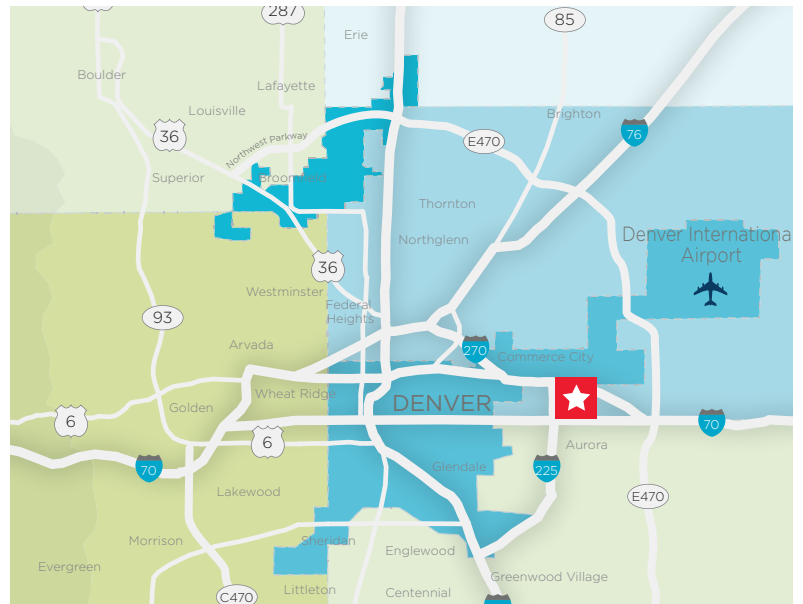

Additional Highlights

- Skylights
- Easy access to I-70 and I-225
- Rail possible (Union Pacific)
- 10 Miles from Denver International Airport (DIA)
- Concrete tilt construction
- 14 Miles to Downtown Denver

Owned By **GLP**

FOR LEASE

Upland Distribution Center

14401 East 33rd Place, Unit A / Aurora, Colorado 80011

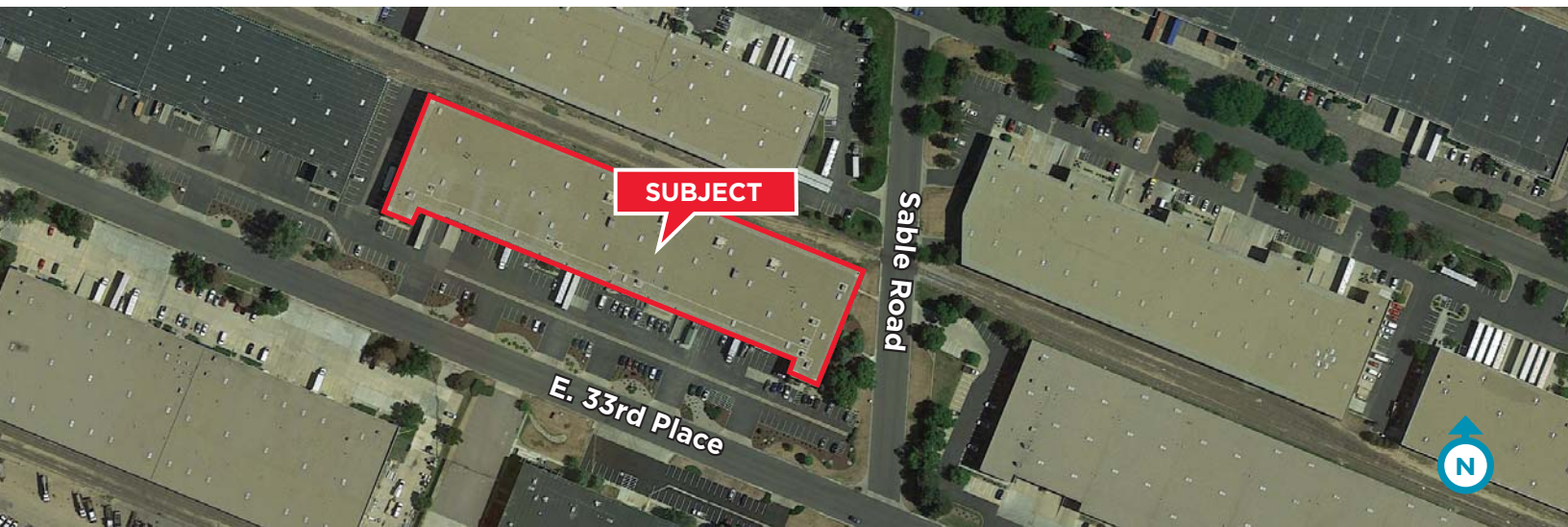
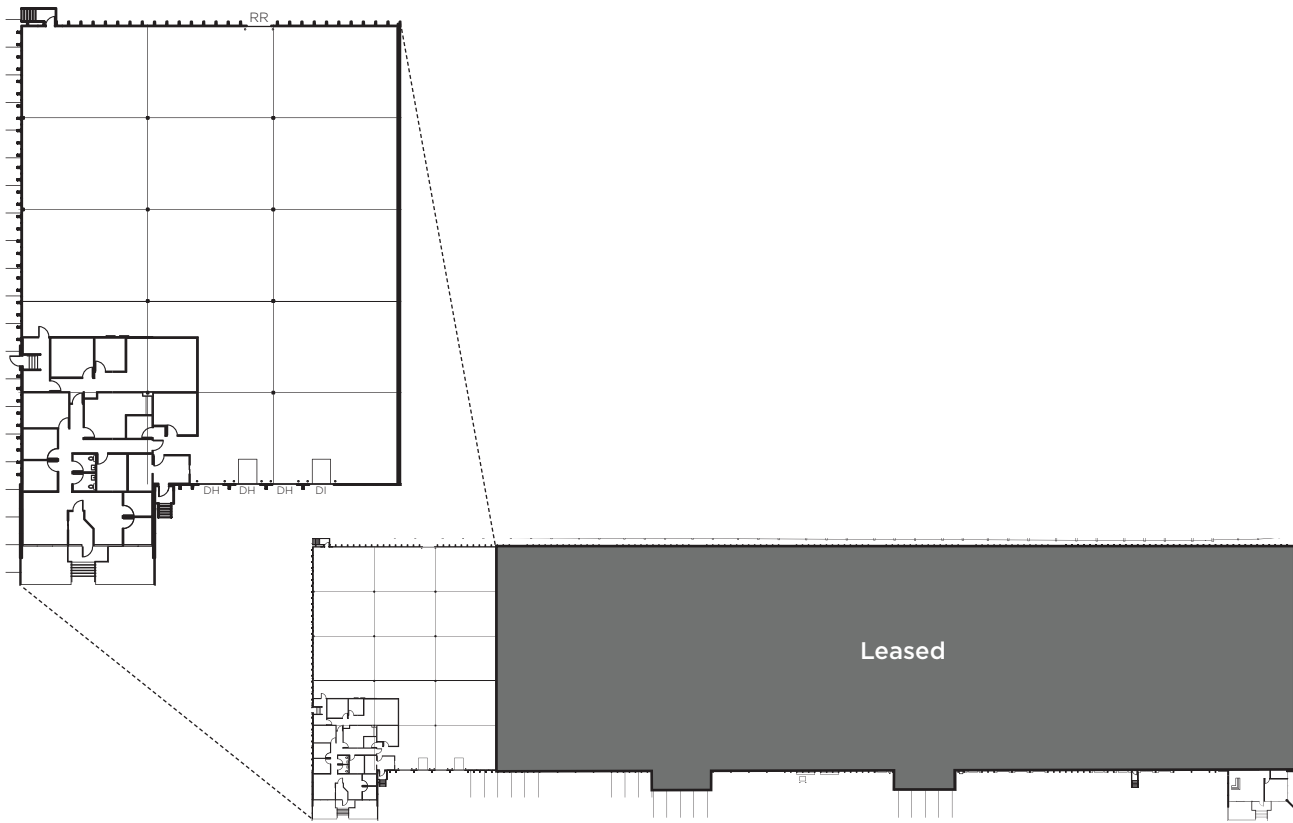

For more information, please contact:

Drew McManus, SIOR
Managing Director
+1 303 813 6427
drew.mcmanus@cushwake.com

Matt Trone, SIOR
Managing Director
+1 303 813 6426
matt.trone@cushwake.com

1401 Lawrence Street, Suite 1100 / Denver, Colorado 80202 / PHONE +1 303 292 3700 / FAX +1 303 534 8270 / cushmanwakefield.com

© 2019 Cushman & Wakefield. All rights reserved. The information contained in this communication is strictly confidential. This information has been obtained from sources believed to be reliable but has not been verified. NO WARRANTY OR REPRESENTATION, EXPRESS OR IMPLIED, IS MADE AS TO THE CONDITION OF THE PROPERTY (OR PROPERTIES) REFERENCED HEREIN OR AS TO THE ACCURACY OR COMPLETENESS OF THE INFORMATION CONTAINED HEREIN, AND SAME IS SUBMITTED SUBJECT TO ERRORS, OMISSIONS, CHANGE OF PRICE, RENTAL OR OTHER CONDITIONS, WITHDRAWAL WITHOUT NOTICE, AND TO ANY SPECIAL LISTING CONDITIONS IMPOSED BY THE PROPERTY OWNER(S). ANY PROJECTIONS, OPINIONS OR ESTIMATES ARE SUBJECT TO UNCERTAINTY AND DO NOT SIGNIFY CURRENT OR FUTURE PROPERTY PERFORMANCE.