

FOR LEASE

875 – 1,950 Sq. Ft. ±

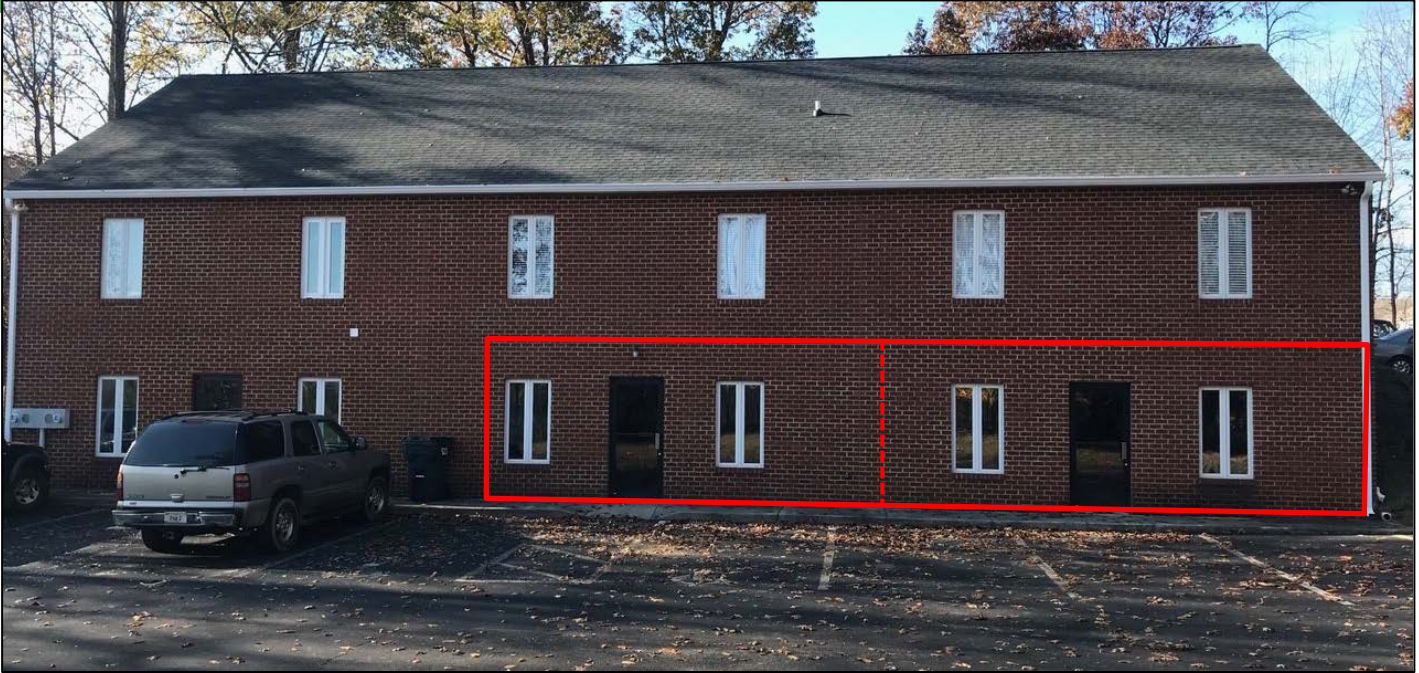

317 Brook Park Place Forest, VA

Terrace Level Office Space

Property Information

SIZE	875 – 1,950 Sq. Ft.
RENTAL RATE	\$12/Sq. Ft./Year – Vanilla Box
ZONING	C - 2
LOCATION	Located in Forest, VA just off of Enterprise Dr. and Forest Rd. Easy access to surrounding businesses, restaurants and YMCA.

Features

- ADA Accessible
- Vanilla Box finish w/ ability to build out to suit
- 10+ marked spaces
- Road signage on Brook Park Place



Coldwell Banker Commercial Read & Co. represent the Seller/Landlord of this property. Upon receipt of this information, Purchaser/Tenant acknowledges Coldwell Banker Commercial Read & Co.'s fiduciary responsibilities are to the Seller/Landlord.

Ricky Read, CCIM
434-841-3659
ricky@realestatelynchburg.com

Luke Dykeman
434-944-3920
lukedykeman@realestatelynchburg.com

CBCREAD.COM

©2018 Coldwell Banker Real Estate LLC, dba Coldwell Banker Commercial Affiliates. All Rights Reserved. Coldwell Banker Real Estate LLC, dba Coldwell Banker Commercial Affiliates fully supports the principles of the Equal Opportunity Act. Each Office is Independently Owned and Operated. Coldwell Banker Commercial and the Coldwell Banker Commercial Logo are registered service marks owned by Coldwell Banker Real Estate LLC, dba Coldwell Banker Commercial Affiliates.

Coldwell Banker Commercial
READ & CO., REALTORS
101 Annjo Court Forest, VA 24551
434-455-2285

