

BEAUMONT, CA 92223
NEQ OF BEAUMONT AVE & E 1ST ST

PROPERTY FEATURES

- Drive-thru opportunity
- 0.3 miles from Interstate 10
- Going-to-work side of the street
- Shared access with Arco AM/PM from Beaumont Ave

TRAFFIC COUNTS

- I-10 Freeway: 137,656 VPD
- Beaumont Ave & E 1st St: 28,026 VPD

DEMOGRAPHICS

	1 MILE	3 MILE	5 MILE
Population			
2017 Estimated	7,380	45,237	67,159
2022 Projected	7,894	48,550	71,927
Income			
2017 Median HHI	\$50,800	\$58,567	\$56,081
2017 Average HHI	\$70,185	\$77,894	\$76,793
2017 Average HHI	\$23,649	\$28,750	\$28,295

Information provided by ESRI Business Analyst

Steve Castellanos, VICE PRESIDENT
(O) 949.954.3705 | (M) 949.664.3477
stevec@cbcadvisors.com
Lic# 01922901

Brett Larson, VICE PRESIDENT
(O) 951.297.7430
brettl@cbcsocalgroup.com
Lic# 01947115

www.cbcadvisors.com

CBC ADVISORS
2600 MICHELSON DRIVE, SUITE 100
IRVINE, CALIFORNIA
(P) 949.954.3700



PROPOSED SITE PLAN

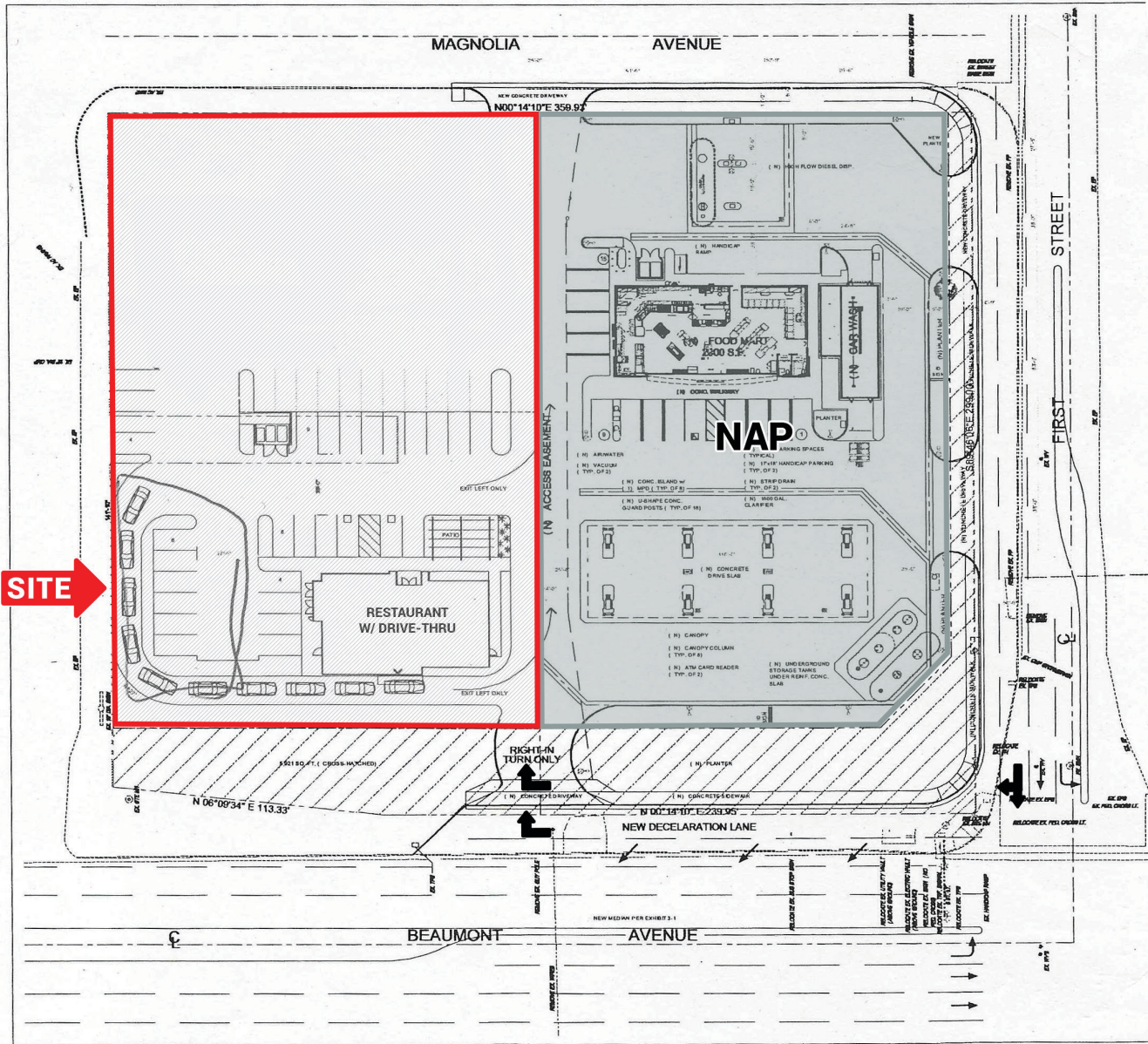

Steve Castellanos, VICE PRESIDENT
 (O) 949.954.3705 | (M) 949.664.3477
 stevec@cbcadvisors.com
 Lic# 01922901

Brett Larson, VICE PRESIDENT
 (O) 951.297.7430
 brettl@cbcsocalgroup.com
 Lic# 01947115

www.cbcadvisors.com



CBC ADVISORS
 2600 MICHELSON DRIVE, SUITE 100
 IRVINE, CALIFORNIA
 (P) 949.954.3700



AERIAL

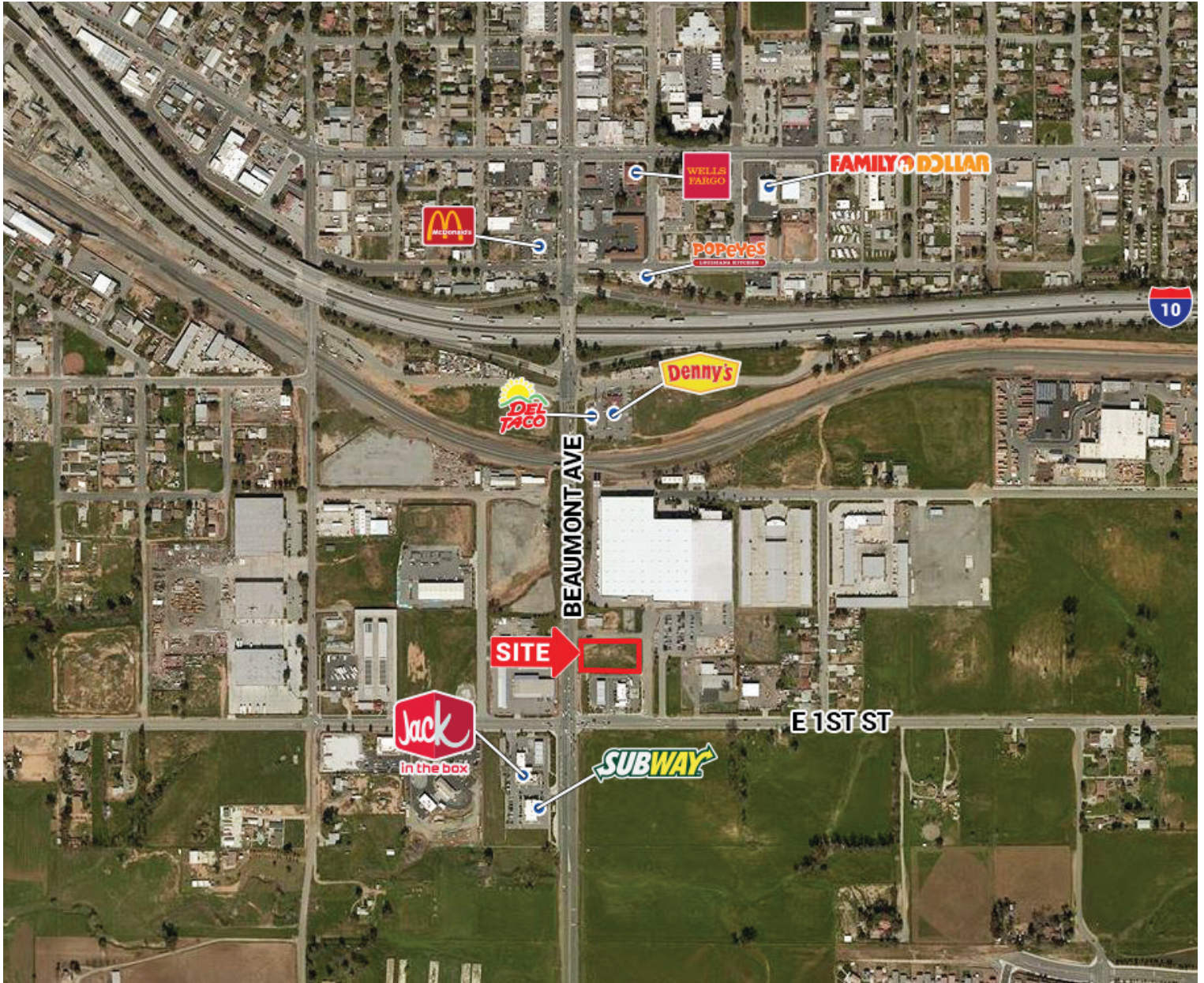

Steve Castellanos, VICE PRESIDENT
(O) 949.954.3705 | (M) 949.664.3477
stevec@cbcadvisors.com
Lic# 01922901

Brett Larson, VICE PRESIDENT
(O) 951.297.7430
brettl@cbcsocalgroup.com
Lic# 01947115

www.cbcadvisors.com



CBC ADVISORS
2600 MICHELSON DRIVE, SUITE 100
IRVINE, CALIFORNIA
(P) 949.954.3700