

PROMINENT JUNIOR ANCHOR SPACE

Hillcrest Park Shopping Center

SWC of Harbor Boulevard & Valley View Drive
1027 N. Harbor Boulevard | Fullerton, CA 92835



±16,305 SF Available (12/2018) ~ Please Do Not Disturb Existing Tenant



Property Owned and Managed By:



Property Highlights

- ±16,305 SF Junior Anchor Space Available (12/2018)
Please Do Not Disturb Existing Tenant
- High performing Ralphs tenant anchored shopping center
- Strong daytime population
- Main corridor through Fullerton
- Monument signage available
- Close proximity to St. Jude Medical Center, Fullerton College and The Orange County Superior Court

Come Join:



Contact

TERRISON QUINN

949.698.1107 | terrison.quinn@srsre.com
CA License No. 01789657

CASEY MAHONY

949.698.1108 | casey.mahony@srsre.com
CA License No. 01886184

TONY VUONA

949.270.8211 | tony.vuona@srsre.com
CA License No. 02046746

SRS REAL ESTATE PARTNERS

610 Newport Center Drive, Suite 1500, Newport Beach, CA 92660

This information contained herein was obtained from sources deemed to be reliable; however SRS Real Estate Partners makes no guarantees, warranties or representations as to the completeness or accuracy thereof.

±16,305 SF

Available (Please Do Not Disturb Existing Tenant)



Demographics

EST. 2017	1 MILE	3 MILE	5 MILE
Population	18,543	204,185	598,793
Average Household Income	\$111,672	\$92,825	\$90,179
Daytime Population	12,879	93,926	295,633

TRAFFIC COUNT

Harbor Boulevard	approx. 43,000 cars per day
Brea Boulevard	approx. 16,000 cars per day

Source: Esri 2017

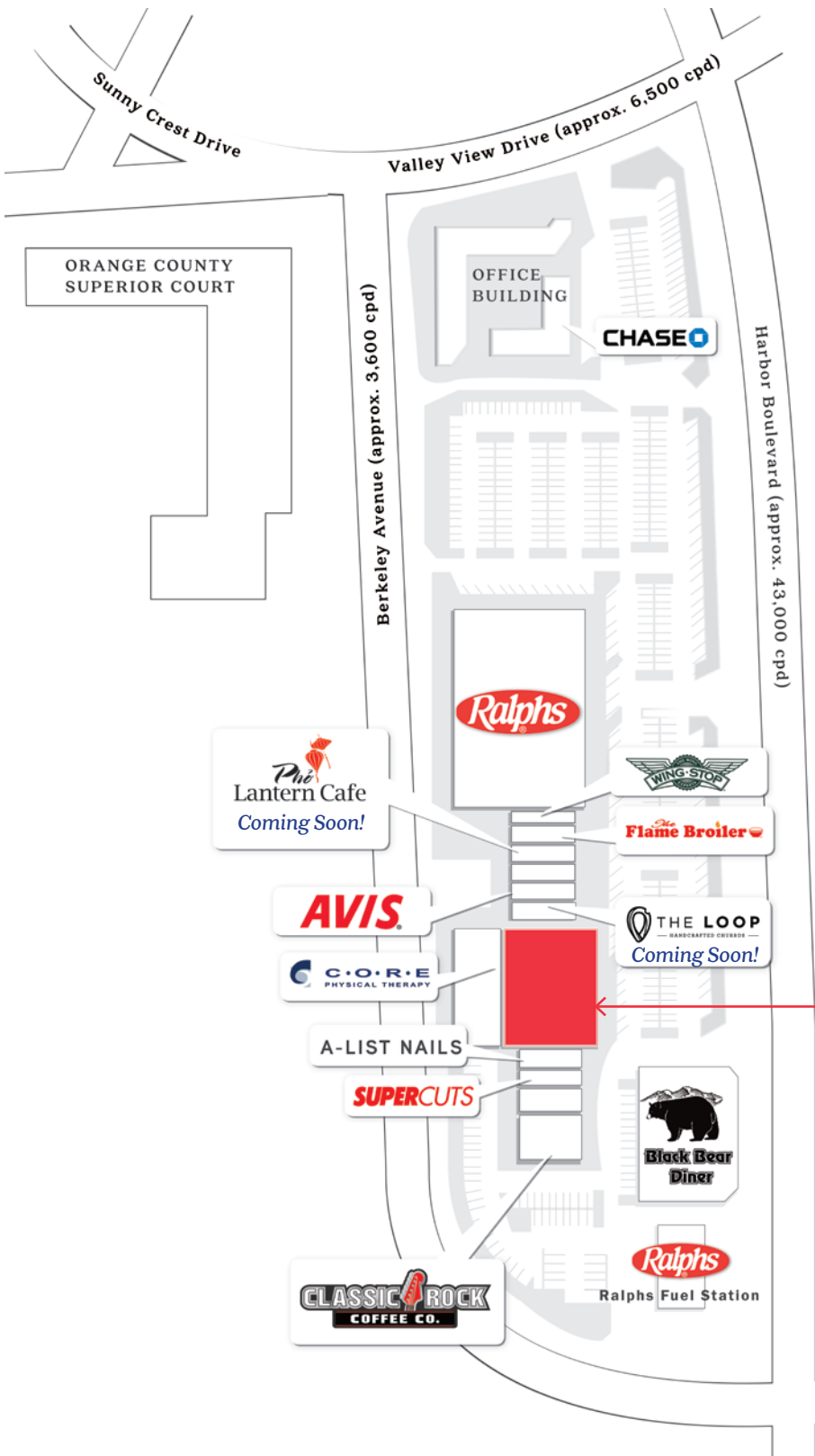

Property Owned
and Managed By:



What sets us apart:

- In House Management
- Long Term Ownership
- Financial Stability

How you benefit:

- Responsive Service
- Well Maintained Properties
- Lower NNNs

±16,305 SF
Available (12/2018)
Please Do Not Disturb
Existing Tenant

Contact

TERRISON QUINN
 949.698.1107 | terrison.quinn@srsre.com
 CA License No. 01789657

CASEY MAHONY
 949.698.1108 | casey.mahony@srsre.com
 CA License No. 01886184

TONY VUONA
 949.270.8211 | tony.vuona@srsre.com
 CA License No. 02046746

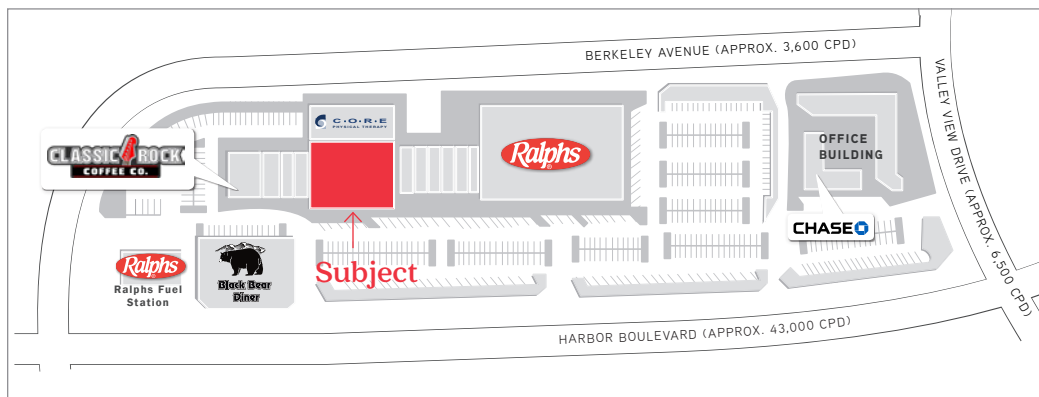

(Berkeley Avenue approx. 3,600 cars per day)

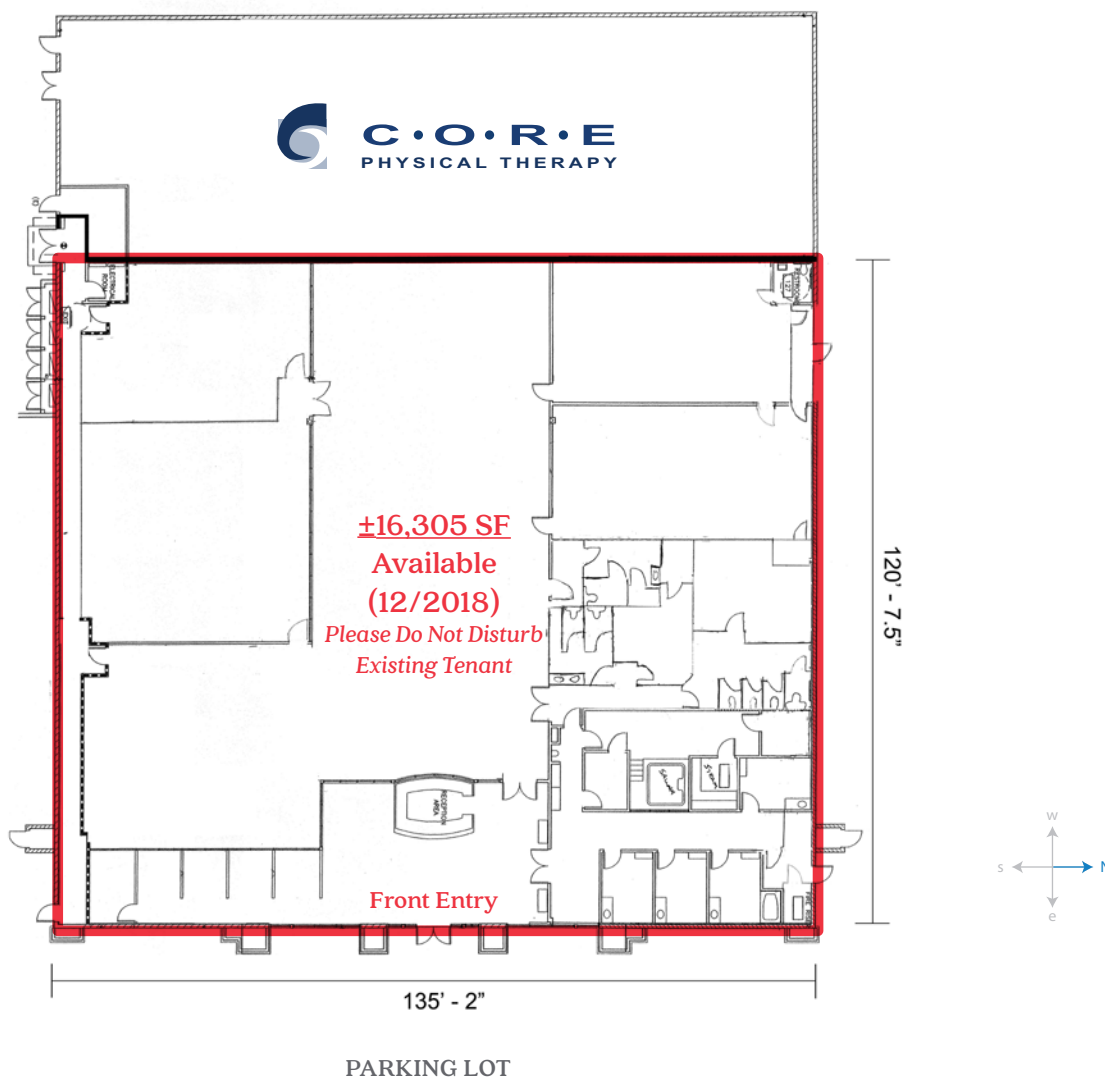

(Harbor Boulevard approx. 43,000 cars per day)

Contact

TERRISON QUINN
949.698.1107
terrison.quinn@srsre.com
CA License No. 01789657

CASEY MAHONY
949.698.1108
casey.mahony@srsre.com
CA License No. 01886184

TONY VUONA
949.270.8211
tony.vuona@srsre.com
CA License No. 02046746

