

226 W. St Charles Road

Lombard, IL | 60148

For Lease

Ground Lease Or Build To Suit



- ▶ Ground lease available for new construction strip center
- ▶ Option to build up to 9,150 SF building with parking
- ▶ Signalized corner location at St Charles & Elizabeth
- ▶ Less than 1/4 mile from the Lombard Metra Station
- ▶ Nearby retail includes Walgreens and Fifth Third Bank
- ▶ 14,400 VPD - St Charles Road
- ▶ 32,00 VPD - Elizabeth Road

DEMOGRAPHICS

	1 MILE	3 MILES	5 MILES
Estimated Population	12,881	110,592	294,396
Adj. Daytime Population	8,441	116,024	356,210
Estimated Households	5,067	40,524	107,714
Estimated Average Household Income	\$101,088	\$106,387	\$109,865

MARK FREDERICKS
312.275.3109
mark@baumrealty.com

DOUG RENNER
312.275.3137
doug.renner@baumrealty.com



© 2020 All information supplied is from sources deemed reliable and is furnished subject to errors, omissions, modifications, removal of the listing from sale or lease, and to any listing conditions, including the rates and manner of payment of commissions for particular offerings, the terms of which are available to principals or duly licensed brokers. Any square footage dimensions set forth are approximate.

226 W. St Charles Road

Lombard, IL | 60148

For Lease

Ground Lease Or Build To Suit

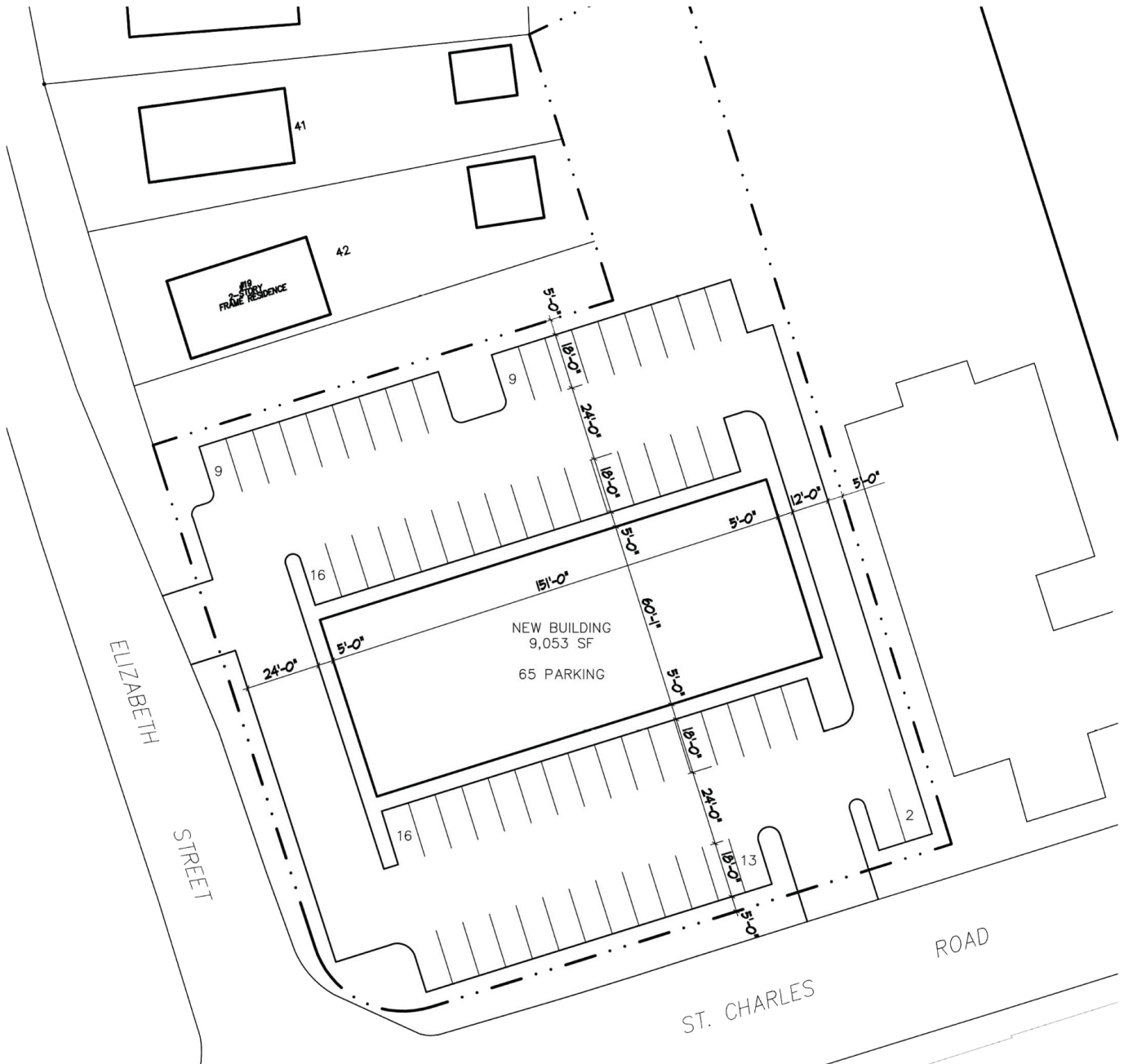

Option 1 - 9,053 SF building with 65 parking spaces

MARK FREDERICKS
312.275.3109
mark@baumrealty.com

DOUG RENNER
312.275.3137
doug.renner@baumrealty.com



© 2020 All information supplied is from sources deemed reliable and is furnished subject to errors, omissions, modifications, removal of the listing from sale or lease, and to any listing conditions, including the rates and manner of payment of commissions for particular offerings, the terms of which are available to principals or duly licensed brokers. Any square footage dimensions set forth are approximate.

226 W. St Charles Road

Lombard, IL | 60148

For Lease

Ground Lease Or Build To Suit

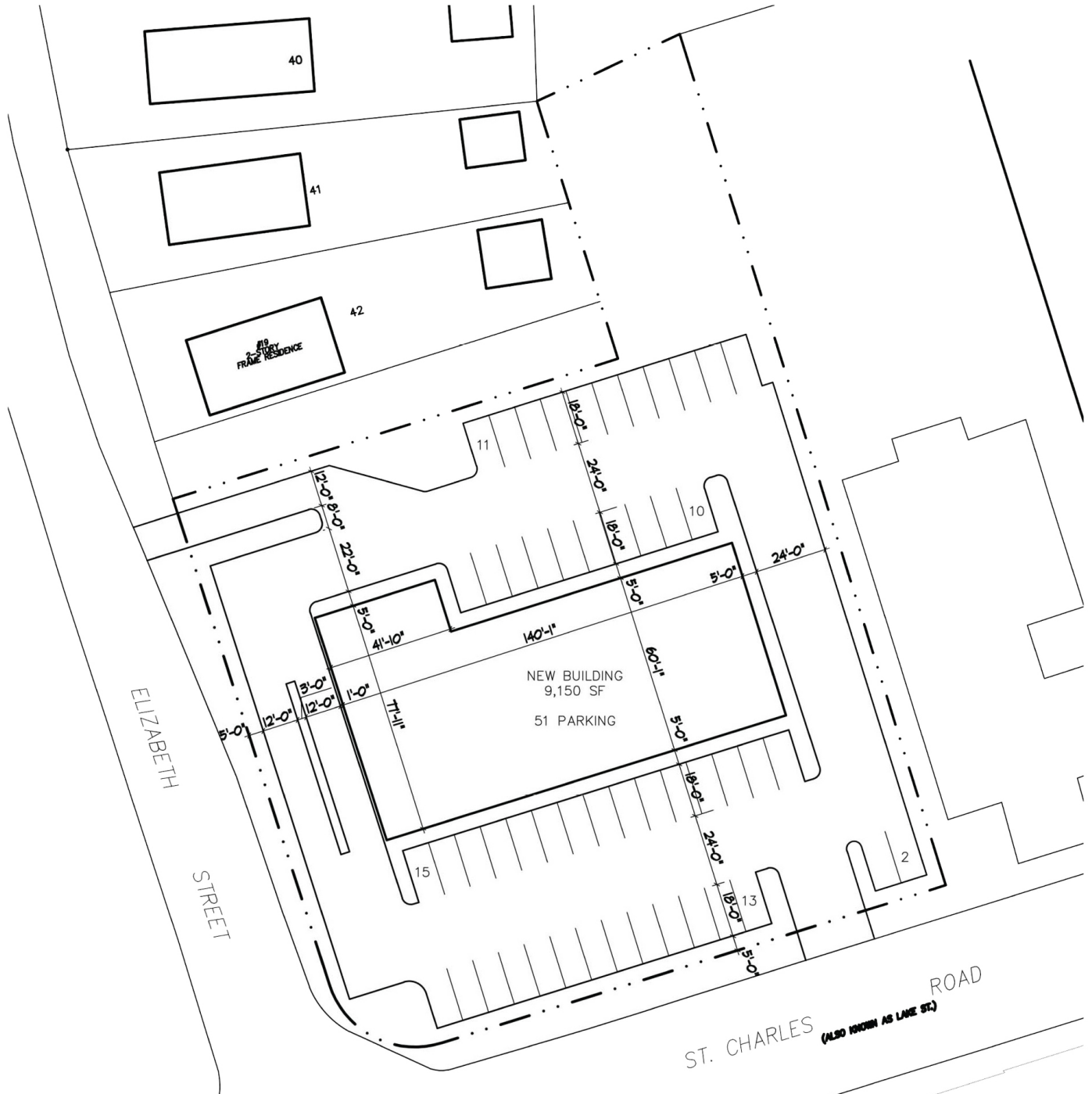

Option 2 - 9,153 SF building with 51 parking spaces

MARK FREDERICKS
312.275.3109
mark@baumrealty.com

DOUG RENNER
312.275.3137
doug.renner@baumrealty.com



© 2020 All information supplied is from sources deemed reliable and is furnished subject to errors, omissions, modifications, removal of the listing from sale or lease, and to any listing conditions, including the rates and manner of payment of commissions for particular offerings, the terms of which are available to principals or duly licensed brokers. Any square footage dimensions set forth are approximate.

226 W. St Charles Road
Lombard, IL 60148

226 W. St Charles Rd

Walgreens

BILLY BRICKS



MARQUETTE
Kitchen & Tap



DUNKIN'

LAUD & JAMES
ESTROGO

FIFTH THIRD BANK

PRAGA
Benton

WB WEST
SUBURBAN
BANK

Google

Map data ©2021 Imagery ©2021, Maxar Technologies, U.S. Geological Survey, USDA Farm Service Agency



© 2020 All information supplied is from sources deemed reliable and is furnished subject to errors, omissions, modifications, removal of the listing from sale or lease, and to any listing conditions, including the rates and manner of payment of commissions for particular offerings, the terms of which are available to principals or duly licensed brokers. Any square footage dimensions set forth are approximate.

