

FULL BUILDING OPPORTUNITY

1001 FRONT | 1010 BATTERY

74,874 RSF Total Available

53,782 RSF Office / 18,807 USF Storage Available 6/1/20

21,092 RSF Office Expansion Available 12/1/20



NORTH WATERFRONT
PORTFOLIO



Wes Powell
+1 415 395 4901
Wesley.powell@am.jll.com
License #: 1702003

Christopher Holland
+1 415 354 6917
christopher.holland@am.jll.com
License #: 1474598



Jones Lang LaSalle Brokerage, Inc. Real Estate License #: 01856260

NORTH WATERFRONT PORTFOLIO

The North Waterfront Portfolio's historic set of buildings—some even recognized by the National Historic Registry—have been artfully renovated to class A status and are conveniently located along the north waterfront in San Francisco. They blend historic charm with modern, creative interiors. Each of the buildings create a unique environment where your company can grow.

The “Barbary Coast”, the original coast line of San Francisco, is now full of modern amenities, including top restaurants, shopping, and parking. Seconds away from the financial district, tenants have easy access to San Francisco businesses without sacrificing their environment.



1001 Front

53,782 SF office / 18,807 SF storage

1st Floor - 26,782 RSF available 6/1/2020

2nd Floor - 15,864 RSF available 6/1/2020

3rd Floor - 10,453 RSF available 6/1/2020

Lower Level - 18,807 RSF available 6/1/2020

Combined with 1010 Battery
Totals to 74,874 SF

1050 Battery

31,195 SF

Suite 150 – 3,396 RSF available now



1010 Battery/50 Green

32,912 SF

21,092 RSF Available 12/1/20

Combined with 1001 Front
Totals to 74,874 RSF

One Lombard

130,244 SF

No space available



1001 FRONT STREET

SAN FRANCISCO | CA 94111

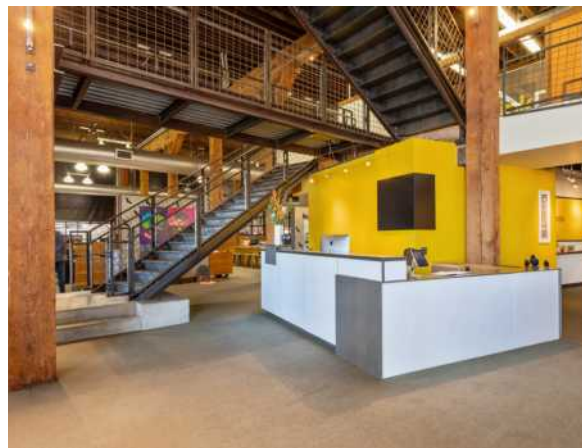
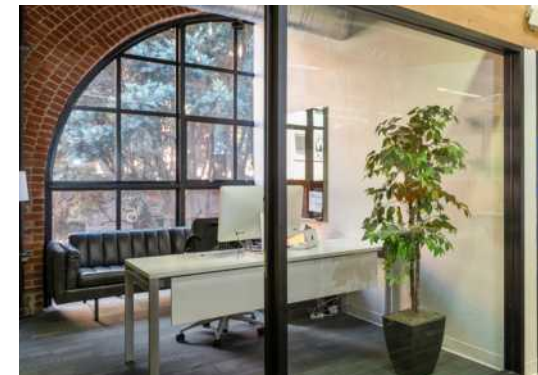

POTENTIAL BUILD OUT





FLOOR PLANS

1001 Front Street, 1st Floor

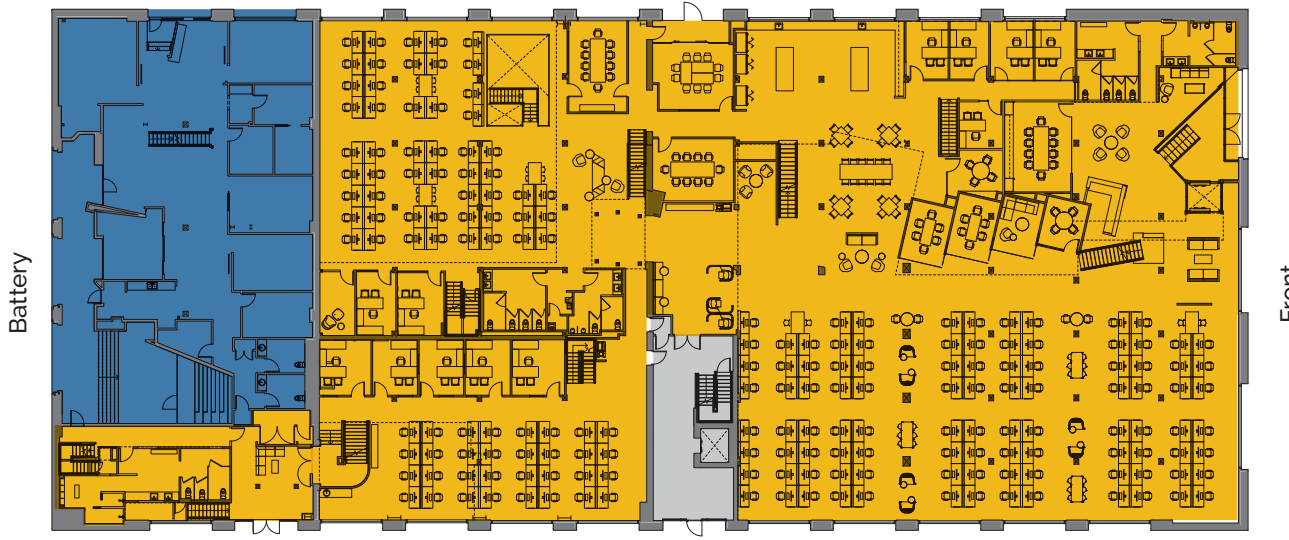
Hypothetical Space Plan



■ Available 6/1/20
■ Available 12/1/20

-  11 Private Offices
-  4 large, 3 medium, 2 small conference rooms
-  1 phone room
-  4 collaborative work areas
-  Large Kitchen/Break Area
-  2 coffee bars
-  1 Printer/Copy Areas
-  Women's showers/lockers
-  Room for 198 30" x 60" workstations



Wes Powell
 +1 415 395 4901
 Wesley.powell@am.jll.com
 License #: 1702003

Christopher Holland
 +1 415 354 6917
 christopher.holland@am.jll.com
 License #: 1474598



FLOOR PLANS

1001 Front Street, 2nd Floor

Hypothetical Space Plan

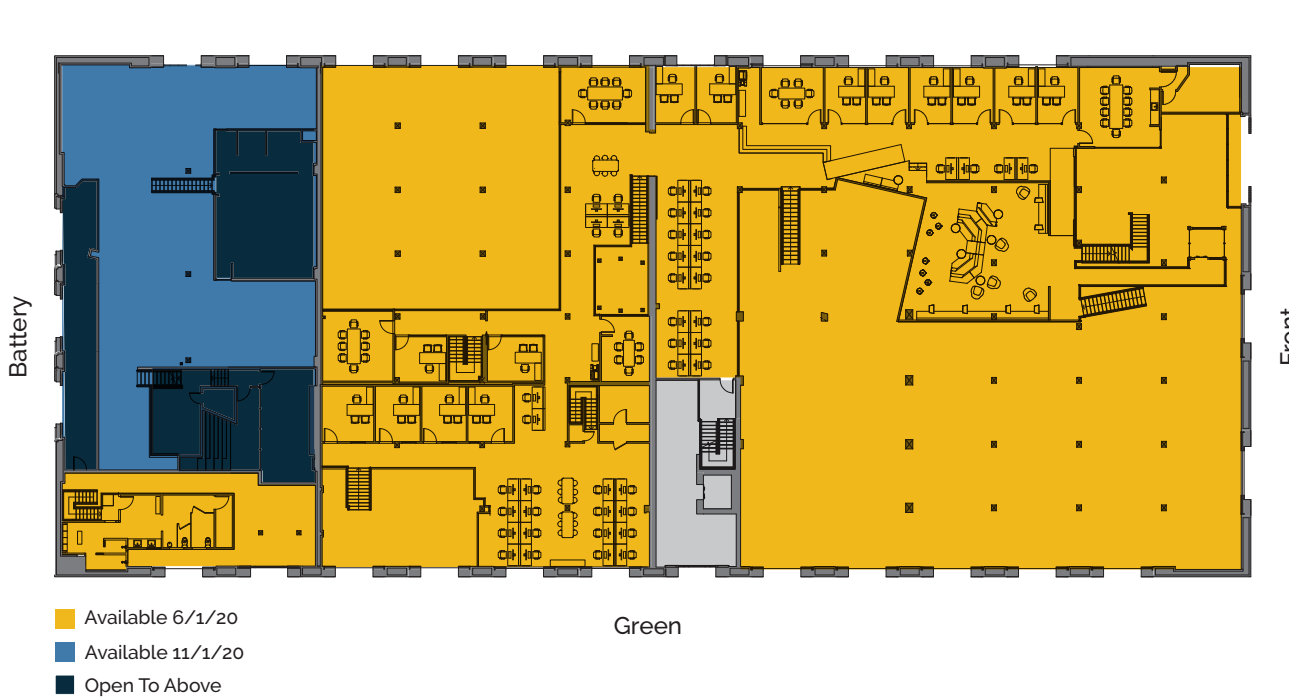

- 14 Private offices
- 1 large, 3 medium conference room
- 3 collaborative work areas
- 2 Printer/Copy areas
- Men's showers/lockers
- Room for 48 30" x 60" workstations



Wes Powell
+1 415 395 4901
Wesley.powell@am.jll.com
License #: 1702003

Christopher Holland
+1 415 354 6917
christopher.holland@am.jll.com
License #: 1474598







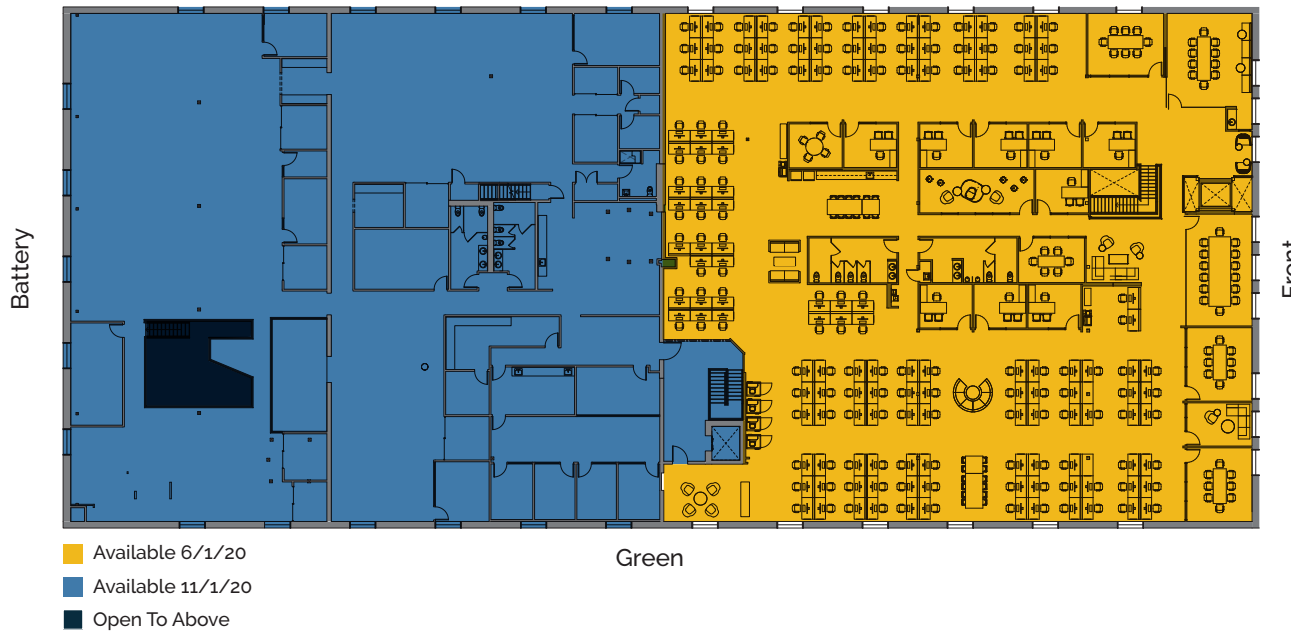

FLOOR PLANS

1001 Front Street, 3rd Floor

Hypothetical Space Plan



-  8 Private Offices
-  2 Large, 4 Medium, 2 Small Conference Rooms
-  Break Area
-  4 Phone Rooms
-  5 Collaborative Work Areas
-  2 Printer/Copy Areas
-  Room for 137 30" x 60" workstations



Wes Powell
 +1 415 395 4901
 Wesley.powell@am.jll.com
 License #: 1702003

Christopher Holland
 +1 415 354 6917
 christopher.holland@am.jll.com
 License #: 1474598



FLOOR PLANS

1001 Front Street, Lower Level

Hypothetical Space Plan



■ Available Storage



Bike Storage/Repair Room



1 Restroom/Shower



Wes Powell
+1 415 395 4901
Wesley.powell@am.jll.com
License #: 1702003

Christopher Holland
+1 415 354 6917
christopher.holland@am.jll.com
License #: 1474598





Wes Powell
+1 415 395 4901
Wesley.powell@amjll.com
License #: 1702003

Christopher Holland
+1 415 354 6917
christopher.holland@amjll.com
License #: 1474598



Jones Lang LaSalle Brokerage, Inc. Real Estate License #: 01856260