

# 31ST FLOOR CLASS A SUBLEASE!

ONE COMMERCE SQUARE 2005 MARKET STREET PHILADELPHIA, PA 19103

**1,021 SF | AVAILABLE NOW**

**\$32/SF FULL SERVICE**

One Commerce Square is located on Market Street in the Market West area of Center City and is surrounded by the cities best neighborhoods such as Rittenhouse Square and Logan Square/Art Museum District. The building is LEED Silver certified and is comprised of a full city block in the Central Business District.



**M.S. FOX REAL ESTATE GROUP**

**M.S FOX REAL ESTATE GROUP**

**215-568-8000**

**2 OFFICES | OPEN SPACE WITH 4 WORKSTATIONS**





cid:

FOR LEASE



### FEATURES

- Located in Brandywine Realty Trust Premier Office Complex Commerce Square
- Fully furnished
- Magnificent view on the 31st floor
- Expires September 2028
- Open space with 4 workstations, 2 offices with desks and table/TV
- On-site security
- Upgraded finishes throughout
- Access to building conference room and fitness center



FLOOR PLAN

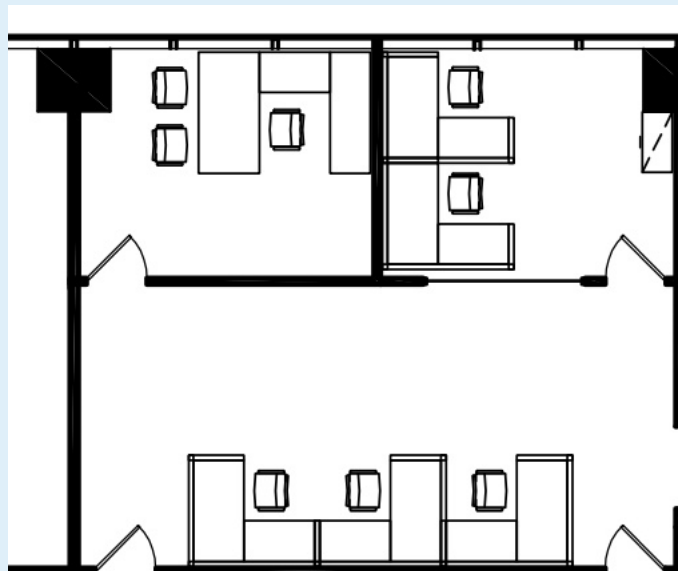

**215.568.8000**  
 Suite 1410, 1628 JFK Boulevard,  
 Philadelphia, PA 19103

**Mitch Fox** | 215.264.4751 | mitchfox@msfoxre.com

The information contained herein is from other sources believed to be reliable. No independent investigation of the property or the information contained herein has been made, and no representation is made as to the accuracy or completeness thereof. This information is subject to errors, omissions, prior sale or lease, or withdrawal without notice