



#3404 ~ Gilbert Street Office

**43 Gilbert Street North
Tinton Falls, NJ 07701**

Office

**Block: 18
Lot: 10**

**Land Size: 1.377 Acres
Building Size: 14,500 Sq. Ft.
Available Size: 4,465 Sq. Ft. (Divisible)**

Tax Information

**Land Assessment: \$ 577,800.
Improvement Assessment: \$ 1,078,600.
Total Assessment: \$ 1,656,400.**

**Taxes: \$ 33,128.
Tax Year: 2019
Tax Rate: 1.886/\$100
Equalization Ratio: 96.19%
Updated: 07/10/2020**

Zoning: HCC ~ Highway/Community Commercial

Remarks: 3,965 Sq. Ft. Second Floor Office and 500 Sq. Ft. First Floor Office Available in a 14,500 Sq. Ft. Two-Story Building with Elevator. Full Custom Build Out. Located One Block East of Shrewsbury Avenue. Easy Access to Highway 35 and the Garden State Parkway.

Price: \$ 22./Sq. Ft. Gross ~ Lease

Please call **Ray S. Smith/Broker** of **Stafford Smith Realty** at **(732) 747-1000** for further details.

630 Broad Street, Shrewsbury, New Jersey 07702-4118
4440 PGA Blvd., Ste. 600, Palm Beach Gardens, Florida 33410-6542
732-747-1000 • Ray@SSRealty.com • www.SSRealty.com



43 Gilbert Street N ~ Tinton Falls ~ Monmouth County ~ NJ



Copyright © and (P) 1988-2012 Microsoft Corporation and/or its suppliers. All rights reserved. <http://www.microsoft.com/mapoint/>
 Certain mapping and direction data © 2012 NAVTEQ. All rights reserved. The Data for areas of Canada includes information taken with permission from Canadian authorities, including: Her Majesty the Queen in Right of Canada. © Queen's Printer for Ontario. NAVTEQ and NAVTEQ ON BOARD are trademarks of NAVTEQ. © 2012 Tele Atlas North America, Inc. All rights reserved. Tele Atlas and Tele Atlas North America are trademarks of Tele Atlas. All rights reserved. Portions © Copyright 2012 by Woodball Publications Corp. All rights reserved.

43 Gilbert Street N ~ Tinton Falls ~ Monmouth County ~ NJ



Copyright © and (P) 1998-2012 Microsoft Corporation and/or its suppliers. All rights reserved. <http://www.microsoft.com/mappoint/>
Certain mapping and direction data © 2012 NAVTEQ. All rights reserved. The Data for areas of Canada includes information taken with permission from Canadian authorities, including: © Her Majesty the Queen in Right of Canada. NAVTEQ and NAVTEQ ON BOARD are trademarks of NAVTEQ. © 2012 Tele Atlas North America, Inc. All rights reserved. Tele Atlas and Tele Atlas North America are trademarks of Tele Atlas, Inc. © 2012 by Applied Geographic Solutions. All rights reserved. Portions © Copyright 2012 by Woodball Publications Corp. All rights reserved.

Tax Map Location

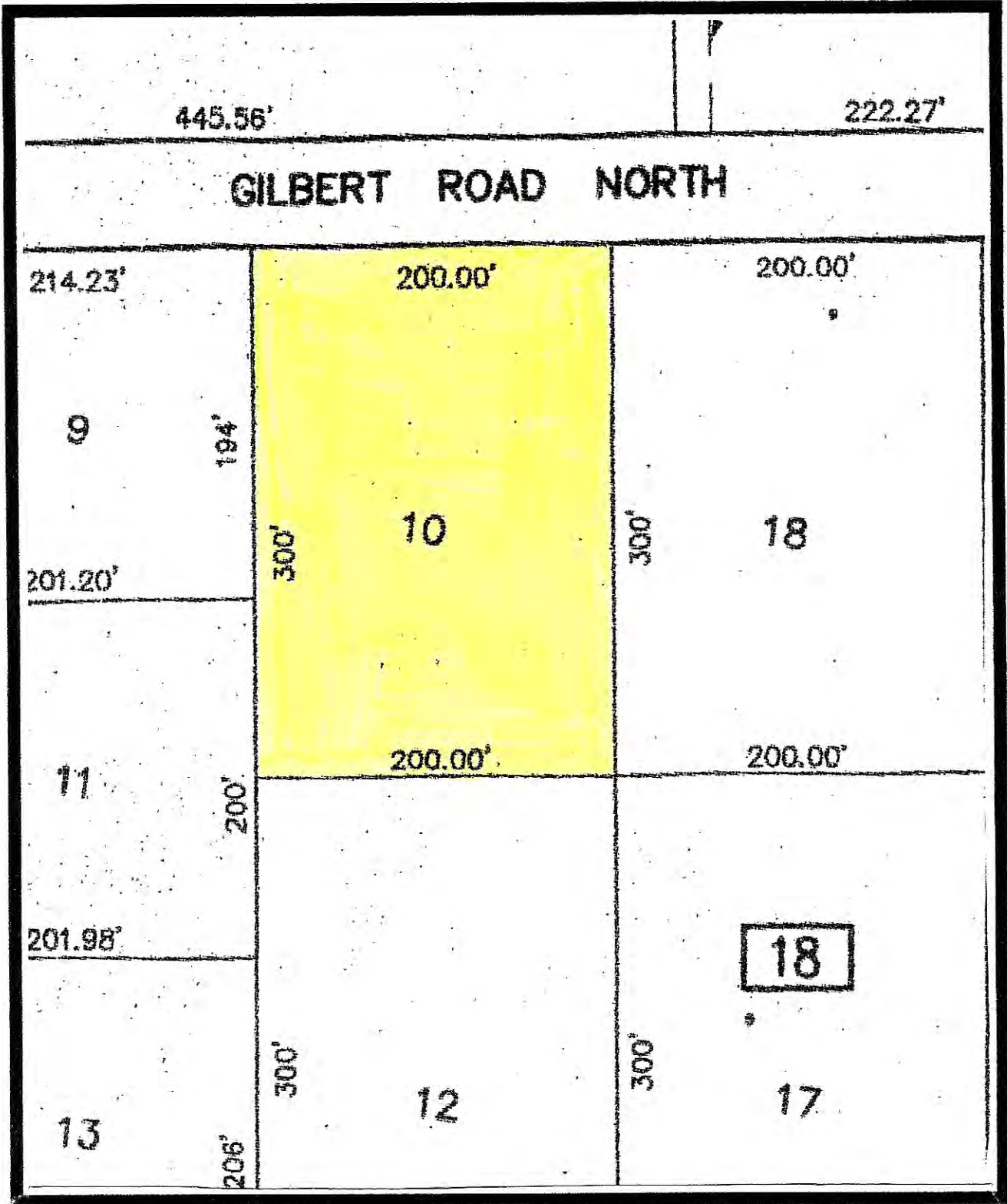

Zoning Map

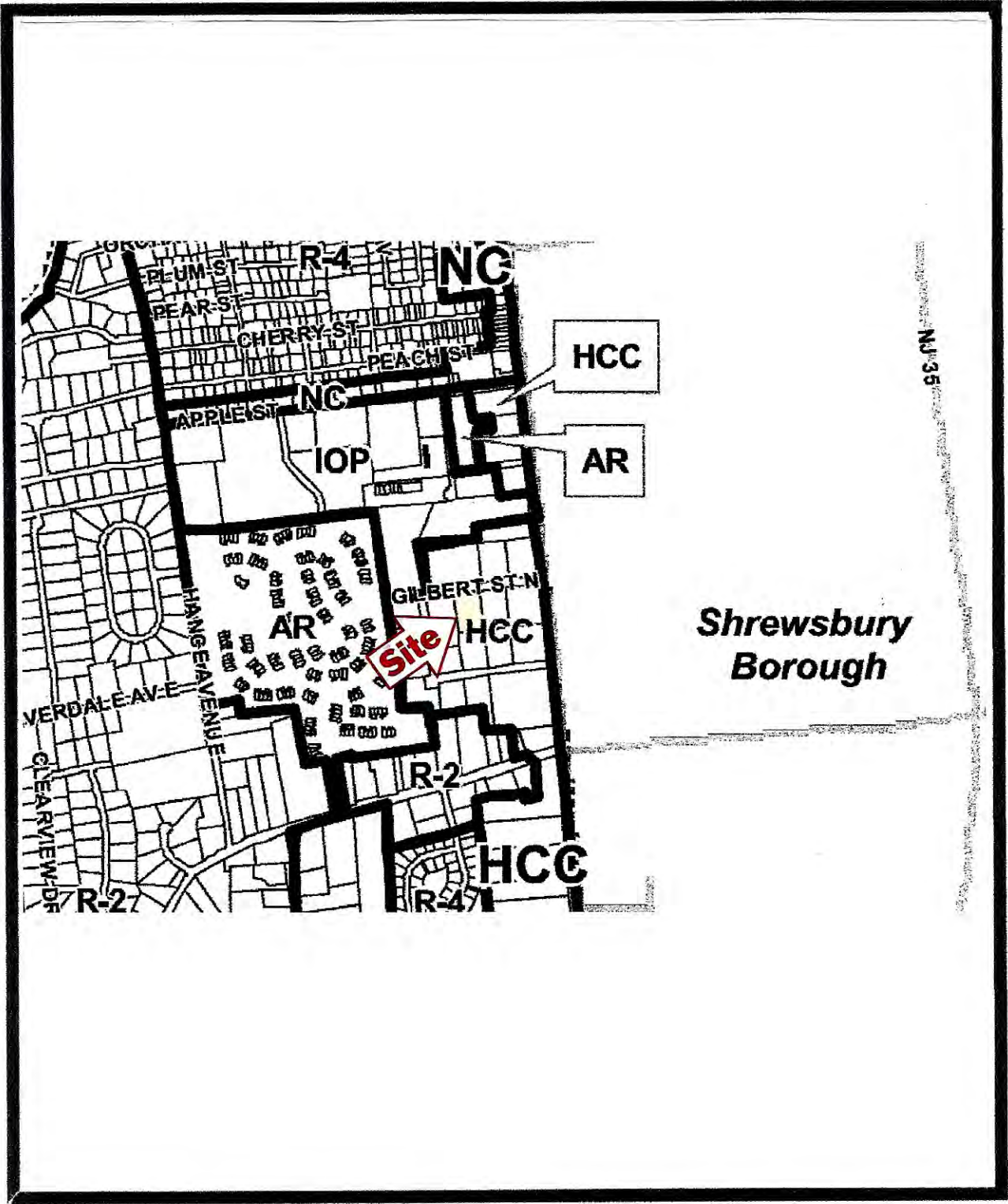

District	Permitted Principal Use	Permitted Accessory Uses	Permitted Conditional Uses
HCC Highway/ Community Commercial	<ol style="list-style-type: none"> 1. Retail sales such as, consumables, apparel, hardware, lawn & patio equipment, appliances, household goods, and confectians. 2. Retail services such as, repair of appliances and shoes, cleaners, tailors, barbershops, and beauty salons. 3. Delicatessens and speciality food/drink facilities such as, ice cream, bagels, bakery, pizza, ices, and sodas (including drive-thru service). 4. Shopping centers 5. Pharmacies (including drive-thru service) 6. Banks (including drive-thru service) 7. Offices such as professional, medical, veterinary and financial services. 8. Office Parks 9. Research facilities. 10. Hospitals. 11. Mortuary. 12. Theaters, bowling alleys, gymnasiums, weight rooms, fitness centers, training and instructional classes, and instructional centers such as dance and rehearsal studios. 13. Restaurants (including drive-thru service) and taverns. 14. Public Library, parks, and playgrounds. 15. Borough uses, firehouses, and first aid stations. 16. Utility services. 17. Child Care Centers 	<ol style="list-style-type: none"> 1. Off-street parking and loading areas. 2. Fences and walls. 3. Parking garages 	<ol style="list-style-type: none"> 1. Automobile Fueling stations. 2. Automobile Repair shops. 3. Automobile car wash. 8. Automobile oil change and lubrication shops. 4. Car and truck dealers. 5. Hotels 6. Swim clubs, tennis clubs 7. Golf driving range, miniature golf and par-3 golf course 8. Churches and places of religious worship. 9. Schools.

SCHEDULE B - District Bulk Regulations –Non-Residential Uses

District	Minimum Lot Requirements			Minimum Yard Requirements						Maximum Building Height		Maximum Floor Area Ratio (FAR)	Maximum Density – Dwelling Units Per Acre
	Lot Area (sq. ft.)	Width (ft.)	Depth (ft.)	Front (ft.)	Side		Rear (ft.)	Maximum Coverage (%)		Height in Stories	Height in Feet		
					Each (ft.)	Both (ft.)		Lot	Bldg.				
NC NEIGHBORHOOD COMMERCIAL													
All principal permitted uses	12,000	100	120	25	10	-	40	65	-	35	0.30	-	
HCC HIGHWAY COMMUNITY COMMERCIAL													
Retail Sales, Retail Services, Specialty Food, Offices	20,000	100	120	50	10	-	40	65	-	35	0.30	-	
Shopping Centers	5 acres (max. 15 acres)	300	300	80	80	-	80	65	-	35	0.20	-	
Pharmacies, Banks, Restaurants	1 acre	100	120	25	10	-	40	65	-	35	0.30	-	
Office Parks, Research Facilities	3 acres	200	300	80	50	-	60	60	-	70	0.33	-	
Hospitals, mortuary	4 acres	150	250	80	50	-	80	40	-	35	0.20	-	
Theaters, bowling alleys, gymnasiums, weight rooms, fitness centers, training and instructional uses	2 acres	200	200	80	60	-	60	60	-	35	0.20	-	
Public Uses, Borough uses, Utility	-	-	-	-	-	-	-	-	-	-	-	-	
Child Care Centers	12,000	100	120	25	10	-	40	65	-	35	0.30	-	
All Other Uses	20,000	100	120	50	10	-	40	65	-	35	0.30	-	

43 N Gilbert St, Tinton Falls, NJ 07701-4913, Monmouth County

POPULATION

SUMMARY

Estimated Population	23,631
Population Growth (since 2010)	-0.8%
Population Density (ppl / mile)	2,548
Median Age	42.12

HOUSEHOLD

Number of Households	9,544
Household Size (ppl)	2
Households w/ Children	2,496

AGE

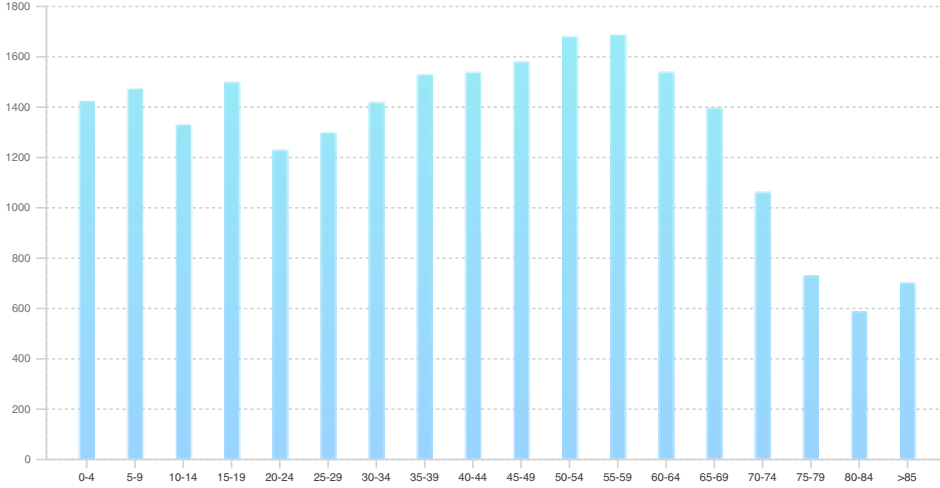

GENDER

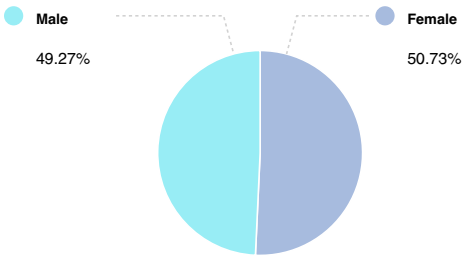

MARITAL STATUS

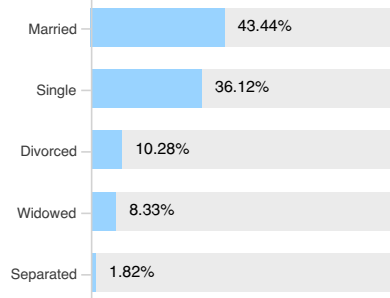

HOUSING

SUMMARY

Median Home Sale Price	\$325,000
Median Year Built	1959

STABILITY

Annual Residential Turnover	
-----------------------------	--

OCCUPANCY

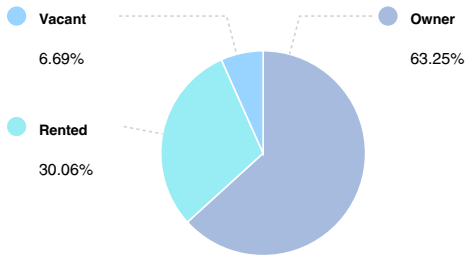

FAIR MARKET RENTS (COUNTY)

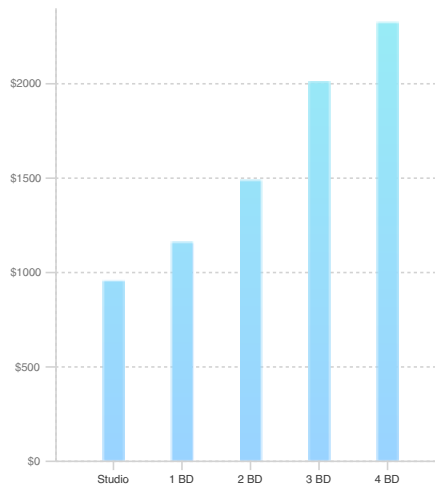

QUALITY OF LIFE

WORKERS BY INDUSTRY

Agricultural, Forestry, Fishing	19
Mining	15
Construction	502
Manufacturing	401
Transportation and Communications	98
Wholesale Trade	50
Retail Trade	1,721
Finance, Insurance and Real Estate	1,803
Services	1,216
Public Administration	1,164
Unclassified	95

WORKFORCE

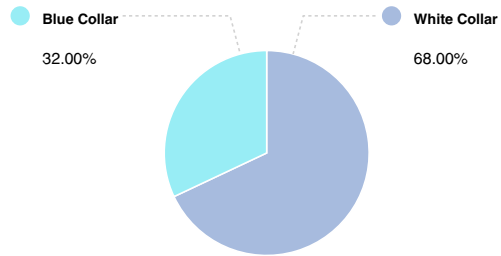

HOUSEHOLD INCOME

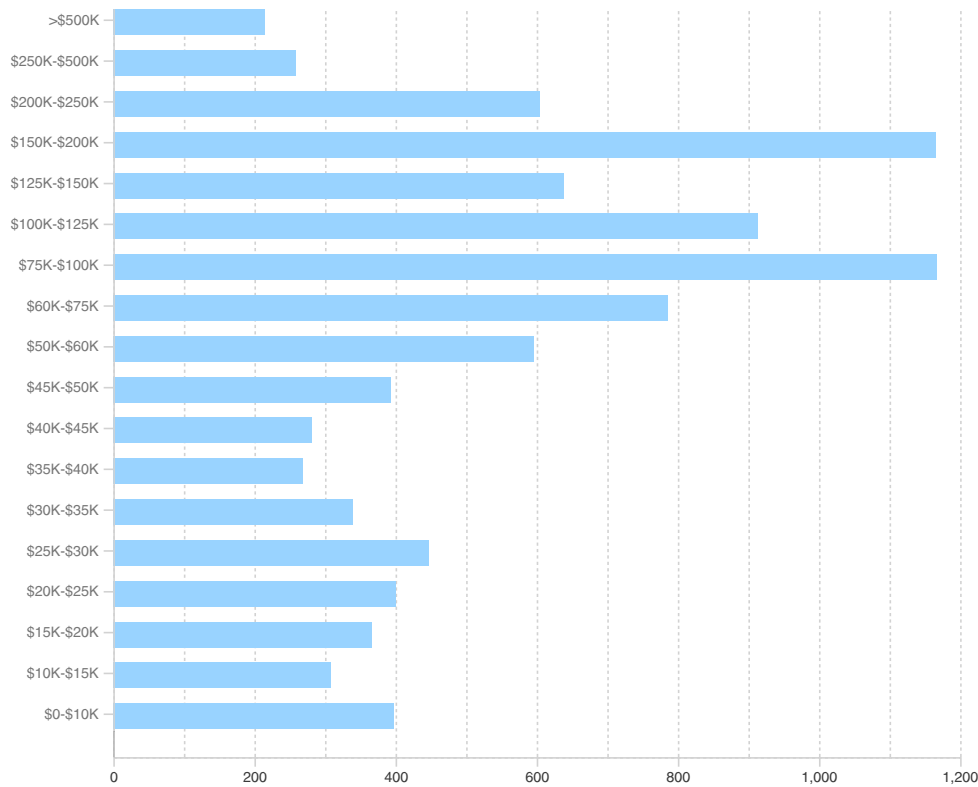

Average Household Income **\$110,963**

Average Per Capita Income **\$45,036**

COMMUTE METHOD

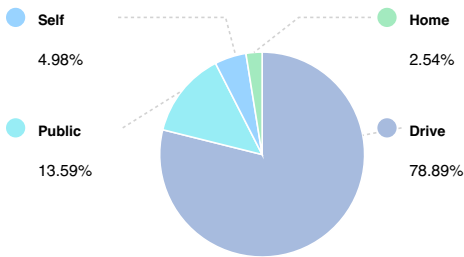

Median Travel Time

WEATHER

January High Temp (avg °F)	40.6
January Low Temp (avg °F)	22.8
July High Temp (avg °F)	82.6
July Low Temp (avg °F)	65.5
Annual Precipitation (inches)	48.63

EDUCATION

EDUCATIONAL CLIMATE INDEX (1)

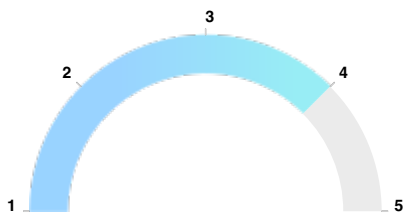

HIGHEST LEVEL ATTAINED

Less than 9th grade	1,032
Some High School	1,093
High School Graduate	3,544
Some College	2,453
Associate Degree	1,262
Bachelor's Degree	4,371
Graduate Degree	2,942

(1) This measure of socioeconomic status helps identify ZIP codes with the best conditions for quality schools. It is based on the U.S. Census Bureau's Socioeconomic Status (SES) measure with weights adjusted to more strongly reflect the educational aspect of social status (education 2:1 to income & occupation). Factors in this measure are income, educational achievement and occupation of persons within the ZIP code. Since this measure is based on the population of an entire ZIP code, it may not reflect the nature of an individual school.
 (2) Powered by Onboard Informatics. Information is deemed reliable but not guaranteed. Copyright © 2014 Onboard Informatics. All rights reserved.

SCHOOLS

RADIUS: 2.00 MILE(S)

PUBLIC - ELEMENTARY

Red Bank Charter School	Distance	Grades	Students	Students per Teacher	SchoolDigger.com Rating (1)
The Red Bank Charter School	1.53	Pre-K-8th	200	9	3

Red Bank Charter School
Community Rating (2)

The Red Bank Charter School

Red Bank School District	Distance	Grades	Students	Students per Teacher	SchoolDigger.com Rating (1)
Red Bank Primary School	1.19	Pre-K-3rd	600	16	1
Red Bank Middle School	1.67	4th-8th	614	12	2

Red Bank School District
Community Rating (2)

Red Bank Primary School

Red Bank Middle School

Shrewsbury Borough School District	Distance	Grades	Students	Students per Teacher	SchoolDigger.com Rating (1)
Shrewsbury Elementary School	0.67	Pre-K-8th	507	14	5

Shrewsbury Borough School District
Community Rating (2)

Shrewsbury Elementary School

Tinton Falls School District	Distance	Grades	Students	Students per Teacher	SchoolDigger.com Rating (1)
Swimming River Elementary School	0.42	3rd-5th	500	16	3
Mahala F. Atchinson Elementary School	1.13	Pre-K-2nd	535	15	3

Tinton Falls School District
Community Rating (2)

Swimming River Elementary School

Mahala F. Atchinson Elementary School

PUBLIC - MIDDLE/HIGH

Little Silver Borough School District	Distance	Grades	Students	Students per Teacher	SchoolDigger.com Rating (1)
Markham Place Elementary School	1.83	5th-8th	379	13	5

Little Silver Borough School District
Community Rating (2)

Markham Place Elementary School

Monmouth County Vocational School District	Distance	Grades	Students	Students per Teacher	SchoolDigger.com Rating (1)
Class Academy	1.93	10th-12th	61	9	

Monmouth County Vocational School District
Community Rating (2)

Class Academy

Monmouth Regional H.s. District	Distance	Grades	Students	Students per Teacher	SchoolDigger.com Rating (1)
Monmouth Reg High School	1.94	9th-12th	1,013	11	3

Monmouth Regional H.s. District	Community Rating (2)			
Monmouth Reg High School	4			

Red Bank Charter School	Distance	Grades	Students	Students per Teacher	SchoolDigger.com Rating (1)
The Red Bank Charter School	1.53	Pre-K-8th	200	9	3

Red Bank Charter School	Community Rating (2)			
The Red Bank Charter School				

Red Bank School District	Distance	Grades	Students	Students per Teacher	SchoolDigger.com Rating (1)
Red Bank Middle School	1.67	4th-8th	614	12	2

Red Bank School District	Community Rating (2)			
Red Bank Middle School				

Shrewsbury Borough School District	Distance	Grades	Students	Students per Teacher	SchoolDigger.com Rating (1)
Shrewsbury Elementary School	0.67	Pre-K-8th	507	14	5

Shrewsbury Borough School District	Community Rating (2)			
Shrewsbury Elementary School				

PRIVATE

	Distance	Grades	Students	Classrooms	Community Rating (2)
Goddard School - Tinton Falls	0.2	Pre-K-K	12		
Leapfrog Learning Center	0.56	Pre-K-K	100		
Oakwood School	0.8	6th-12th	40		
Vincent S Mastro Montessori Academy	1.01	Pre-K-6th	92		
Creative Learning Center	1.19	Pre-K-1st	70		
Ranney School	1.37	Pre-K-12th	650		5
Winding Brook School	1.43	Pre-K-Pre-K	100		
St James Elementary School	1.58	Pre-K-8th	335		
Red Bank Catholic High School	1.63	9th-12th	820		5
Tower Hill School	1.82	Pre-K-K	100		
Voyagers' Community School	1.86	Pre-K-12th	60		

(1) SchoolDigger Ratings provide an overview of a school's test performance. The ratings are based strictly on test score performance for that state's standardized tests. Based on a scale of 1-5. (© 2006-2016 SchoolDigger.com)

(2) The community rating is the overall rating that is submitted by either a Parent/Guardian, Teacher, Staff, Administrator, Student or Former Student. There will be only one rating per school. Based on a scale of 1-5.

(3) Powered by Onboard Informatics. Information is deemed reliable but not guaranteed. Copyright © 2014 Onboard Informatics. All rights reserved.

EATING - DRINKING

	Address	Phone #	Distance	Description
Pour House	640 Shrewsbury Ave	(732) 842-4337	0.14	Restaurants - Bistro
Wendy's	600 Shrewsbury Ave	(732) 747-8073	0.17	Restaurants - Burgers
Dunkin' Donuts	596 Shrewsbury Ave	(732) 219-1725	0.18	Doughnuts
Rite Aid	596 Shrewsbury Ave	(732) 741-7904	0.18	Health Food
Rite Aid Gnc Live Well Store	596 Shrewsbury Ave	(732) 741-7904	0.18	Vitamins
Lukoil	590 Shrewsbury Ave	(732) 758-9044	0.23	Convenience Stores
Mc Donald's	588 Shrewsbury Ave	(732) 530-0868	0.23	Restaurants - Burgers
Wall Street Access	766 Shrewsbury Ave	(732) 842-0896	0.27	Health And Diet Foods - Retail
Mumford's Culinary Ctr	33 Apple St	(732) 747-7646	0.33	Gourmet Shops
Coco Beans Play Cafe	70 Apple St	(732) 224-1100	0.35	Restaurants

SHOPPING

	Address	Phone #	Distance	Description
Speech Language Learning	55 N Gilbert St # 2202	(732) 450-1111	0.05	Hot Tubs And Spas
Clear Computing	55 N Gilbert St # 3103	(732) 747-0113	0.06	Computer Software
Monmouth Eye Care	21 N Gilbert St # 200	(732) 741-1902	0.07	Optical Goods - Retail
Purr'n Pooch Inc	86 W Gilbert St	(732) 842-4949	0.08	Pet Supplies And Foods - Retail
White Dove Cleaners Inc	45 S Gilbert St	(732) 530-0577	0.09	Gown Preservation Services
Keyport Liquor License LLC	688 Shrewsbury Ave	(732) 000-1111	0.11	Liquors - Retail
General Dynamics Info Tech	655 Shrewsbury Ave # 306	(732) 219-5000	0.13	Appliances And Electronics
Decker Wright Corp	628 Shrewsbury Ave # E	(732) 747-9373	0.15	Computer Services
Rite Aid	596 Shrewsbury Ave	(732) 741-7904	0.18	Pharmacies
Roberts Group LLC	621 Shrewsbury Ave # 218	(732) 747-6050	0.21	Cosmetics And Perfumes - Retail