

GROUND FLOOR RETAIL SPACE EAST VILLAGE

APPROXIMATELY 1,743 SF



1455

MARKET ST

SAN DIEGO

RI

# The Property

- The desired uses are office, coffee shop, or creative retail
- This space is part of a brand new youth hostel, Stay Class, expected to open early 2020
- The hostel includes 60 beds, in partitioned rooms, with upscale finishes
- A Korean street food restaurant and bar open to the public will occupy the ground floor and basement space
- The rooms do not have bunk beds but double mattresses and expect to draw individual travelers as well as corporate groups at prices that are more affordable than downtown hotels



# Site Plan

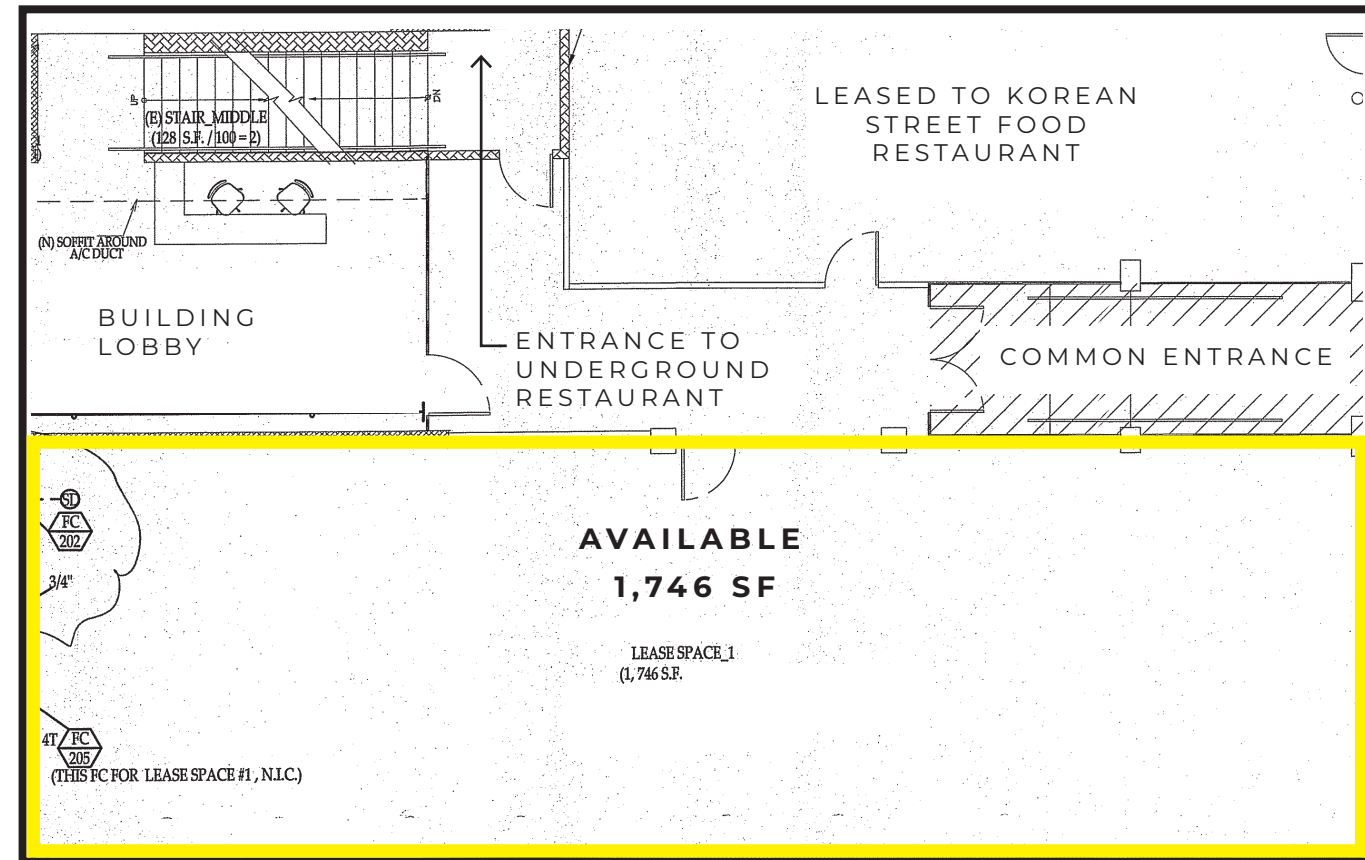

MARKET STREET





V I B R A N T

# EAST VILLAGE

---

This neighborhood of East Village in Downtown San Diego is known for booming residential, independent restaurants, youthful energy, and jobs in media, design, and the creative arts.

DOWNTOWN SAN DIEGO

# Demographics

Population	43,877
Daytime Population	88,610
Average Household Income	\$80,435
% of residents who rent their residence	18%
% of non-married residents	71%

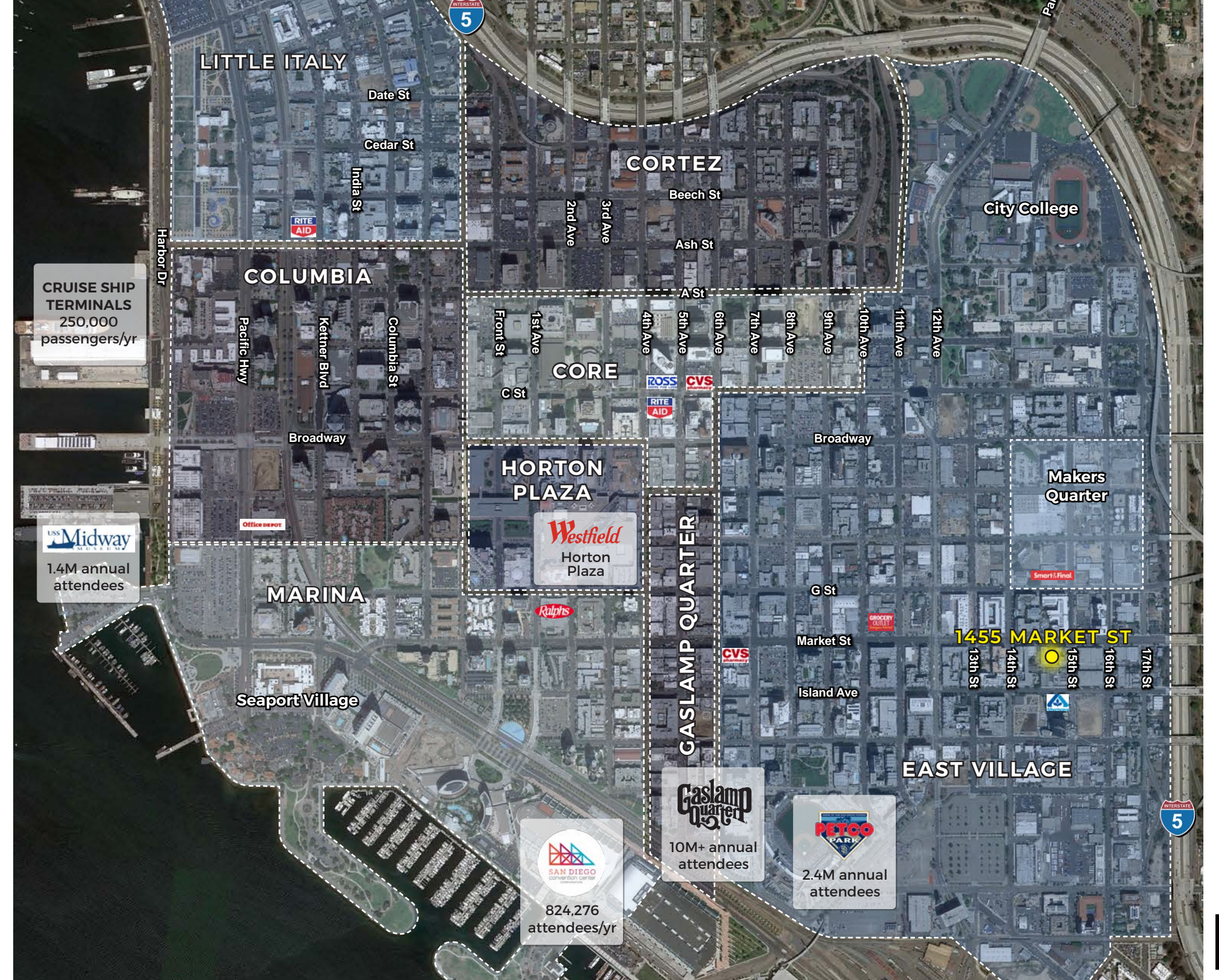

An aerial photograph of San Diego, California, showing the city skyline, harbor, and surrounding hills. The image is used as a background for a business card.

1455

MARKET ST

SAN DIEGO

**Jim Rinehart**

619.726.8557

[jrinehart@retailinsite.net](mailto:jrinehart@retailinsite.net)



**RETAIL INSITE**