

AVAILABLE FOR LEASE  
MEDICAL OFFICE SUITES



# Mountain View Medical Center

10555-10599 North Tatum Boulevard | Paradise Valley, AZ 85253

**Tom Weinhold**

Managing Director  
+1 602 224 4428  
tom.weinhold@cushwake.com

**Sheila Bale**

Managing Director  
+1 602 224 4454  
sheila.bale@cushwake.com





**Tom Weinhold**  
Managing Director  
+1 602 224 4428  
tom.weinhold@cushwake.com

**Sheila Bale**  
Managing Director  
+ 1 602 224 4454  
sheila.bale@cushwake.com



2555 E. Camelback Rd, Suite 400  
Phoenix, Arizona 8516  
ph: +1 602 954 9000  
fx: +1 602 253 0528

cushmanwakefield.com

# Mountain View Medical Center

10555-10599 North Tatum Boulevard | Paradise Valley, AZ 85253

©2022 Cushman & Wakefield. All rights reserved. The information contained in this communication is strictly confidential. This information has been obtained from sources believed to be reliable but has not been verified. No warranty or representation, express or implied, is made as to the condition of the property (or properties) referenced herein or as to the accuracy or completeness of the information contained herein, and same is submitted subject to errors, omissions, change of price, rental or other conditions, withdrawal without notice, and to any special listing conditions imposed by the property owner(s). Any projections, opinions or estimates are subject to uncertainty and do not signify current or future property performance.



# Mountain View Medical Center

10555-10599 North Tatum Boulevard | Paradise Valley, AZ 85253



## Building Features

- Lease Rate: \$28.50/SF MG (net of janitorial)
- Class A Medical Office Complex consisting of six (6) single-story buildings in prestigious Paradise Valley
- Abundant parking and lush surrounding landscaping
- High visibility location
- 5 miles from both HonorHealth Shea and Abrazo Scottsdale hospitals
- Tenants include Scottsdale Medical Imaging (SMIL) and Mountain View Pharmacy
- Extensive retail amenities nearby

## Availability

- Suite B118-119: ±2,013 RSF  
(Available now)
- Suite D135: ±1,116 RSF  
(Available April 2022)



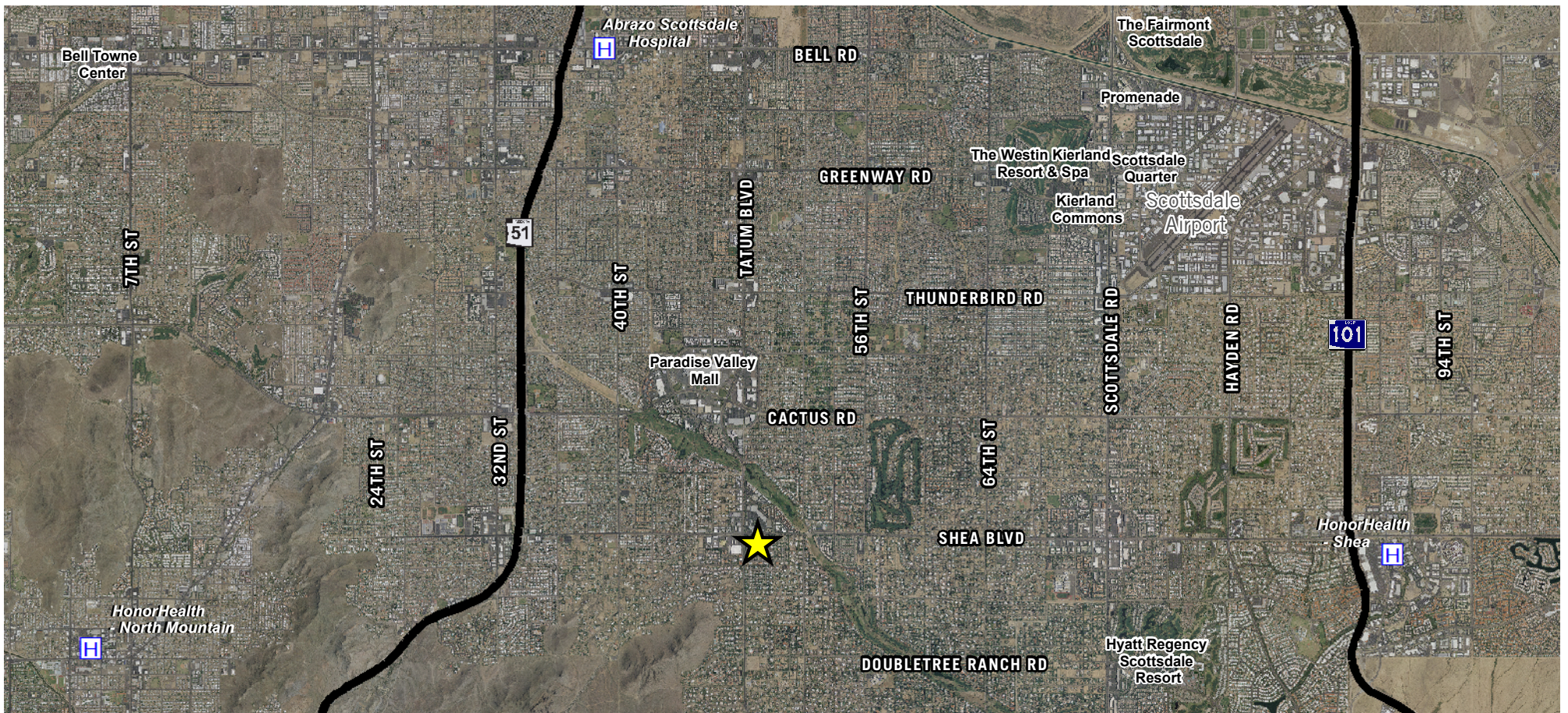

**Tom Weinhold**  
 Managing Director  
 +1 602 224 4428  
 tom.weinhold@cushwake.com

**Sheila Bale**  
 Managing Director  
 +1 602 224 4454  
 sheila.bale@cushwake.com

2555 E. Camelback Rd, Suite 400  
 Phoenix, Arizona 8516  
 ph: +1 602 954 9000  
 fx: +1 602 253 0528  
 cushmanwakefield.com