

FOR LEASE

17401 Tiller Court, Suites D & E

Westfield, IN 46074

±19,200 SF



PROPERTY HIGHLIGHTS

- ±1,680 SF office
- Two docks (9' x 10')
- Two drive-in doors (12' x 14')
- ±21' clear ceiling height
- Zoned E-I (Enclosed Industrial)
- Lease Rate: \$5.95/SF Gross

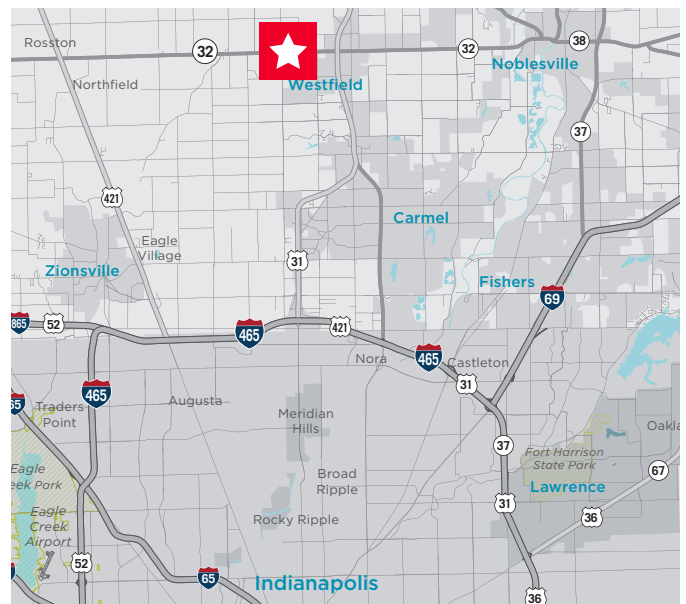

Ryan Baker, CCIM
Director
Certified Supply Chain Professional
+1 317 352 5428
ryan.baker@cushwake.com

One American Square, Suite 1800
Indianapolis, IN 46282
Main +1 317 634 6363
Fax +1 317 639 0504
cushmanwakefield.com



**CUSHMAN &
WAKEFIELD**

cushmanwakefield.com

17401 Tiller Court, Suites D & E

Westfield, IN 46074

±19,200 SF

FLOOR PLAN

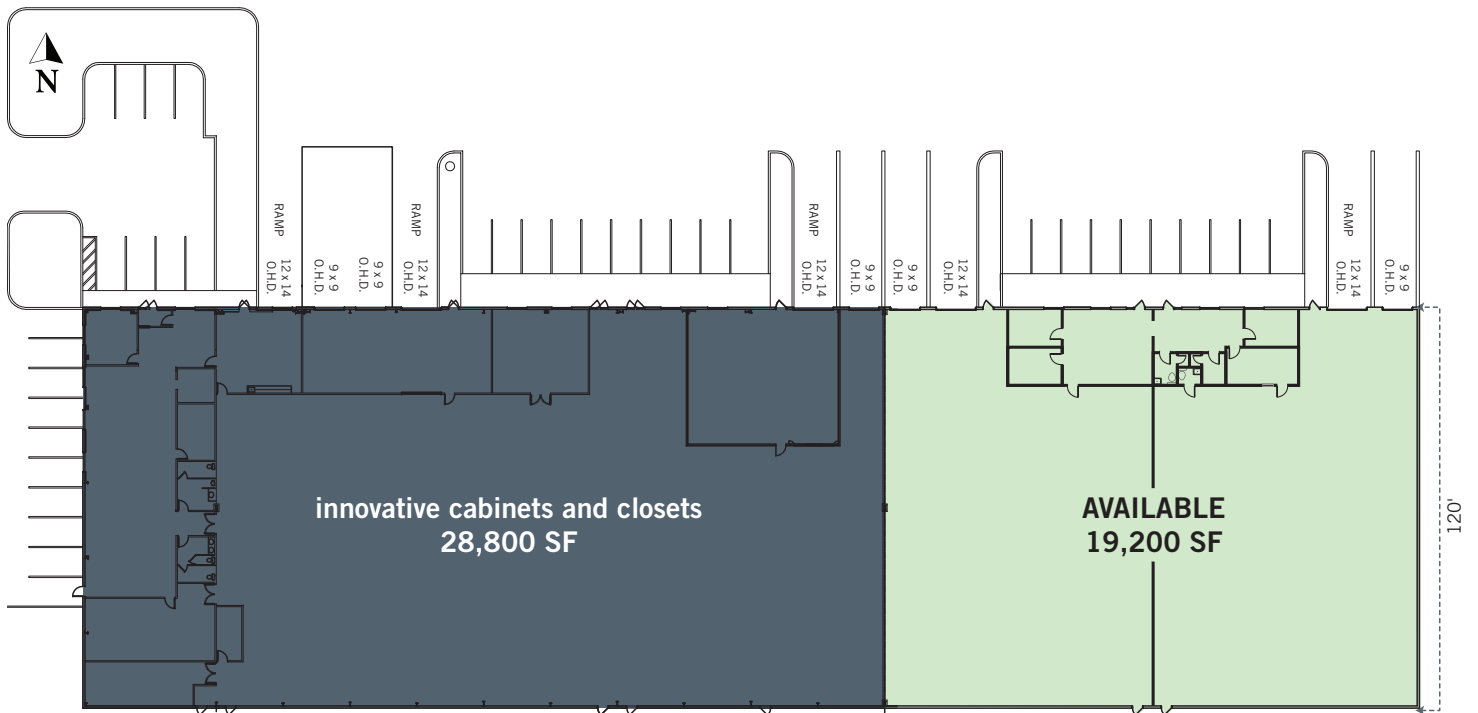

FOR LEASE



GENERAL BUILDING SPECIFICATIONS

Year Built	1999
Total Building SF	48,000
Exterior	Block and metal
Land Area	3.36 acres
Clear Height	21'
Dimensions	400' x 120'
Column Spacing	40' x 60'
Fire Protection	Wet
Electrical	400A, 208/120V, 3-phase (per electrical panel)
Dock doors	Five (9' x 10')
Drive-in doors	Four (12' x 14')
Parking	38 spaces
Truck Court	Shared court system
Zoning	E-I (Enclosed Industrial)
Lighting	Metal halide

AVAILABLE UNIT - SUITES D & E

Available SF	±19,200
Office SF	±1,680
Dock Doors	Two (9' x 10')
Drive-in Doors	Two (12' x 14')
Parking	10 spaces (expandable)

17401 Tiller Court, Suites D & E

Westfield, IN 46074

±19,200 SF

FOR LEASE

AERIAL



Ryan Baker, CCIM

Director

Certified Supply Chain Professional

+1 317 352 5428

ryan.baker@cushwake.com

One American Square, Suite 1800

Indianapolis, IN 46282

Main +1 317 634 6363

Fax +1 317 639 0504

cushmanwakefield.com



**CUSHMAN &
WAKEFIELD**

cushmanwakefield.com