

CENTRAL DUBLIN RETAIL! AMADOR CENTER FOR LEASE

AMADOR CENTER
6032 Dougherty Road, Dublin, CA

PROPERTY HIGHLIGHTS

- 1,760 - 6,412 SF retail space available now!
- 2,100 SF warehouse with double loading doors (can be converted to roll-up) and 20' clear height
- Monument signage opportunity at Dougherty & Sierra Lane!

LOCATION HIGHLIGHTS

- Excellent East Dublin location with high visibility
- High traffic corridor, in excess of 28,000 ADT on Dougherty Road
- Co-tenants include: Denica's Cafe, Subway, Certified Auto Service, Genius Kid Academy
- New exterior improvements! New parking lot and paint throughout the center

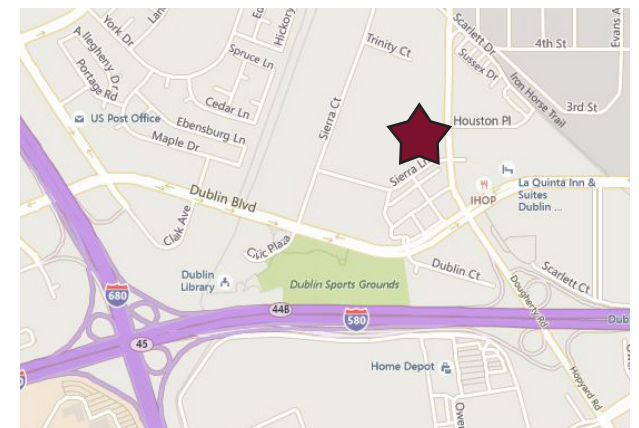

CONTACT INFO:

JESSICA MAUSER

Principal

925.737.4168

jmauser@lee-associates.com

LIC#: 01728720

All information furnished regarding property for sale, rental or financing is from sources deemed reliable, but no warranty or representation is made to the accuracy thereof and same is submitted to errors, omissions, change of price, rental or other conditions prior to sale, lease or financing or withdrawal without notice. No liability of any kind is to be imposed on the broker herein.

LEE
RETAIL
LEE & ASSOCIATES

5890 Stoneridge Drive
Suite 210
Pleasanton, CA 94588

CENTRAL DUBLIN RETAIL! AMADOR CENTER FOR LEASE

AMADOR CENTER
6032 Dougherty Road, Dublin, CA

	1 MILE	3 MILES	5 MILES
POPULATION	9,145	99,870	173,024
AVG. HH INCOME	\$116,548	\$153,811	\$165,559
EMPLOYEE POPULATION	9,894	46,720	74,828

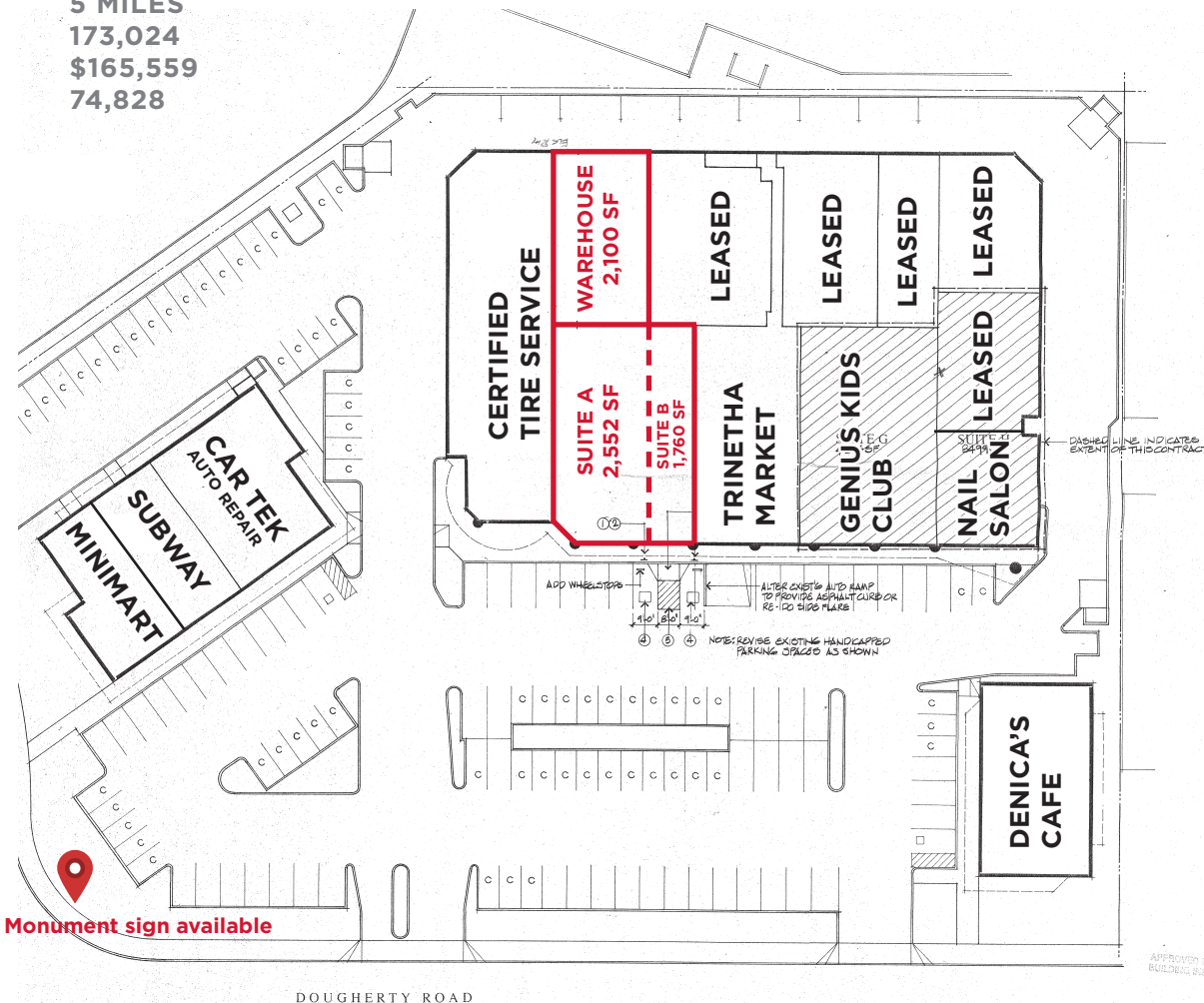

CONTACT INFO:

JESSICA MAUSER

Principal
925.737.4168
jmauser@lee-associates.com
LIC#: 01728720

LEE
RETAIL
LEE & ASSOCIATES

5890 Stoneridge Drive
Suite 210
Pleasanton, CA 94588

All information furnished regarding property for sale, rental or financing is from sources deemed reliable, but no warranty or representation is made to the accuracy thereof and same is submitted to errors, omissions, change of price, rental or other conditions prior to sale, lease or financing or withdrawal without notice. No liability of any kind is to be imposed on the broker herein.